

ELECTRO-MECHANICAL ROTATIONAL MOUNTING KIT

NOW AVAILABLE

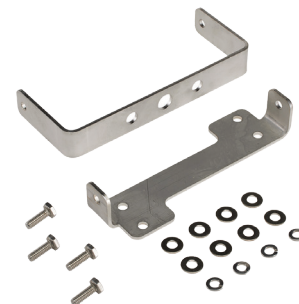

The EM-KIT-RS Rotational Mounting Kit is now available to enhance the flexibility of Federal Signal electro-mechanical series horns and bells. This mounting solution allows the device to be angled horizontally or vertically off the mounting surface, improving coverage by directing sound toward critical areas. Built for dependable, long-term performance in a wide range of environments, the EM-KIT-RS installs quickly with basic tools and straightforward mounting steps.

EM-KIT-RS is compatible with the following product lines:

- 350WB Vibratone® Horn
- 350WBX Vibratone Hazardous Location Horn
- 450WBX Vibratone Hazardous Location Electronic Horn
- 504WB Vibratone Bell Assemblies
- 506WB-120 (This model has rotational limits)
- TELC Telcom® Telephone Extension Horn and Strobe Ringer Device

Other compatible product lines, if used with a WB-Gray, WB- Black, or WB-NM-Gray Boxes:

- 350 Vibratone Horn
- 450E Vibratone Electronic Horn
- AM50 AudioMaster® Public Address 2-Watt Re-Entrant Speaker
- 50GC SelecTone Amplified Speaker
- 500 and 600 Vibratone Bells

This kit is designed to provide dependable, long-term performance in virtually any environment. Installation is straightforward and requires basic tools.

HOW TO ORDER

MODEL	DESCRIPTION	UPC CODE
EM-KIT-RS	Electro-Mechanical Rotational Mounting Kit, 350, 450, AM50, 50GC, 500 and 600	78297910552

TIMING

Orders for the EM-KIT-RS can be accepted and processed today.