

**Subject:**

Service bulletin regarding the use of Arjent S2 and Arjent SL lightbars on Model Years 2011-2012 or newer Dodge Charger PPV vehicles.

**Issue:**

Due to a change in the roof design of the Dodge Charger PPV and as a result of aerodynamic loading at high speeds, the gutters (i.e. door jam) on the 2011-2012 or newer Dodge Charger PPV are subject to deformation when used with an Arjent S2 or Arjent SL lightbar. As a result, there is potential for vehicle damage.

**Warning:**

**DO NOT UTILIZE THE HKB-CHGR11 MOUNTING KIT ON MODEL YEARS 2011-2012 OR NEWER DODGE CHARGER PPV VEHICLES.**

- Instead of HKB-CHGR11, utilize Z858300045A Load Distribution Kit.
- Only use Series D mounting feet, either XAHK-SD or XHK-SD with the Z858300045A Load Distribution Kit.

**Recommendations:*****2011-2012 or newer Dodge Charger PPV***

- **Installation of NEW Arjent S2 or Arjent SL lightbars**

New Arjent S2 or Arjent SL lightbars that are being installed on 2011-2012 or newer Dodge Charger PPV must be installed using the new Z858300045A Load Distribution mounting kit, instead of the HKB-CHGR11. The HKB-CHGR11 is not suitable for use when installing Arjent S2 or Arjent SL lightbars in this application. The HKB-CHGR11 is suitable for use with other Federal Signal lightbars such as the Valor, Legend, and LPX Series. Instructions for proper installation of the Z858300045A Load Distribution mounting kit can be found in the "Support" section of our website (<http://www.fedsig.com/support/manuals>). The document number for these instructions is 25500003.

- **Installation of PREVIOUSLY-USED Arjent S2 or Arjent SL lightbars**

If a previously-used Arjent S2 or Arjent SL lightbar is being transferred from a different vehicle to a 2011-2012 or newer Dodge Charger PPV, then the installer must utilize the Z858300045A Load Distribution mounting kit instead of the HKB-CHGR11.

The installer must also determine if the previously-used lightbar includes the most up-to-date (Series D) mounting feet which are either part number XAHK-SD (factory-installed) or XHK-SD (service item). If the previously-used lightbar utilizes earlier mounting feet, then the mounting feet must also be upgraded to the series D version. Instructions on how to identify the different mounting feet can be found in the installation instructions for the Z858300045A Load Distribution mounting kit (document number 25500003). Lightbars built prior to January 1, 2010 are likely to be equipped with older mounting feet and will need to be upgraded to series D prior to installation.

If you have questions about this service bulletin or need additional assistance, please contact our Technical Support department at 800-433-9132.



## Safety Message to Installers of Warning Light Equipment

### **⚠ WARNING**

People's lives depend on your proper installation and servicing of Federal Signal products. It is important to read and follow all instructions shipped with this product and the original product. In addition, listed below are some other important safety instructions and precautions you should follow:

- To properly install a light assembly, you must have a good understanding of automotive electrical procedures and systems, along with proficiency in the installation and use of safety warning equipment.
- When drilling into a vehicle structure, be sure that both sides of the surface are clear of anything that could be damaged.
- You should frequently inspect the light system to ensure that it is operating properly and that it is securely attached to the vehicle.
- Refer to the instruction sheets packed with related products for additional precautions and information.
- File these instructions in a safe place and refer to them when maintaining and/or reinstalling the product.

Failure to follow all safety precautions and instructions may result in property damage, serious injury, or death.

## Product Overview

This publication provides supplemental directions for installing the Federal Signal Arjent® Series lightbar with the Load Distribution Kit on a 2011 or newer Dodge Charger. The Load Distribution Kit is designed to prevent vehicle damage due to aerodynamic loading when travelling at speeds in excess of 120 MPH. This kit is designed to work in conjunction with the XAHK-SD (installed at the factory) and XHK-SD (service kit) Arjent Hook-Mounting Bracket Kits (in production from November 2009). –SC and earlier mounts must be upgraded. This kit includes special wide gutter hooks.

## Unpacking the Kit

After unpacking the kit, inspect it for damage that may have occurred in transit. If it has been damaged, do not attempt to install or operate it. File a claim immediately with the carrier, stating the extent of damage. Carefully check all envelopes, shipping labels, and tags before removing or destroying them. Ensure that the parts in the Table 1 are included in the package. If you are missing any parts, contact Customer Support at 1-800-264-3578, 7 a.m. to 5 p.m., Monday through Friday (CT).

**Table 1** Kit contents (continued on next page)

Qty.	Description	Part Number
5	Pad, Mounting, Rubber	8572029
10	Screw, #10, Type B Pan Torx, Black, SS	7011246-08
8	Screw, 5/16"-18 x 7/8 Pan Torx, Black SS	7000434-14
8	Washer, 5/16" Flat, Black SS	7072234
8	Lockwasher, 5/16" Flat. Black SS	7074A020-01

**Table 1** Kit contents (continued from previous page)

Qty.	Description	Part Number
2	Pad, Hook Bumper	8552492
2	Hook, Special Gutter, 2011 Charger	855200044
1	Foot Assy., Adjuster, Wide, Rear Pass. Side	858300041
1	Foot Assy., Adjuster, Wide, Rear Driver. Side	858300042
2	Strap, Limit	858300043

## Installing the Wide Foot Assembly Adjuster

To install the wide adjuster:

1. See Figure 1. Before proceeding, note the difference between the -SD Mounting Bracket Assembly and the -SC and earlier mounting.

**Figure 1** -SD Mounting bracket identification

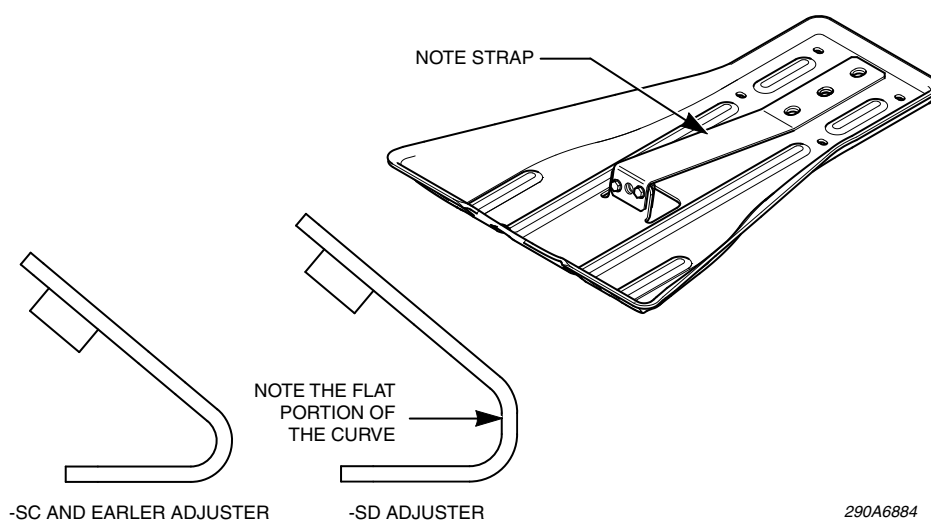

2. Cut one rubber hook-bumper pad in half as shown in Figure 2.

**Figure 2** Rubber pad cut in half

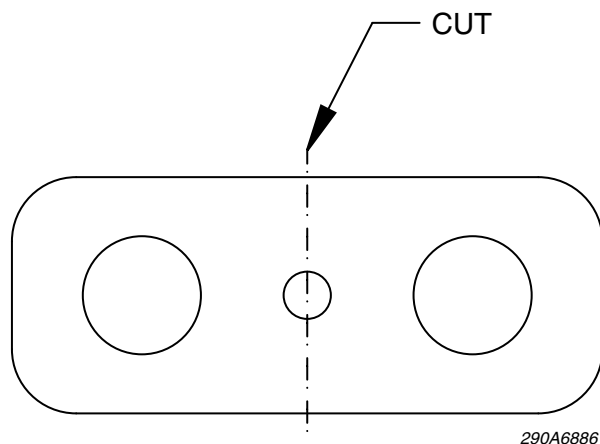

3. See Figure 2 on page 2. Install one full pad and one half pad onto each wide adjuster foot assembly.
4. Use the 5/16"-18 x 7/8" Torx head screws, 5/16" flat washers, and 5/16" lockwashers to loosely attach a wide adjuster foot assembly on the rear of the mounting bracket

**Figure 3** Pads installed on -SD wide adjuster

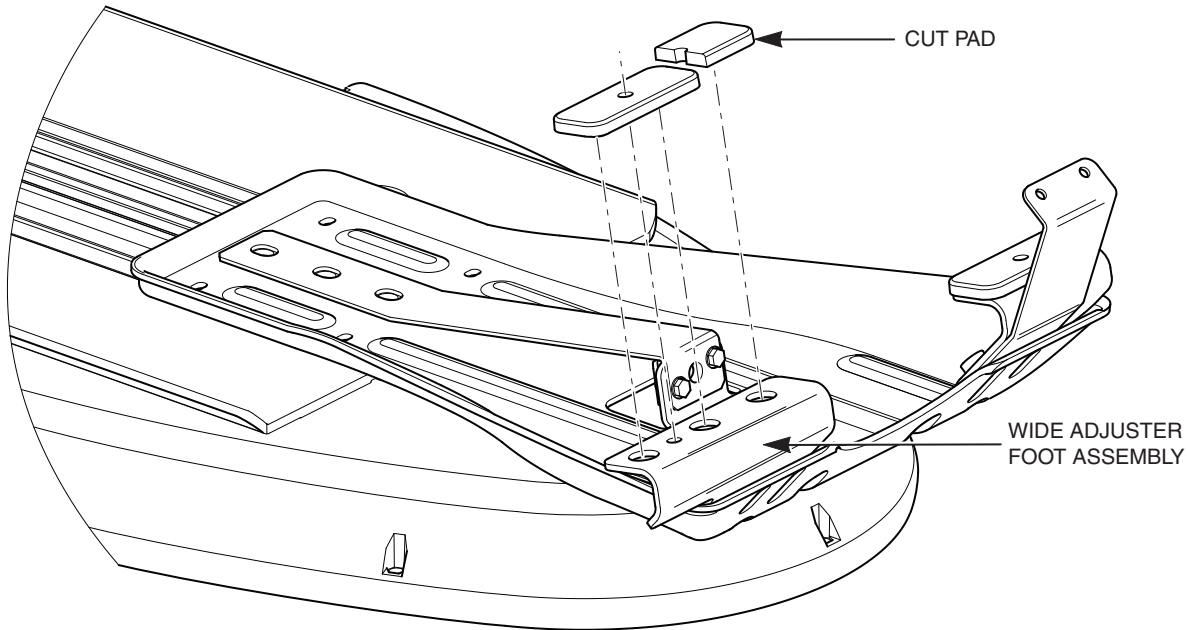

290A6887

5. See Figure 3 above and Figure 1 on page 2. Sandwich the limit strap between the -SD adjuster and front of the mounting bracket, loosely attached with the 5/16"-18 x 7/8" Torx head screws, 5/16" flat washers, and 5/16" lockwashers.
6. Repeat steps 1 through 5 for other side of the lightbar.
7. See Figure 4 on page 4. Position the lightbar and the special wide gutter hook on the roof as shown. Mark, then drill, five 0.136" (#29) holes on each side for the gutter hook and limit strap.
8. Complete the installation with the hardware and instructions supplied in this kit and with the XAHK-SD or XHK-SD mounting bracket kit.

**Figure 4** Lightbar secured to vehicle



## **Getting Technical Support and Service**

For technical support and service, please contact:

Federal Signal Corporation

Service Department

Phone: 1-800-433-9132

Fax: 1-800-343-9706

Email: [empserviceinfo@fedsig.com](mailto:empserviceinfo@fedsig.com)