

**INSTALLATION INSTRUCTIONS FOR
TS100 COMPACT SPEAKER MOUNTING KIT
BEHIND GRILLE MOUNTING SYSTEM
(1998 FORD CROWN VICTORIA)**

SAFETY MESSAGE TO INSTALLERS

Peoples lives depend on your safe installation of our products. It is important to read, understand and follow all instructions shipped with the products. In addition, listed below are some other important safety instructions and precautions you should follow:

- To properly install mounting kit: you must have a good understanding of automotive electrical procedures and systems, along with proficiency in the installation and use of safety warning equipment.
- Mounting the speaker(s) behind the grille will slightly reduce the sound intended to warn others.
- Sound propagation and warning effectiveness will be severely reduced if the speaker projector is not facing forward. Carefully follow the installation instructions and always install the speaker with the projector facing forward.
- Sound propagation will be severely reduced if any objects are in front of the speaker. You should ensure that front of speaker is clear of any obstructions.
- When drilling into a vehicle structure, be sure that both sides of the surface are clear of anything that could be damaged.
- Installation of two speakers requires wiring speakers in-phase.
- All effective sirens produce loud sounds which may cause, in certain situations, permanent hearing loss. You should take appropriate precautions such as wearing hearing protection.
- Inspect the mounting system periodically to ensure it is in good condition.
- After installation and testing are complete, provide a copy of this instruction sheet to all operating personnel.
- File these instructions in a safe place and refer to them when maintaining and/or reinstalling the product.

Failure to follow all safety precautions and instructions may result in property damage, serious injury, or death to you or others.

A. UNPACKING.

After unpacking the kit, carefully check all envelopes, shipping labels, and tags before removing or destroying them. Ensure that the parts listed in the KIT CONTENTS LIST are contained in the packing carton.

B. KIT CONTENTS LIST.

Qty.	Description	Part Number
1	Bracket, Speaker, Mounting	8470414
4	Screw, Mach. Hex HD., S.S., 1/4-20 x 1/2"	7000A311-08
4	Lockwasher, Ext. Tth., 1/4	7075A007
5	Screw, 1/4" x 5/8", Type B	7011165-10
5	Lockwasher, Split, 1/4"	7074A015
2	Vellutex Washer	8283A451

C. INSTALLATION.

1. Raise the vehicle hood. See figure 1. Locate the plastic panel between the radiator crossbar and the grille fascia.
2. Remove and retain the three plastic twist fasteners. Remove the plastic panel.
3. Remove and retain the six 11mm nuts that secure the top of the vehicle grill. Remove the grill.
4. See figure 2. Assemble the bracket to the speaker driver using the 1/4-20 x 1/2" bolts and 1/4" lockwasher and tighten the bolts securely.
5. See figure 3. Remove and retain the screw on the left side of the hood latch mechanism. Locate the top of the radiator crossbar, to the left (passenger's side) of the hood latch. Position the speaker driver/bracket assembly on the radiator crossbar and align the mounting ear hole with the previously removed screw's hole. Install the previously removed screw and tighten securely.

CAUTION

Before drilling holes in ANY part of a vehicle, be sure that both sides of the mounting surface are clear of parts that could be damaged; such as brake lines, fuel lines, electrical wiring or other vital parts. Note that the vehicle's air conditioning condenser, located directly below the two rear bracket hole locations, MUST be protected during the drilling operation.

6. Using the bracket as a template, center punch five drill position marks on the radiator crossbar.
7. Drill five 3/16" holes in the radiator crossbar at the drill position marks.
8. To complete the mounting of speaker bracket, secure the speaker driver/bracket assembly in position using the 1/4" x 5/8" thread-forming screws and split lockwashers. See figure 3.

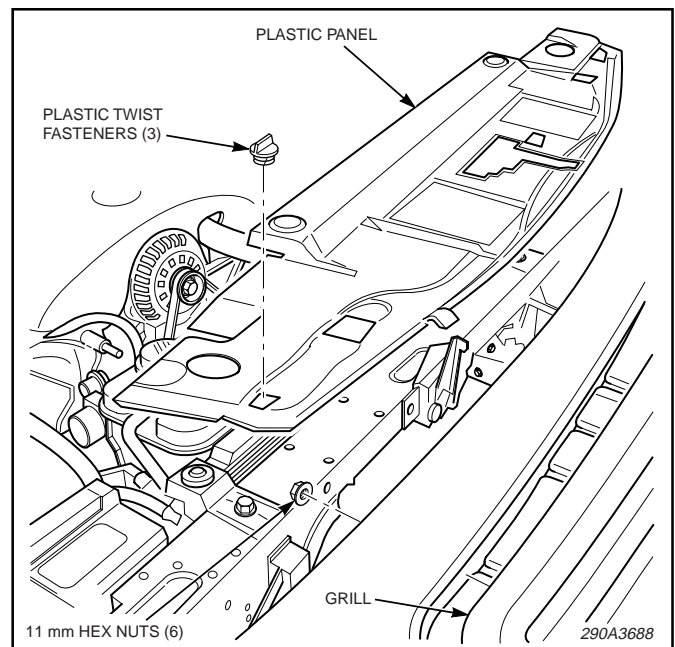

Figure 1.

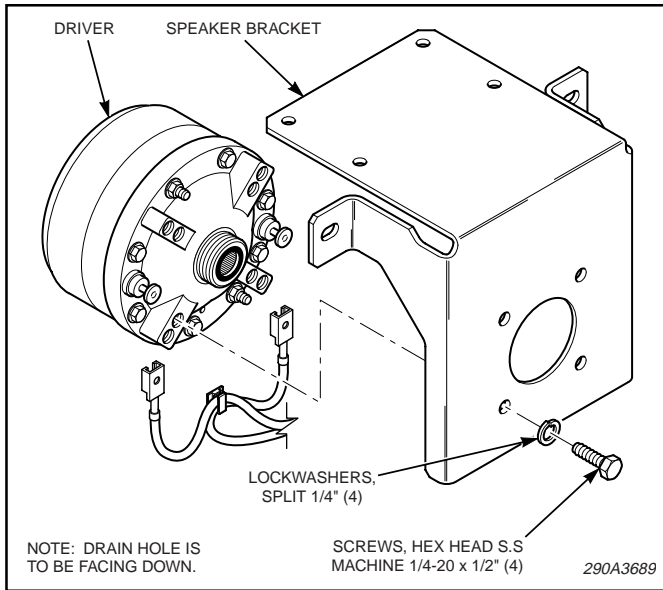

Figure 2.

9. See figure 4. Install two steel washers and one vellutex washer on the speaker driver. Insert the TS100 projector through the grill opening and position it on the speaker driver/bracket. Install the vellutex and rubber washers on the driver/projector as shown in figure 4. Insert the cone through the grill opening and install the cone by turning it clockwise until snug.

NOTE

If vellutex washers are worn or damaged, use the new vellutex washers supplied with kit.

10. Connect the two leads from the speaker to the electronic siren's speaker cable. Refer to the instruction sheet packed with the electronic siren for additional details.

WARNING

All effective sirens produce loud sounds which may cause, in certain situations, permanent hearing loss. You should take appropriate precautions such as wearing hearing protection.

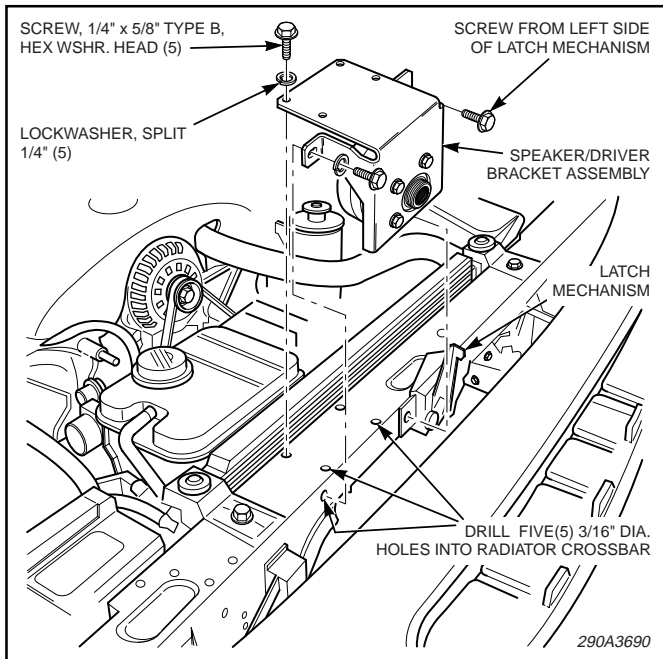

Figure 3.

11. Test the speaker for proper operation.

12. Replace the plastic panel and secure in position using the previously removed plastic twist fasteners. Reinstall the front grill by pressing the grill clips into position and use the six previously removed 11mm nuts.

SAFETY MESSAGE TO OPERATORS

Listed below are some important safety instructions and precautions you should follow:

- All effective sirens produce loud sounds which may cause, in certain situations, permanent hearing loss. You should take appropriate precautions such as wearing hearing protection.
- Your hearing and the hearing of others, in or close to your emergency vehicle, could be damaged by loud sounds. This can occur from short exposures to very loud sounds, or from longer exposures to moderately loud sounds. For hearing conservation guidance, refer to federal, state, or local recommendations. OSHA Standard 1910.95 offers guidance on "Permissible Noise Exposure."
- Optimum sound propagation will be reduced if speaker becomes clogged with a foreign substance such as mud or snow. While cleaning, ensure that substance is not packed into speaker.
- Although your warning system is operating properly, it may not be completely effective. People may not hear, see, or heed your warning signal. You must recognize this fact and continue driving cautiously.
- Also, situations may occur which obstruct your warning signal when natural or man-made objects are between your vehicle and others. If these situations occur, be especially careful.
- It is important that you fully understand how to safely operate this warning system before use.

Failure to follow these safety precautions may result in property damage, serious injury, or death to you, to passengers, or to others.

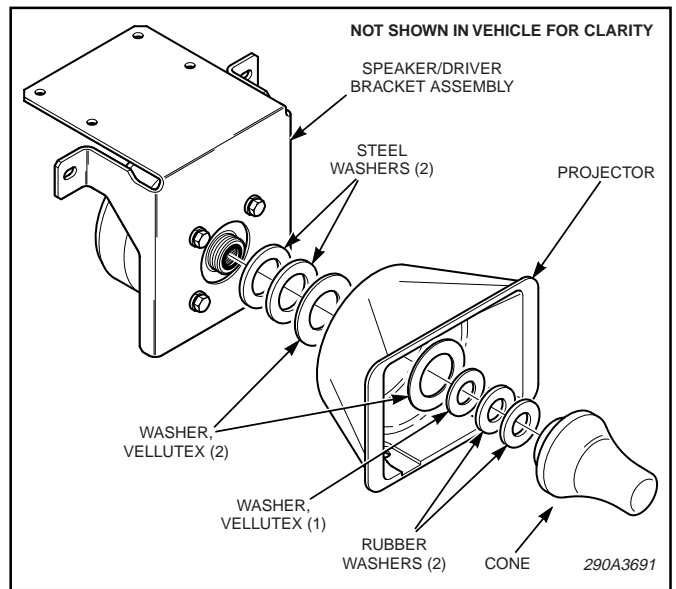

Figure 4.