

ATTENTION	Disconnect power before servicing
ATENCIÓN	Desconecte la corriente antes de abrir el producto
ATTENTION	Débranchez l'alimentation avant de toute intervention sur le produit

SLM600  
SLM800

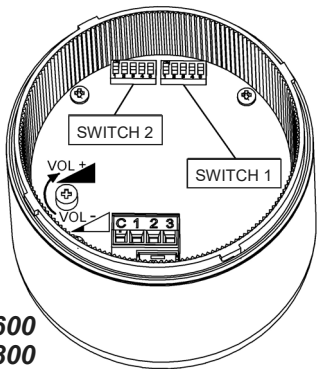

#### SETTING EXAMPLE

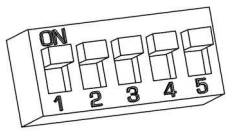

ON=1  
OFF=0

1 1 1 1 1

SWITCH 2: SIMULATED BELL  
SWITCH 1: CHIME 3 REP

## INSTALLATION AND APPLICATION INSTRUCTIONS INSTRUCCIONES DE INSTALACIÓN Y EMPLEO - INSTRUCTIONS D' INSTALLATION ET D' UTILISATION



E162485  
AUD. AND VIS. APPLIANCE  
ENCLOSURE TYPE 3R  
FOR INDOOR/OUTDOOR

SLM600  
SLM800

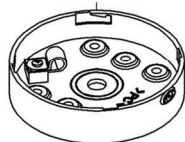
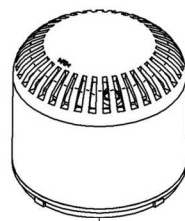

SLMBS-012-024

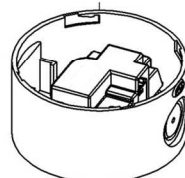

SLMBD-012-024  
SLMBD-PNP-012-024  
SLMBD-120-240

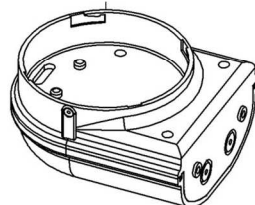

SLMBW-012-024  
SLMBW-PNP-012-024  
SLMBW-120-240

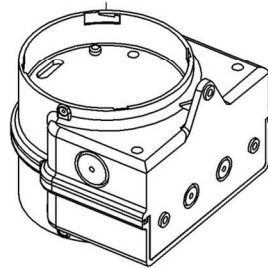

SLMBT-012-024  
SLMBT-PNP-012-024  
SLMBT-120-240

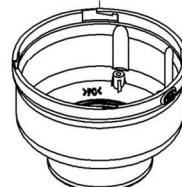

SLMBP-012-024  
SLMBP-PNP-012-024  
SLMBP-120-240

SW1

SWITCH B SOUNDS						
No.	tone	tone type	F[Hz]	times	description	dip switch
1	INTERMITTENT	-----	490	0.5s ON/1s OFF	GENERAL PURPOSE - WARNING	0 0 0 0 0
2	BI-TONE	=====	480 - 610	0.5s/0.5s	GENERAL PURPOSE - EVACUATION 1	1 0 0 0 0
3	LINEAR	=====	610	-	GENERAL PURPOSE - EVACUATION 2	0 1 0 0 0
4	LINEAR	=====	500	-	GENERAL PURPOSE	1 1 0 0 0
5	LINEAR	=====	970	-	BS5839-1:2002	0 0 1 0 0
6	SWEEP	=====	500 - 1200	CICLE 3.75s/0.25s OFF	AS2220	1 0 1 0 0
7	SWEEP	=====	1400 - 1600	CICLE 1.5s	NF 48-265	0 1 1 0 0
8	SWEEP	=====	800 - 970	CICLE 1.5s	BS5839-1:2002	1 1 1 0 0
9	SWEEP	=====	1200 - 500	CICLE 1s	DIN 33 404	0 0 0 1 0
10	INTERMITTENT	-----	544	0.625s ON/0.625s OFF	GENERAL PURPOSE	1 0 0 1 0
11	INTERMITTENT	-----	660	6.5s ON/13s OFF	SWEDISH (PRE-MESS)	0 1 0 1 0
12	INTERMITTENT	-----	970	1s ON/1s OFF	APOLLO FIRE SYSTEM BS5839	1 1 0 1 0
13	INTERMITTENT	-----	2850	0.5s ON/0.5s OFF X 3 1.5s OFF	ISO 8201 HIGH TONE	0 0 1 1 0
14	BI-TONE	=====	970 - 630	0.5s/0.5s	APOLLO FIRE SYSTEM BS5839	1 0 1 1 0
15	BI-TONE	=====	554 - 440	0.1s/0.4s	FRANCE - AFNOR NFS 32 001	0 1 1 1 0
16	BI-TONE	=====	440 - 554	0.5s/0.5s	GENERAL PURPOSE	1 1 1 1 0
17	BI-TONE	=====	510 - 610	0.5s/0.5s	GENERAL PURPOSE	0 0 0 0 1
18	BI-TONE	=====	510 - 610	1s/1s	GENERAL PURPOSE	1 0 0 0 1
19	BI-TONE	=====	600 - 700	1s/1s	GENERAL PURPOSE	0 1 0 0 1
20	BI-TONE	=====	550 - 1000	0.5s/0.5s	GENERAL PURPOSE	1 1 0 0 1
21	BI-TONE	=====	550 - 1000	1s/1s	GENERAL PURPOSE	0 0 1 0 1
22	BI-TONE	=====	800 - 1000	0.5s/0.5s	GENERAL PURPOSE	1 0 1 0 1
23	BI-TONE	=====	800 - 1000	1s/1s	GENERAL PURPOSE	0 1 1 0 1
24	BI-TONE	=====	1000 - 2000	0.5s/0.5s	GENERAL PURPOSE	1 1 1 0 1
25	BI-TONE	=====	2400 - 2850	0.265s/0.265s	GENERAL PURPOSE	0 0 0 1 1
26	BI-TONE	=====	2400 - 2850	0.465s/0.465s	GENERAL PURPOSE	1 0 0 1 1
27	BI-TONE	=====	640 - 970	0.5s/0.5s	GENERAL PURPOSE	0 1 0 1 1
28	BI-TONE	=====	490 - 610	0.25s/0.25s	GENERAL PURPOSE	1 1 0 1 1
29	CHIME 2 SINGLE	=====	554 - 440	0.35s/0.7s	SINGLE SHOT DING DONG	0 0 1 1 1
30	CHIME 2 REP	=====	554 - 440	0.35s/0.7s/0.5s OFF	REPEATING DING DONG	1 0 1 1 1
31	CHIME 3 SINGLE	=====	1300 - 944	0.5s/1s	SINGLE SHOT DING DONG	0 1 1 1 1
32	CHIME 3 REP	=====	1300 - 944	0.5s/1s/0.5s OFF	REPEATING DING DONG	1 1 1 1 1

SW2

SWITCH A SOUNDS						
No.	tone	tone type	F[Hz]	times	description	dip switch
1	BI-TONE	=====	600 - 700	0.5s/0.5s	STANDARD	0 0 0 0 0
2	MULTI-TONE	=====	1000 - 1700	CICLE 0.25s	STANDARD	1 0 0 0 0
3	MODULATED	=====	1000 - 1700	CICLE 0.8s	STANDARD	0 1 0 0 0
4	BI-TONE	=====	440 - 560	565s/565s	STANDARD - EVACUATION	1 1 0 0 0
5	LINEAR	=====	300	-	GENERAL PURPOSE	0 0 1 0 0
6	LINEAR	=====	660	-	SWEDISH (ALL CLEAR)	1 0 1 0 0
7	LINEAR	=====	750	-	GENERAL PURPOSE	0 1 1 0 0
8	LINEAR	=====	2850	-	GENERAL PURPOSE	1 1 1 0 0
9	SWEEP	=====	500 - 1200	3.5s ON/0.5s OFF	NETHERLANDS-NEN2575:2000	0 0 0 1 0
10	SWEEP	=====	500 - 1200	0.5s ON/0.5s OFF X 3 1.5s OFF	AUSTRALIA AS1670	1 0 0 1 0
11	SWEEP	=====	800 - 970	0.5s ON/0.5s OFF X 3 1.5s OFF	ISO 8201	0 1 0 1 0
12	INTERMITTENT	-----	420	0.625s ON/0.625s OFF	AUSTRALIA AS1670 ALERT TONE	1 1 0 1 0
13	INTERMITTENT	-----	660	0.15s ON/0.15s OFF	SWEDISH (AIR RAID)	0 0 1 1 0
14	INTERMITTENT	-----	660	1.8s ON/1.8s OFF	SWEDISH (LOCAL WARNING)	1 0 1 1 0
15	INTERMITTENT	-----	660	0.5s ON/0.5s OFF	SWEDISH GENERAL PURPOSE	0 1 1 1 0
16	INTERMITTENT	-----	720	0.7s ON/0.3s OFF	GENERAL PURPOSE	1 1 1 1 0
17	INTERMITTENT	-----	750	0.33s ON/0.5s OFF	GENERAL PURPOSE	0 0 0 0 1
18	INTERMITTENT	-----	800	0.25s ON/1s OFF	GENERAL PURPOSE	1 0 0 0 1
19	INTERMITTENT	-----	970 - 800	0.35s/0.35s/0.35s OFF X 3 1.5s OFF	ISO 8201	0 1 0 0 1
20	INTERMITTENT	-----	970	0.5s ON/0.5s OFF X 3 1.5s OFF	ISO 8201 LOW TONE	1 1 0 0 1
21	INTERMITTENT	-----	970	0.25s ON/0.25s OFF	GENERAL PURPOSE	0 0 1 0 1
22	INTERMITTENT	-----	2850	1s ON/1s OFF	GENERAL PURPOSE	1 0 1 0 1
23	INTERMITTENT	-----	2850	0.25s ON/0.25s OFF	GENERAL PURPOSE	0 1 1 0 1
24	BI-TONE	=====	600 - 700	0.5s/0.5s	GENERAL PURPOSE	1 1 1 0 1
25	BI-TONE	=====	800 - 970	0.25s/0.25s	BS5839-1:2002	0 0 0 1 1
26	BI-TONE	=====	800 - 970	0.8s/0.8s	GENERAL PURPOSE	1 0 0 1 1
27	BI-TONE	=====	1000 - 2000	1s/1s	GENERAL PURPOSE	0 1 0 1 1
28	CHIME 1 SINGLE	=====	700 - 600	0.4s/0.7s	SINGLE SHOT DING DONG	1 1 0 1 1
29	CHIME 1 REPEATING	=====	700 - 600	0.4s/0.7s OFF	REPEATING DING DONG	0 0 1 1 1
30	CHIME 1 REPEATING	=====	700 - 600	0.25s/0.4s OFF	REPEATING DING DONG	1 0 1 1 1
31	HOOTER REPEATING	=====	-	3s ON/2s OFF	GENERAL PURPOSE	0 1 1 1 1
32	SIMULATED BELL	=====	1850	0.1s (modulated 0.03s)	GENERAL PURPOSE	1 1 1 1 1

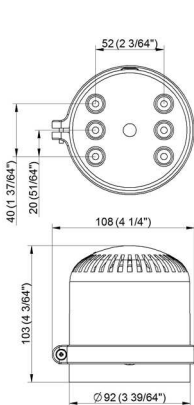

SLM600 + SLMBS  
SLM800 + SLMBS

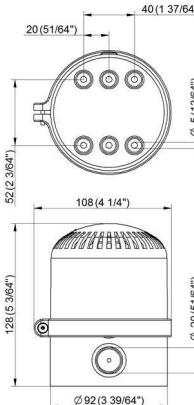

SLM600 + SLMBD  
SLM800 + SLMBD

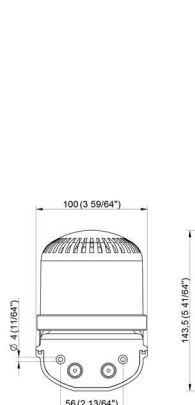

SLM600 + SLMBW  
SLM800 + SLMBW

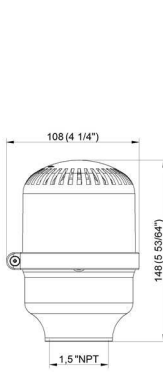

SLM600 + SLMBP  
SLM800 + SLMBP

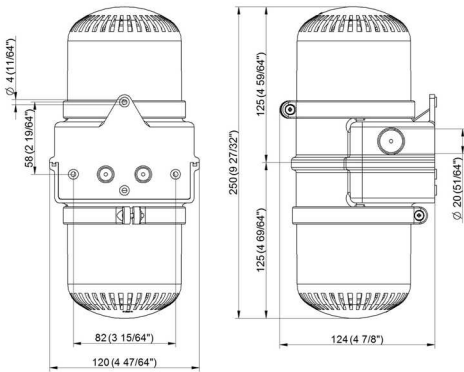

SLM600 + SLMBT  
SLM800 + SLMBT

V ---	12-24	
V ~		
A (*)	1	0,5
A (**)	3	1
dB(A)1m	103 - 115	

V ~	120-240	
A (*)	0,08	0,05
A (**)	0,18	0,1
dB(A)1m	99 - 111	

\* = Minimum current absorption associated with tone (No. 31 SW2)  
Absorción de corriente mínima asociada al sonido (nro 31 SW2)  
Consommation de courant minimale associée au son (n° 31 SW2)

\*\* = Maximum current absorption associated with tone (No. 32 SW1)  
Absorción de corriente máxima asociada al sonido (nro 32 SW1)  
Consommation de courant maximale associée au son (n° 32 SW1)

FUSE WIRE PROTECTION	On the power supply line the rating of the supply fuse must be according to the voltage
FUSIBLE DE PROTECCIÓN	En la línea de alimentación emplear fusibles de seguridad adecuados al voltaje
FUSIBLE DE PROTECTION	Sur la ligne d'alimentation utiliser des fusibles retardés dimensionnés selon la tension

All dims in mm unless otherwise noted  
Todas las dimensiones son en mm, salvo que sea indicado de otra manera  
Toutes les dimensions sont en mm, sauf indication contraire

TO BE INSTALLED BY QUALIFIED PERSONNEL ONLY  
LA INSTALACIÓN SÓLO DEBE SER REALIZADA POR PERSONAL CUALIFICADO - L'INSTALLATION DOIT ÊTRE EFFECTUÉE PAR PERSONNEL QUALIFIÉ

NOT TO BE DISPOSED OF AS COMMON WASTE - NO ELIMINAR COMO DESECHO URBANO - NE PAS ELIMINER COMME DECHET URBAIN

ATTENTION	The possibility exists that rapid flashing lights, under certain circumstances, might induce photosensitive epilepsy
ATENCIÓN	Existe la posibilidad que luces de intermitencia rápida, en determinadas circunstancias, podrían inducir epilepsia fotosensible
ATTENTION	Il est possible que des feux clignotants rapides, dans certaines circonstances, peuvent induire épilepsie photosensible



C + 2 has priority over C + 1  
C + 2 tiene prioridad en C + 1  
C + 2 est prioritaire sur C + 1

C + 3 has priority over C + 2 and C + 1  
C + 3 tiene prioridad en C + 2 y C + 1  
C + 3 est prioritaire sur C + 2 et C + 1

C + 5 has priority over C + 4  
C + 5 tiene prioridad en C + 4  
C + 5 est prioritaire sur C + 4

C + 6 has priority over C + 5 and C + 4  
C + 6 tiene prioridad en C + 5 y C + 4  
C + 6 est prioritaire sur C + 5 et C + 4

WIRING/CABLEADO/CÂBLAGE BASES LT (12-24V DC/AC)

**SLMBS-012-024 / SLMBD-012-024 / SLMBW-012-024 / SLMBT-012-024 / SLMBP-012-024**

12-24V DC/AC

①

②

**C + 1 (only SLM600 version):** LED flashing light  
**C + 1 (únicamente para la versión SLM600):** Luz intermitente de LED  
**C + 1 (seulement pour version SLM600):** Lumière à LED clignotante

**C + 2:** LED flashing light (SLM600 version) + SWITCH 2 sound  
**C + 2:** Luz intermitente de LED (versión SLM600) + Sonido SWITCH 2  
**C + 2:** Lumière à LED clignotante (version SLM600) + son SWITCH 2

**C + 3:** LED steady light (SLM600 version) + SWITCH 1 sound  
**C + 3:** Luz fija de LED (versión SLM600) + Sonido SWITCH 1  
**C + 3:** Lumière à LED fixe (version SLM600) + son SWITCH 1

③

WIRING/CABLEADO/CÂBLAGE BASES LT PNP (12-24V DC) and BASES HT (120-240V AC)

<b>SLMBD-PNP-012-024 / SLMBW-PNP-012-024 / SLMBP-PNP-012-024</b>	12-24V DC
<b>SLMBD-120-240 / SLMBW-120-240 / SLMBP-120-240</b>	120-240V AC

①

②

②

②

③

③

③

⑤

⑤

⑤

④ **LT PNP**

④ **HT**

**C + 1**

(only SLM600 version): LED flashing light  
(únicamente para la versión SLM600): Luz intermitente de LED  
(seulement pour version SLM600): Lumière à LED clignotante

**C + 2**

LED flashing light (SLM600 version) + SWITCH A sound  
Luz intermitente de LED (versión SLM600) + Sonido SWITCH A  
Lumière à LED clignotante (version SLM600) + son SWITCH A

**C + 3**

LED steady light (SLM600 version) + SWITCH B sound  
Luz fija de LED (versión SLM600) + Sonido SWITCH B  
Lumière à LED fixe (version SLM600) + son SWITCH B

**SLMBT-PNP-012-024**

12-24V DC

**SLMBT-120-240**

120-240V AC

①

②

③

④

⑤ **LT PNP: UPPER POS.**

⑤ **LT PNP: LOWER POS.**

⑤ **HT: UPPER POS.**

⑤ **HT: LOWER POS.**

**C + 1**

(only SLM600 version): LED flashing light  
(únicamente para la versión SLM600): Luz intermitente de LED  
(seulement pour version SLM600): Lumière à LED clignotante

**C + 2**

LED flashing light (SLM600 version) + SWITCH 2 sound  
Luz intermitente de LED (versión SLM600) + Sonido SWITCH 2  
Lumière à LED clignotante (version SLM600) + son SWITCH 2

**C + 3**

LED steady light (SLM600 version) + SWITCH 1 sound  
Luz fija de LED (versión SLM600) + Sonido SWITCH 1  
Lumière à LED fixe (version SLM600) + son SWITCH 1

**C + 4**

(only SLM600 version): LED flashing light  
(únicamente para la versión SLM600): Luz intermitente de LED  
(seulement pour version SLM600): Lumière à LED clignotante

**C + 5**

LED flashing light (SLM600 version) + SWITCH 2 sound  
Luz intermitente de LED (versión SLM600) + Sonido SWITCH 2  
Lumière à LED clignotante (version SLM600) + son SWITCH 2

**C + 6**

LED steady light (SLM600 version) + SWITCH 1 sound  
Luz fija de LED (versión SLM600) + Sonido SWITCH 1  
Lumière à LED fixe (version SLM600) + son SWITCH 1

⑥

DOME TIGHTENING/APRIETE DE LA CÚPULA/SERRAGE DU DÔME

①

②

③

④

(SLM600/SLM800) + SLMBS

①

②

③

④

⑤

(SLM600/SLM800) + SLMBW

①

②

③

④

(SLM600/SLM800) + SLMBD

①

②

③

④

(SLM600/SLM800) + SLMBP

①

②

③

④

⑤

(SLM600/SLM800) + SLMBT