

DOME TIGHTENING/APRIETE DE LA CÚPULA/SERRAGE DU DÔME

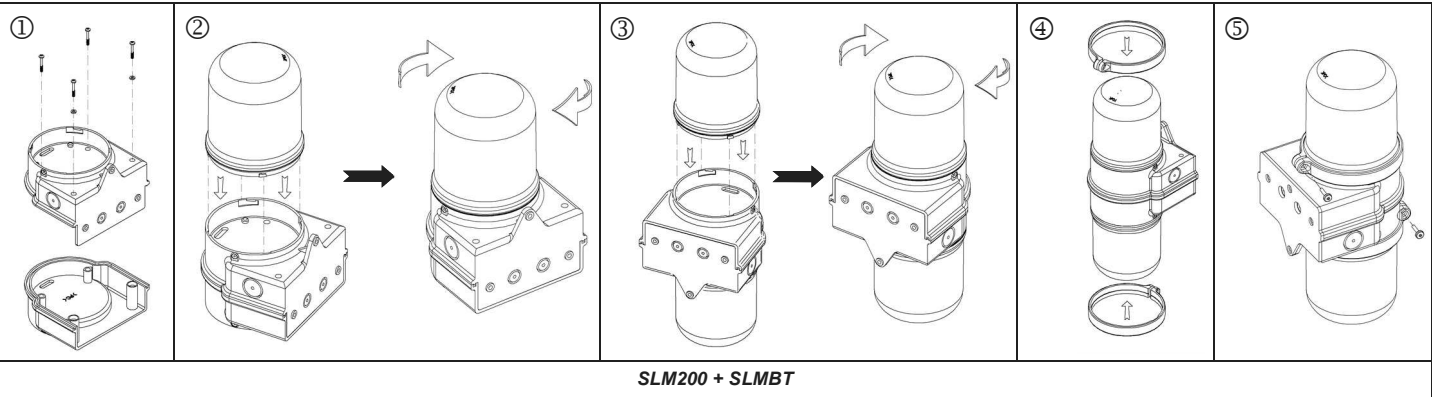
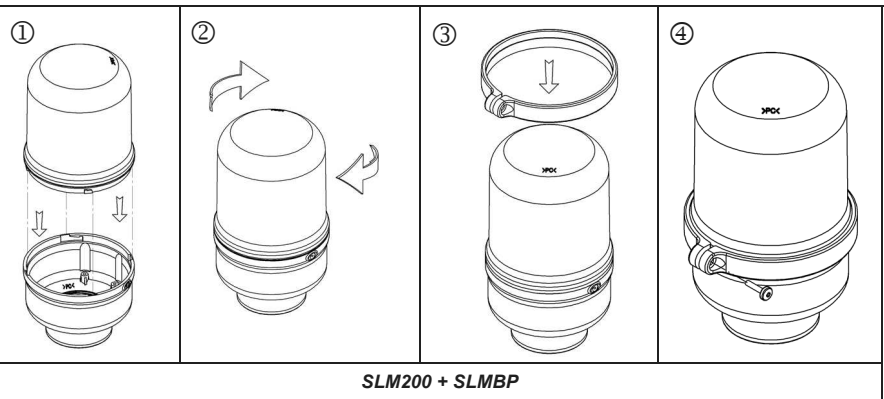
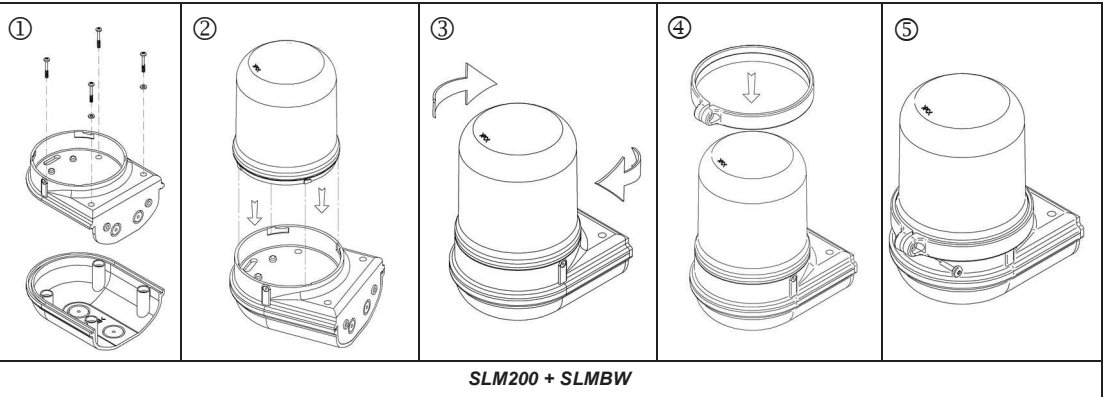
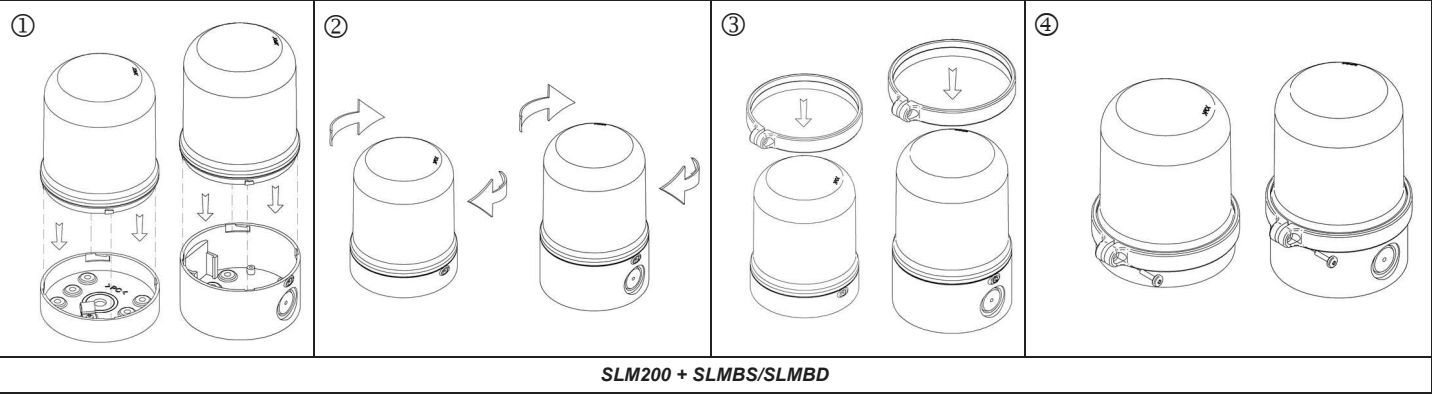

ATTENTION	The possibility exists that rapid flashing lights, under certain circumstances, might induce photosensitive epilepsy
ATENCIÓN	Existe la posibilidad que luces de intermitencia rápida, en determinadas circunstancias, podrían inducir epilepsia fotosensible
ATTENTION	Il est possible que des feux clignotants rapides, dans certaines circonstances, peuvent induire épilepsie photosensible

TO BE INSTALLED BY QUALIFIED PERSONNEL ONLY
 LA INSTALACIÓN SÓLO DEBE SER REALIZADA POR PERSONAL CUALIFICADO - L'INSTALLATION DOIT ÊTRE EFFECTUÉE PAR PERSONNEL QUALIFIÉ

NOT TO BE DISPOSED OF AS COMMON WASTE - NO ELIMINAR COMO DESECHO URBANO - NE PAS ELIMINER COMME DECHET URBAIN

INSTALLATION AND APPLICATION INSTRUCTIONS
 INSTRUCCIONES DE INSTALACIÓN Y EMPLEO - INSTRUCTIONS D'INSTALLATION ET D'UTILISATION



E162485
 VIS. APPLIANCE
 ENCLOSURE TYPE 4X
 FOR INDOOR/OUTDOOR

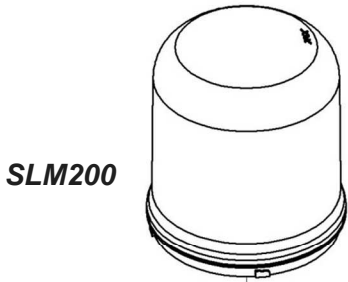

IP69K
 enclosure
 with
 SLM-RR

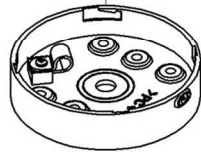

SLMBS-012-024

IP69K
 enclosure
 with
 SLM-RR

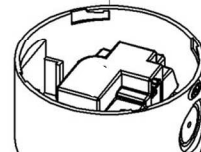

SLMBD-012-024
 SLMBD-PNP-012-024
 SLMBD-120-240

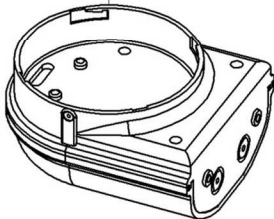

SLMBW-012-024
 SLMBW-PNP-012-024
 SLMBW-120-240

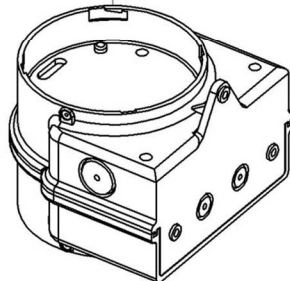

SLMBT-012-024
 SLMBT-PNP-012-024
 SLMBT-120-240

IP69K
 enclosure
 with
 SLM-RR

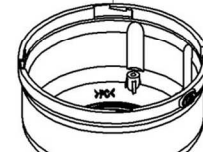

SLMBP-012-024
 SLMBP-PNP-012-024
 SLMBP-120-240

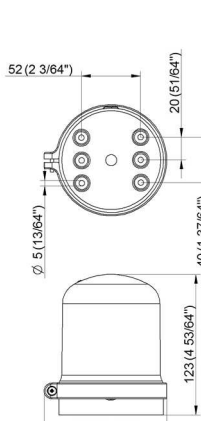

SLM200 + SLMBS

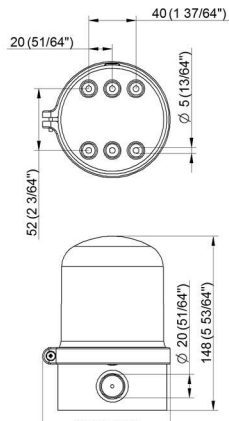

SLM200 + SLMBD

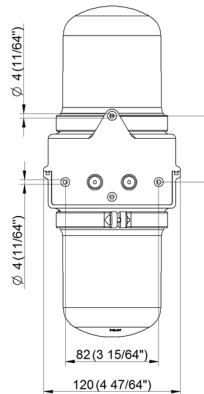

SLM200 + SLMBT

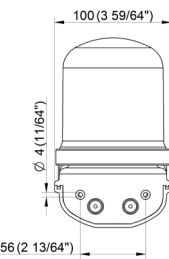

SLM200 + SLMBW

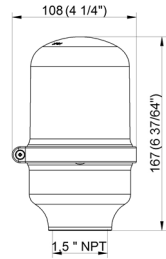

SLM200 + SLMBP

All dims in mm unless otherwise noted
 Todas las dimensiones son en mm, salvo que sea indicado de otra manera
 Toutes les dimensions sont en mm, sauf indication contraire

SLM200		
V $\overline{\text{---}}$	12-240	
V \sim	450	700
mA	150	40

ATTENTION	Disconnect power before servicing
ATENCIÓN	Desconecte la corriente antes de abrir el producto
ATTENTION	Débranchez l'alimentation avant de toute intervention sur le produit

WIRING/CABLEADO/CÂBLAGE BASES LT (12-24V DC/AC)

①

②

	SLM 200
C ÷ 1	Intermittent light (1F) Luz intermitente (1F) Lumière clignotante (1F)
C ÷ 2	Flashing light (5F) Luz de destellos (5F) Lumière à éclats (5F)
C ÷ 3	RANDOM light Luz RANDOM Lumière RANDOM

③

④

WIRING/CABLEADO/CÂBLAGE BASES HT (120-240V AC)

SLMBD-PNP-012-024 / SLMBW-PNP-012-024 / SLMBP-PNP-012-024	12-24V DC
SLMBD-120-240 / SLMBW-120-240 / SLMBP-120-240	120-240V AC

①

②

②

②

③

③

③

④ LT PNP

④ HT

	SLM 200
C ÷ 1	Intermittent light (1F) Luz intermitente (1F) Lumière clignotante (1F)
C ÷ 2	Flashing light (5F) Luz de destellos (5F) Lumière à éclats (5F)
C ÷ 3	RANDOM light Luz RANDOM Lumière RANDOM

⑤

⑤

⑤

SLMBT-PNP-012-024	12-24V DC
SLMBT-120-240	120-240V AC

①

②

③

④

⑤ LT PNP: UPPER POS.

⑤ HT: UPPER POS.

	SLM 200
C ÷ 1	Intermittent light (1F) Luz intermitente (1F) Lumière clignotante (1F)
C ÷ 2	Flashing light (5F) Luz de destellos (5F) Lumière à éclats (5F)
C ÷ 3	RANDOM light Luz RANDOM Lumière RANDOM

⑤ LT PNP: LOWER POS.

⑤ HT: LOWER POS.

	SLM 200
C ÷ 4	Intermittent light (1F) Luz intermitente (1F) Lumière clignotante (1F)
C ÷ 5	Flashing light (5F) Luz de destellos (5F) Lumière à éclats (5F)
C ÷ 6	RANDOM light Luz RANDOM Lumière RANDOM

⑥

⚠

C ÷ 6 has priority over C ÷ 5 and C ÷ 4

C ÷ 6 tiene prioridad en C ÷ 5 y C ÷ 4

C ÷ 6 est prioritaire sur C ÷ 5 et C ÷ 4

C ÷ 5 has priority over C ÷ 4

C ÷ 5 tiene prioridad en C ÷ 4

C ÷ 5 est prioritaire sur C ÷ 4

C ÷ 3 has priority over C ÷ 2 and C ÷ 1

C ÷ 3 tiene prioridad en C ÷ 2 y C ÷ 1

C ÷ 3 est prioritaire sur C ÷ 2 et C ÷ 1

C ÷ 2 has priority over C ÷ 1

C ÷ 2 tiene prioridad en C ÷ 1

C ÷ 2 est prioritaire sur C ÷ 1

FUSE WIRE PROTECTION	On the power supply line the rating of the supply fuse must be according to the voltage
FUSIBLE DE PROTECCIÓN	En la línea de alimentación emplear fusibles de seguridad adecuados al voltaje
FUSIBLE DE PROTECTION	Sur la ligne d'alimentation utiliser des fusibles retardés dimensionnés selon la tension