

25500708 REV. A0 0321

**Safety Message to Installers and Operators of Warning Lights****⚠ WARNING**

People's lives depend on your proper installation and servicing of Federal Signal products. It is important to read and follow all instructions shipped with this product and the original product. Listed below are some other important safety instructions and precautions you should follow.

**Before Installation or Service***Qualifications*

- To properly install or service this equipment, you must have a good understanding of automotive electrical procedures and systems along with proficiency in the installation and service of safety warning equipment. Always refer to the vehicle service manuals when installing equipment on a vehicle.

*Electrical Hazards*

- Never attempt to install aftermarket equipment that connects to the vehicle wiring without reviewing a vehicle wiring diagram available from the vehicle manufacturer. Ensure that your installation will not affect vehicle operation and safety functions or circuits.

**During Installation or Service**

- To avoid a battery explosion, always disconnect the negative battery cable first and reconnect it last. Avoid a spark when connecting near or to the battery. The gasses produced by a battery can cause a battery explosion that could result in vehicle damage and serious injury.
- Do not install equipment or route wiring or a plug-in cord in the deployment path of an airbag.
- Before mounting any components, check the manual to be sure that the component you are installing is suitable for use in that area of the vehicle. Many components are not suitable for use in the engine compartment or in other areas subject to extreme environmental exposure.
- When drilling into a vehicle structure, be sure that both sides of the surface are clear of anything that could be damaged. Remove all burrs from drilled holes to prevent electrical shorts, grommet all drilled holes through which wiring passes. Also ensure that mounting screws do not cause electrical or mechanical damage to the vehicle.

**After Installation or Service**

- If a vehicle seat is temporarily removed, verify with vehicle manufacturer if the seat needs to be recalibrated for proper airbag deployment.
- To ensure proper operation, test all vehicle functions, including horn operation, vehicle safety functions, and vehicle light systems. Ensure that installation has not affected vehicle operation or changed any vehicle safety function or circuit.
- After installation and testing are complete, provide a copy of these instructions to instructional staff and all operating personnel.
- File these instructions in a safe place and refer to them when maintaining and/or reinstalling the product.

Failure to follow all safety precautions and instructions may result in property damage, serious injury, or death.

### Unpacking the Kit

After unpacking the product, inspect it for damage that may have occurred in transit. If it has been damaged or is missing a part, do not attempt to install or operate it. File a claim immediately with the carrier, stating the extent of the damage. Carefully check all envelopes, shipping labels and tags before removing or destroying them. Ensure that all parts in Table 1 have been included. If you are missing any parts, contact Customer Support at 1-800-264-3578, 7 A.M. to 5 P.M., Monday through Friday (CT).

Table 1 Kit contents

Item	Qty	Description	Tools Needed
1	1	Driver Wing Wrap	mm Socket
2	1	Passenger Wing Wrap	Wratchet
3	4	M10 Button Head Bolt	Torque Wrench
4	4	M10 Bellville Washer	
5	4	M10 Serrated Flange Nut	
6	2	M12 Button Head Bolt	
7	2	M12 Serrated Flange Nut	
8	2	M12 Bellville Washer	
9	2	M6 Button Head Bolt	
10	2	M6 Serrated Flange Nut	
11	2	M6 Flat Washer	
12	2	M6 Lock Washer	

**NOTE:** Must be installed with push bumper PBX08.

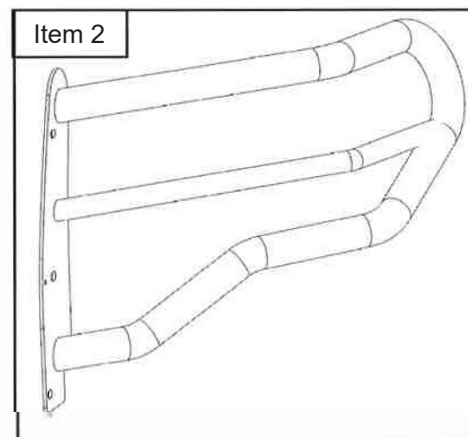
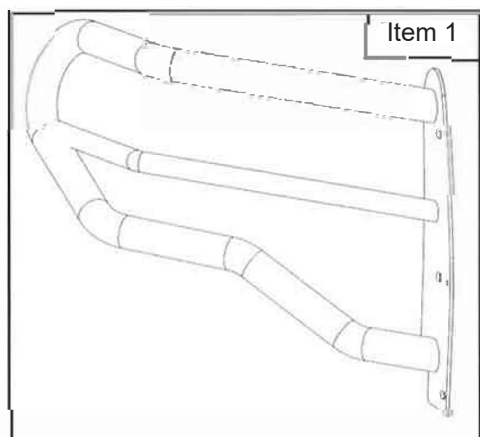

#### **⚠ WARNING**

**PUSH BUMPER PRECAUTION:** Installing a push bumper on a vehicle may raise the vehicle's minimum collision speed for airbag deployment. It is imperative that police officers wear safety belts when operating their motor vehicle. Failure to follow this warning may cause serious injury or death.

#### **NOTICE**

**THREAD DAMAGE AND GALLING:** To prevent thread damage and galling, anti-seize lubricant must be used on all stainless steel fasteners.

## Installing the Wing Wrap

To install the wing wrap:

1. Loosely install both wing wraps on to the push bumper using the supplied M6, M10, and M12 hardware. See Figure 1.

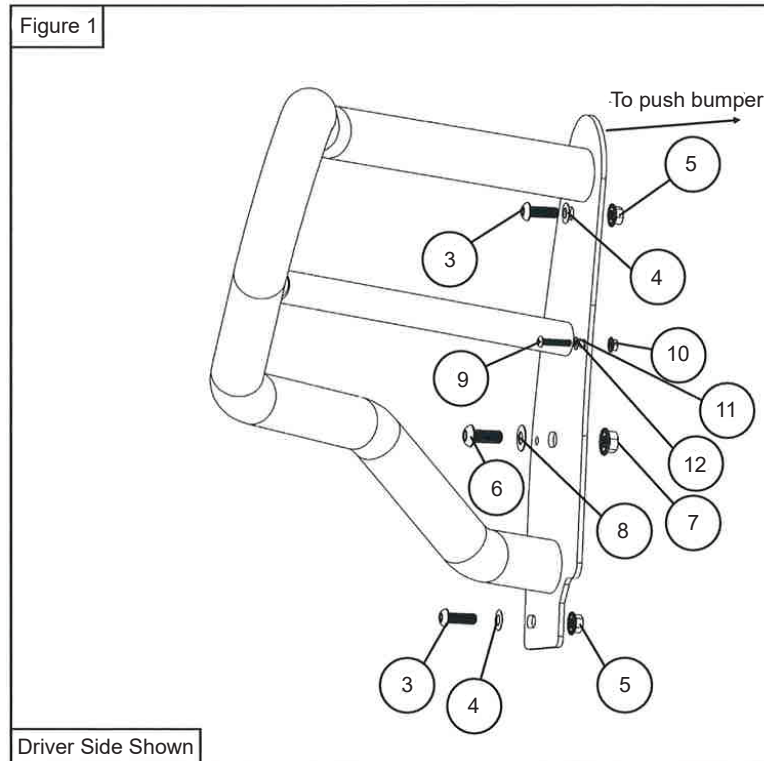

2. Adjust as needed and torque hardware as specified: M6 to 5-7 ft. lb, M10 to 35 ft-lb, M12 to 50 ft-lb.

Installation Completed



### **Maintaining the Wing Wrap Assembly**

Regularly clean stainless steel and gloss black finishes with a mild soap and water. Apply a non-abrasive wax or polish. To polish small scratches on stainless steel, use stainless steel polish. To avoid making scratches on the stainless steel surfaces, follow the grain of the steel while polishing.

### **Getting Technical Support and Service**

For technical support, please contact:

Federal Signal Corporation

Service Department

Phone: 1-800-433-9132

Email: [empserviceinfo@fedsig.com](mailto:empserviceinfo@fedsig.com)



**FEDERAL SIGNAL**  
Safety and Security Systems

2645 Federal Signal Drive  
University Park, Illinois 60484

[www.fedsig.com](http://www.fedsig.com)

Customer Support

Police/Fire-EMS: 800-264-3578 • +1 708 534-3400

Work Truck: 800-824-0254 • +1 708 534-3400

Technical Support 800-433-9132 • +1 708 534-3400

© 2021 Federal Signal Corporation

All product names or trademarks are properties of their respective owners.