

► Global Series® Accessories

Indicator Ring and Legend Plate Kit

Kit includes one (1) indicator ring, one (1) legend plate¹, and associated hardware

Description

Black

Blue

Green

Magenta

Red

Yellow

Part Number

G-KIT-RP-BK

G-KIT-RP-B

G-KIT-RP-G

G-KIT-RP-M

G-KIT-RP-R

G-KIT-RP-Y

¹ Recommended labels: BRADY #B-855 Toughwash labels or ULINE #S-16643 weather resistant



Single Mount U-Bracket Kit

Kit includes one (1) single U-Bracket, two (2) U-Bracket side mounts and associated hardware. It is compatible with all "Ex d" units.

Part Number

G-KIT-ST



Dual Mount U-Bracket Kit

Kit includes one (1) dual U-Bracket, two (2) U-Bracket side mounts and associated hardware. It is compatible with any standard dual unit.

Part Number

G-KIT-DT



Patent No. 9,886,832 B2

Global Series® Coupling Kits

The accessories below allow single unit Global Series® “Ex de” models to be coupled to other Global Series “Ex de” models. These kits allow installers in the field to create multi-unit configurations. Note: multi-unit configurations can be ordered pre-assembled according to a customer specification. The benefit of pre-assembled configurations is reduced on-site wiring and installation.

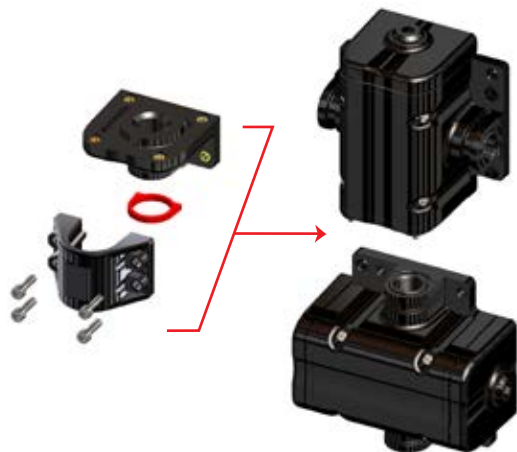

90° e-Box to e-Box Endcap Coupling Kit

Kit includes one (1) flanged e-Box coupler endcap, one (1) coupler, one (1) gasket and four (4) mounting bolts

Part Number
G-KIT-EC90

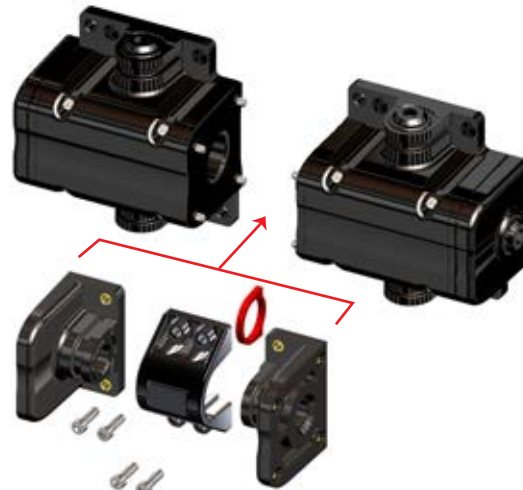

In-Line e-Box to e-Box Endcap Coupling Kit

Kit includes two (2) flanged e-Box coupler endcaps, one (1) coupler, one (1) gasket and four (4) mounting bolts

Part Number
G-KIT-EC180

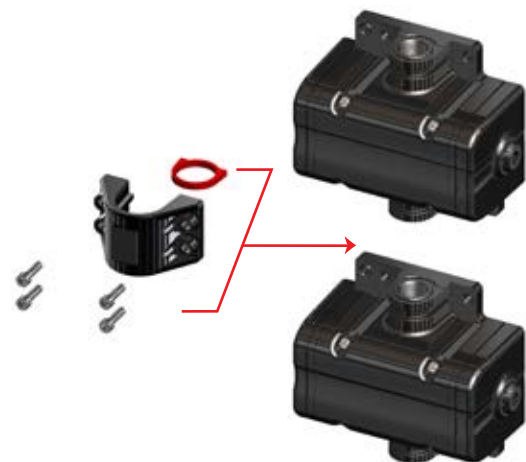

Side Mount e-Box to e-Box Coupling Kit

Kit includes one (1) coupler, one (1) gasket, and four (4) mounting bolts

Part Number
G-KIT-ECSM



Extension Box Kit

Kit includes e-Box without terminal blocks and two (2) M20 Plugs

*Cannot be field assembled to “Ex d” models.

Part Number
G-KIT-EXTB*

Patent No. 9,886,832 B2