

Safety Message to Installers and Service Personnel of Emergency Vehicle Safety Equipment

⚠ WARNING

The lives of people depend on your proper installation and servicing of Federal Signal products. It is important to read and follow all instructions shipped with this product. In addition, listed below are some other important safety instructions and precautions you should follow:

Before Installation or Service

Qualifications

- To properly install or service this equipment, you must have a good understanding of automotive electrical procedures and systems along with proficiency in the installation and service of safety warning equipment. Always refer to the vehicle service manuals when installing equipment on a vehicle.

Electrical Hazards

- Never attempt to install aftermarket equipment that connects to the vehicle wiring without reviewing a vehicle wiring diagram available from the vehicle manufacturer. Ensure that your installation will not affect vehicle operation and safety functions or circuits.

During Installation or Service

- To avoid a battery explosion, always disconnect the negative battery cable first and reconnect it last. Avoid a spark when connecting near or to the battery. The gasses produced by a battery can cause a battery explosion that could result in vehicle damage and serious injury.
- Do not install equipment or route wiring or a plug-in cord in the deployment path of an airbag.
- Before mounting any components, check the manual to be sure that the component you are installing is suitable for use in that area of the vehicle. Many components are not suitable for use in the engine compartment or in other areas subject to extreme environmental exposure.
- When drilling into a vehicle structure, be sure that both sides of the surface are clear of anything that could be damaged. Remove all burrs from drilled holes to prevent electrical shorts, grommet all drilled holes through which wiring passes. Also ensure that mounting screws do not cause electrical or mechanical damage to the vehicle.

After Installation or Service

- If a vehicle seat is temporarily removed, verify with vehicle manufacturer if the seat needs to be recalibrated for proper airbag deployment.
- To ensure proper operation, test all vehicle functions, including horn operation, vehicle safety functions, and vehicle light systems. Ensure that installation has not affected vehicle operation or changed any vehicle safety function or circuit.
- After installation and testing are complete, provide a copy of these instructions to instructional staff and all operating personnel.
- File these instructions in a safe place and refer to them when maintaining and/or reinstalling the product.

Failure to follow all safety precautions and instructions may result in property damage, serious injury, or death.

Unpacking the Product

After unpacking the product, inspect it for damage that may have occurred in transit. If it has been damaged, do not attempt to install or operate it. File a claim immediately with the carrier, stating the extent of damage. **Failure to identify damage before installation could lead to rejection of any claim.** Carefully check all envelopes, shipping labels, and tags before removing or destroying them. Ensure that the parts listed in Table 1 are included in the package. If you are missing any parts, contact Federal Signal Customer Support at 1-800-264-3578, 7 a.m. to 5 p.m., Monday through Friday (CT). Disposal of all shipping materials must be carried out in accordance with national and local codes and standards.

⚠ WARNING

PUSH BUMPER PRECAUTION: Installing a push bumper on a vehicle may raise the vehicle's minimum collision speed for airbag deployment. It is imperative that police officers wear safety belts when operating their motor vehicle. Failure to follow this warning may cause serious injury or death.

NOTICE

THREAD DAMAGE AND GALLING: To prevent thread damage and galling, anti-seize lubricant must be used on all stainless steel fasteners.

Table 1 Kit contents and tools needed

Item	Qty.	Description	Tools Needed
1	1	Top Channel Assembly	Allen Wrench
2	14	M4 Short Button-Head Screw	Screwdriver
3	14	M4 Flat Washer	
4	14	M4 Toothed Lock Washer	
5	8	M4 U-Clip Nut (MicroPulse only)	
6	8	M3 Hex Nut (MicroPulse only)	
7	8	M3 Split Lock Washer (MicroPulse only)	
8	2/4	Steel Adapter Plate	
9	8/16	M3 Phillips Pan Head Screw (MicroPulse only)	
10	16	M3 Flat Washer (MicroPulse only)	

Installing the Top Channel

To install the top channel on the push bar:

- 1a. Install the IPX lights (not included) to the brackets using 8-32 screws supplied with the IPX. Attach assemblies to pushbumper as shown in Figure 1a using the supplied M4 hardware.

Figure 1a IMPAXX light secured to pushbumper (passenger-side)

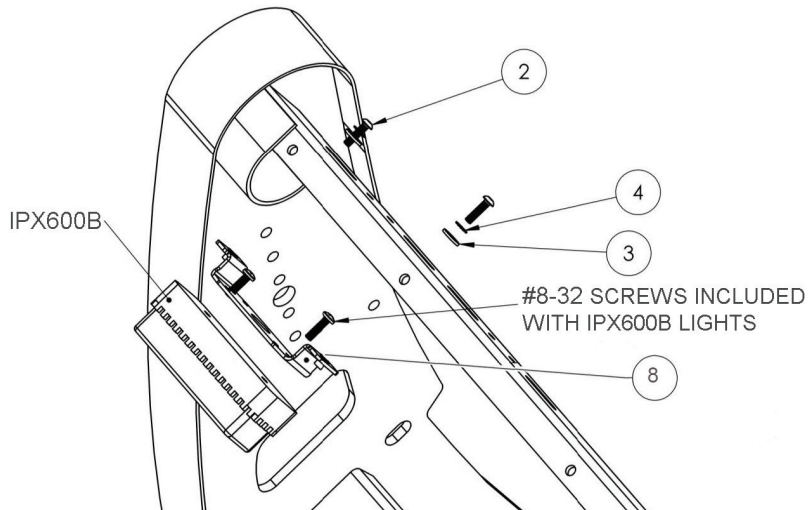

- 1b. See Figure 1b. Install the MicroPulse lights (not included) to the brackets using the supplied M3 hardware. Install the supplied M4 clip nuts to the brackets. Attach assemblies to pushbumper using the supplied M4 hardware.

Figure 1b Assemblies attached to pushbumper

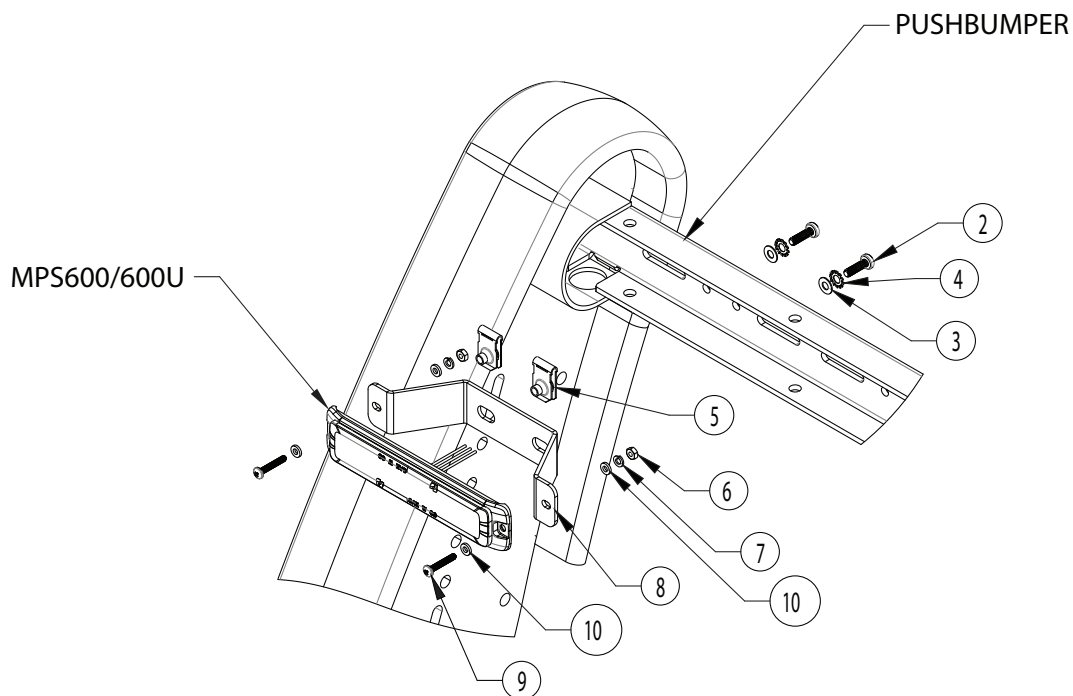

Installing the Top Channel with IMPAXX or MicroPulse Lights to the PBX Push Bar

2. Verify that the lights are centered properly by temporarily holding the top channel in position. Adjust the light position, if necessary.
3. Install the wiring harness according the instructions packed with the light.
4. Install the top channel as shown in Figures 2 and 3.

Figure 2 Top-channel housing positioned over lightheads

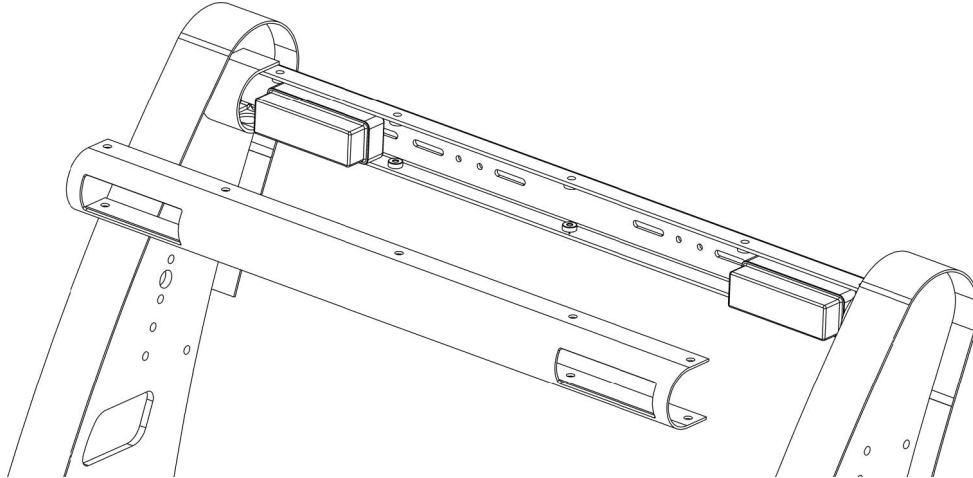
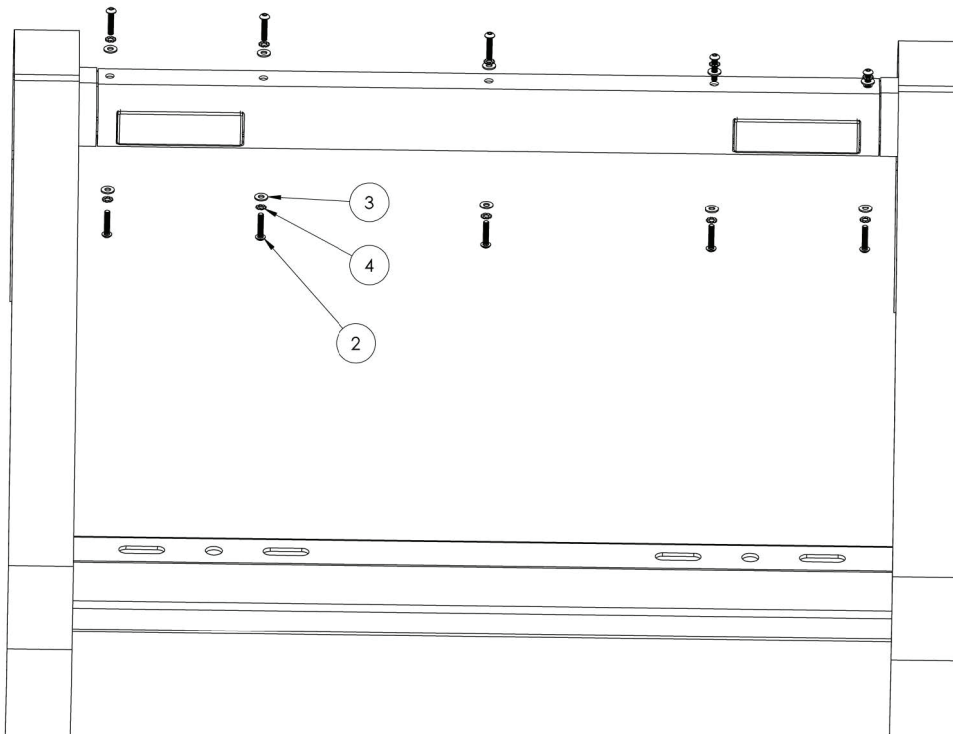

Figure 3 Housing secured to top channel



Maintaining the Push Bar Assembly

Regularly clean stainless steel and gloss black finishes with a mild soap and water. Apply a non-abrasive wax or polish. To polish small scratches on stainless steel, use stainless steel polish. To avoid making scratches on the stainless steel surfaces, follow the grain of the steel while polishing. Take care not to apply the polish to the lightheads.

Getting Technical Support

For technical support, please contact:
Federal Signal Corporation
Service Department
Phone: 1-800-433-9132
Fax: 1-800-343-9706
Email: empserviceinfo@fedsig.com

Getting Repair Service

The Federal Signal factory provides technical assistance with any problems that cannot be handled locally.

Any units returned to Federal Signal for service, inspection, or repair must be accompanied by a Return Material Authorization (RMA). Obtain a RMA from a local Distributor or Manufacturer's Representative.

Provide a brief explanation of the service requested, or the nature of the malfunction.

Address all communications and shipments to the following:

Federal Signal Corporation
Service Department
2645 Federal Signal Dr.
University Park, IL 60484-3167

Ordering Replacement Parts

To order replacement parts, call Customer Support at 1-800-264-3578, 7 AM to 5 PM, Monday through Friday (CT) or contact your nearest distributor.



2645 Federal Signal Drive, University Park, IL 60484-3167
Phone: 708-534-3400 • 800-264-3578 • Fax: 800-682-8022
www.fedsig.com

IMPAXX is a registered trademark of Federal Signal Corporation.