

25500191A Rev. A0

Safety Message to Installers of Warning Light Equipment

⚠ WARNING

People's lives depend on your proper installation and servicing of Federal Signal products. It is important to read and follow all instructions shipped with this product and the original product. In addition, listed below are some other important safety instructions and precautions you should follow:

- To properly install the lighting system, you must have a good understanding of automotive systems, along with proficiency in the installation and use of safety warning equipment.
- Do not install equipment or route wiring in the deployment path of an airbag.
- If a vehicle seat is temporarily removed, verify with the vehicle manufacturer if the seat needs to be recalibrated for proper airbag deployment.
- When drilling into a vehicle structure, be sure that both sides of the surface are clear of anything that could be damaged.
- Refer to the instructions packed with related products for additional precautions and information.
- Do not stare directly into the lights at a close range or permanent damage to your eyesight may occur.
- You should frequently inspect the light system to ensure that it is operating properly and that it is securely attached to the vehicle.
- File these instructions in a safe place and refer to them when maintaining and/or reinstalling the product.

Failure to follow all precautions and instructions may result in property damage, serious injury, or death.

Introduction

This publication covers the installation of a Federal Signal Spectralux™ ILS warning light system in the front headliner of a 2015 Dodge® Durango. The part numbers in these instructions are for vehicle-specific mounting options that are ordered with the product. All mounting systems consist of aluminum shrouds and steel mounting brackets, all of which are powder coated. Mounting hardware is included with each kit.

NOTE: For electrical installation instructions, refer to the installation instructions included with the lights.

Unpacking the Kit

After unpacking the kit, inspect it for damage that may have occurred in transit. If it has been damaged, do not attempt to install or operate it. File a claim immediately with the carrier, stating the extent of damage. Carefully check all envelopes, shipping labels, and tags before removing or destroying them. Disposal of all shipping materials must be carried out in accordance with national and local codes and standards. Ensure that the parts listed in the Kit Contents List are included in the package. If you are missing any parts, contact Customer Support at 1-800-264-3578, 7 a.m. to 5 p.m., Monday through Friday (CT).

Table 1 Kit contents

Description	Part Number	SILSS-####	SILSP-####
Power Harness	1461816	1	1
Cable, RS485	1751357-02	1	1
Cable, Board-To-Board	17500009-18	1	–
Shroud, Front, Driver	862401169	1	–
Shroud, Front, Passenger	862401168	1	1
Bracket, Center	862401170	2	1
Bracket, Outer, Driver	862401172	1	–
Bracket, Outer, Passenger	862401171	1	1
Sealing Strip	8624206-54	1	1
Lockwasher, Ext. Tooth	7075078	4	2
Screw, Pan Hd., Phillips 1/4"-20	7000547-08	4	2
Fuse Kit	8620006-01	1	1

Installing the Mounting Brackets

⚠ WARNING

AIRBAG DEPLOYMENT: Do not install equipment or route wiring in the deployment of an airbag. Failure to observe this warning will reduce the effectiveness of the airbag or potentially dislodge the equipment, causing serious injury or death.

⚠ WARNING

DRILLING PRECAUTIONS: Before drilling holes, check the area into which you plan to drill to ensure you do not damage vehicle components while drilling. All drilled holes should be de-burred and all sharp edges should be smoothed. All wires going through drilled holes should be protected by a grommet or convolute/split-loom tubing.

IMPORTANT: Plan all cable routing before completing the installation. For wiring instructions, refer to instruction sheet 25500021.

To mount the ILS lightbar:

1. See Figure 1 on page 3. Install the extruded-rubber sealing strip on the edges of the shroud(s) that contact the windshield. Cut the strip to fit.
2. Per the manufacturer's service procedure, remove the sun visor(s) and the sun-visor clip(s)
3. Place the outer brackets on the back of the sun-visor pivot(s). Start reinstalling the sun visor by loosely tightening the screws that secure the pivot(s) in the vehicle.
4. Place the inner brackets on the back of the sun-visor clip(s). Start reinstalling the clip(s) by loosely tightening the screws that secure them in the vehicle.
5. Loosely attach the brackets to the shroud with the 1/4"-20 screws and external tooth lockwashers.
6. Ensure the shroud is tight against the windshield and headliner. The sealing strip may require additional trimming. Tighten all hardware.

Figure 1 ILS installed with mounting system on passenger-side

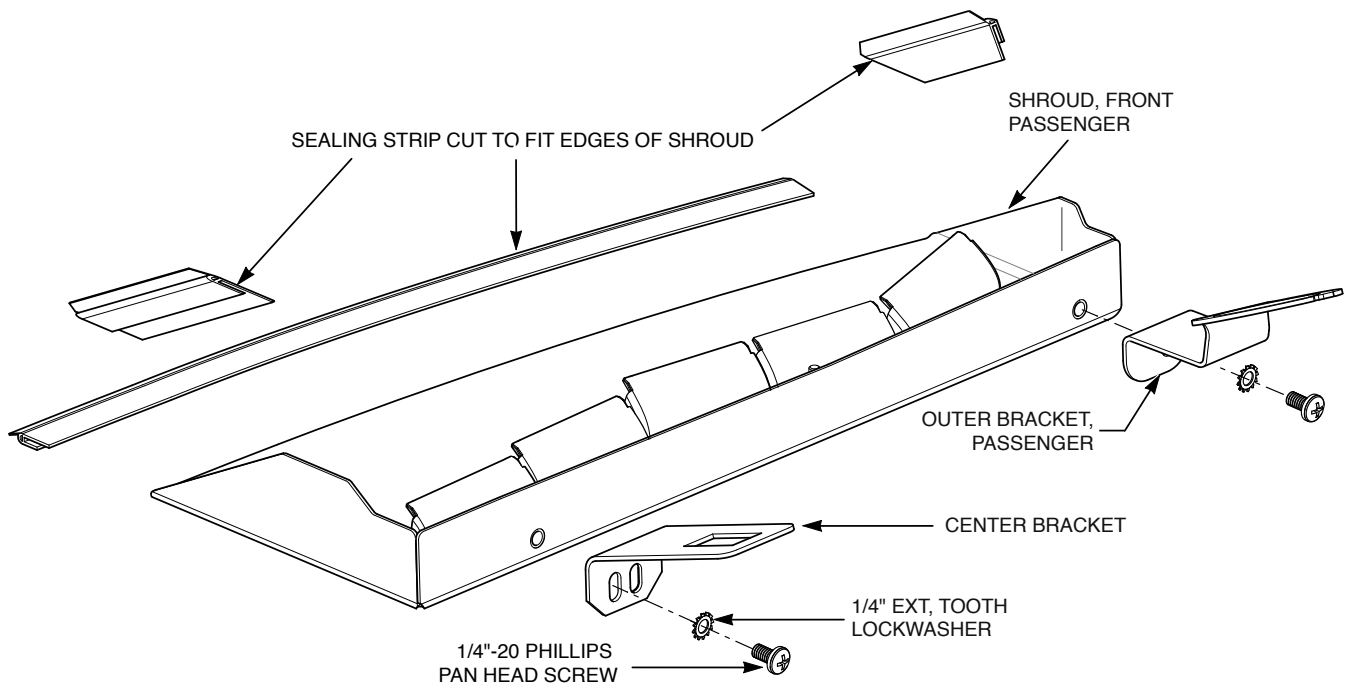

Getting Technical Support and Service

Federal Signal Corporation will service your equipment or provide technical assistance with any problems that cannot be handled locally. Any product returned to Federal Signal for service, inspection, or repair must be accompanied by a Return Material Authorization number. The RMA number can be obtained from your local distributor or Federal Signal. Please provide a brief explanation of the service requested or the nature of the malfunction. Contact your local dealer/distributor for replacement parts availability or contact the Federal Signal Service Department (7 a.m. to 5 p.m., Monday through Friday, Central Time) at:

Service Department
Federal Signal Corporation
2645 Federal Signal Drive
University Park, IL 60484-3167
800-433-9132
www.fedsig.com

Returning a Product to Federal Signal

Before returning a product to Federal Signal, call 800-264-3578, 800-433-9132, or 800-824-0254 to obtain a Returned Merchandise Authorization number (RMA number). To expedite the process, please be prepared with the following information:

- Your Federal Signal customer or account number.
- The purchase order number under which the items were purchased.
- The shipping method.

Spectralux ILS Warning Light System

- The model or part number of the product being returned.
- The quantity of products being returned.
- Drop ship information as needed.
- Any estimate required.

When you receive your RMA Number:

- Write the RMA number on the outside of the box of returned items.
- Reference the RMA number on your paperwork inside of the box.
- Write the RMA number down, so that you can easily check on status of the returned equipment.

Send all material with the issued RMA Number to:

Federal Signal Corporation
2645 Federal Signal Drive
University Park, IL 60484-3167
Attn: Service Department
RMA: # _____

SpectraLux[™] is a Trademark of Federal Signal Corporation.
Dodge is a registered trademarks of FCA US LLC.