

⚠ WARNING**Safety Messages for Installers of Warning Light Equipment**

- Do not install equipment or route wiring in the deployment path of an airbag. Failure to observe this warning will reduce the effectiveness of the airbag or potential dislodge the equipment, causing serious injury or death.
- If a vehicle seat is temporarily removed, verify with the vehicle manufacturer if the seat needs to be recalibrated for proper airbag deployment. Failure to observe this warning may cause serious injury or death.
- This product contains high intensity LED devices. To prevent permanent eye damage, **DO NOT** stare into the light beam at close range.
- Before drilling holes, check the area into which you plan to drill to ensure you do not damage vehicle components. All drilled holes should be deburred and all sharp edges should be smoothed. All wires going through drilled holes should be protected by a grommet or convolute/split-loom tubing.

Mounting the Light

For your bracket type, see Figures 1 through 4. To mount the light:

1. Use the bracket as a template to mark the centers of the mounting holes and the wire-routing hole on the mounting surface.
2. Drill a 0.50" hole at the mark for the wire-routing hole.
3. Drill a 0.104" hole at the two mounting-hole marks.
4. Route the wires through the bracket(s). Secure the lighthead(s) to the bracket with the supplied hardware.
5. If using the swivel bracket, attach the lighthead/bracket assembly to the swivel bracket.
6. Secure the bracket to the mounting surface with the two #6 Phillips screws.

Figure 1 Single-head bracket

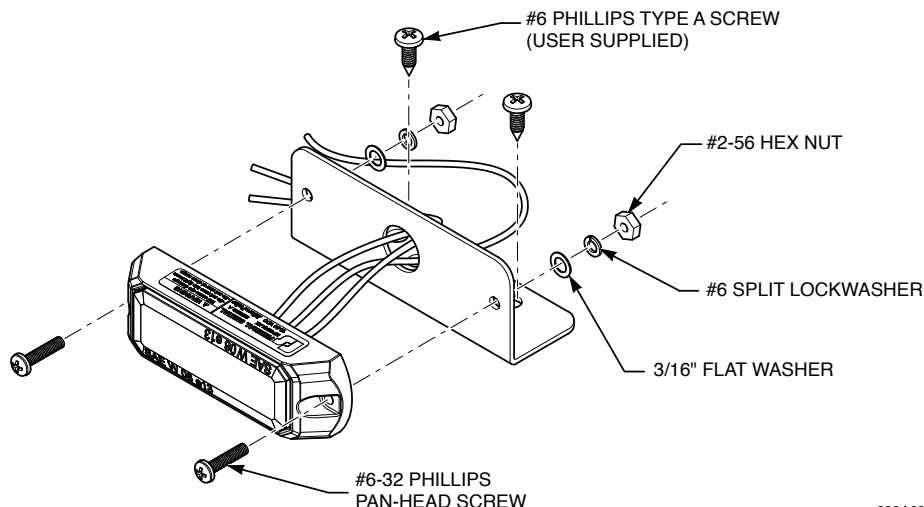

290A6955B

Mounting Bracket Installation Instructions

Figure 2 Vertical dual-head bracket

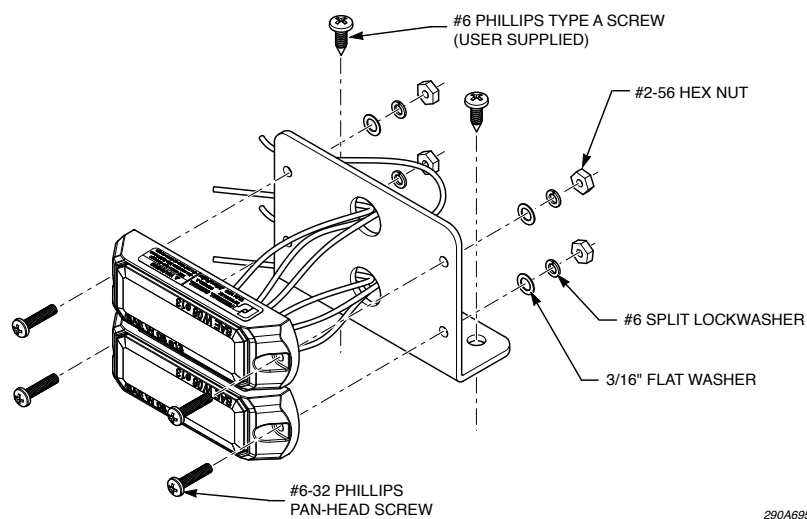

Figure 3 Horizontal dual-head bracket

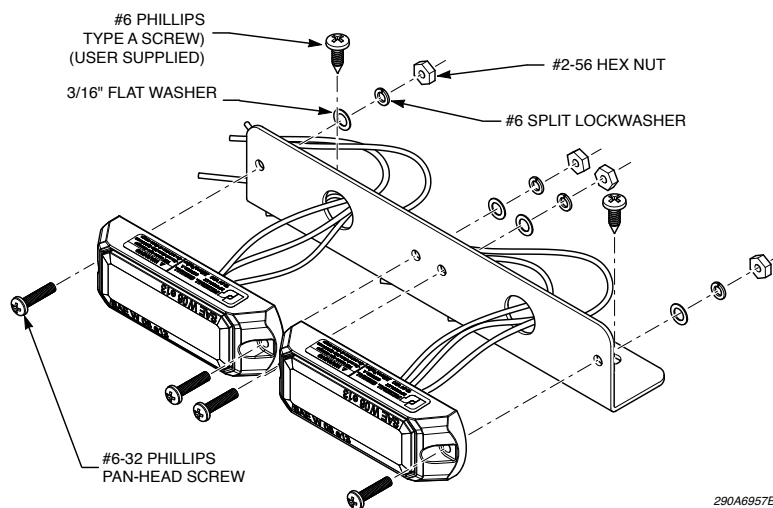

Figure 4 Swivel bracket

