

2562479B Rev. B2 0617

## Safety Message to Installers and Users of Warning Light Equipment

### **WARNING**

People's lives depend on your proper installation and servicing of Federal Signal products. It is important to read and follow all instructions shipped with this product and the original product. In addition, listed below are some other important safety instructions and precautions you should follow:

- To properly install the lighting system, you must have a good understanding of automotive systems, along with proficiency in the installation and use of safety warning equipment.
- When drilling into a vehicle structure, be sure that both sides of the surface are clear of anything that could be damaged.
- If a vehicle seat is temporarily removed, verify with the vehicle manufacturer if the seat needs to be recalibrated for proper airbag deployment.
- The effectiveness of an interior mounted warning light depends on the clarity, the tinting, and the angle of the glass it is being placed behind. Tinting, dirt defects, and steeply angled glass reduce the light output of the warning light. This may reduce the effectiveness of the light as a warning signal. If your vehicle has dirty, tinted, or steeply angled glass, use extra caution when driving your vehicle or blocking the right of way with your vehicle.
- You should frequently inspect the light system to ensure that it is operating properly and that it is securely attached to the vehicle.
- Refer to the instructions packed with related products for additional precautions and information.
- File these instructions in a safe place and refer to them when maintaining or reinstalling the product.

Failure to follow all safety precautions and instructions may result in property damage, serious injury, or death.

## Introduction

The ILSFDVHL-CH08 is a mounting system used to mount the ILS lightbar in the rear deck of the 2008 Dodge Charger. The mounting system consists of an aluminum shroud and base that are powder coated. All needed hardware is included in this kit. The kit is a configured option for use with Federal Signal's Full Deck ILS lightbar.

## Unpacking the Kit

After unpacking the kit, inspect it for damage that may have occurred in transit. If it has been damaged, do not attempt to install or operate it. File a claim immediately with the carrier, stating the extent of damage. Carefully check all envelopes, shipping labels, and tags before removing or destroying them. Ensure that the parts listed in *Table 1* are included in the package.

Table 1: Kit contents

| Qty. | Description                                                                                 | Part No.                                          |
|------|---------------------------------------------------------------------------------------------|---------------------------------------------------|
| 1    | ILS System, Full Front, includes:<br>Power Harness<br>Cable, RS485<br>Cable, Board-To-Board | ILSFF-#####<br>1461816<br>1751357-02<br>1461812-5 |
| 1    | Shroud                                                                                      | 8624197                                           |
| 1    | Base                                                                                        | 8624202                                           |
| 4    | Screw, Pan Hd. 1/4"-20 x 0.50"                                                              | 7000547-08                                        |
| 4    | Lockwasher, Ext Tooth, 1/4"                                                                 | 7075078                                           |
| 2    | Strip, Sealing, Extruded Rubber                                                             | 8624206-54                                        |
| 2    | Bolt, Carriage, 1/4"-20                                                                     | 7004031-26                                        |
| 2    | Nut, El Stop, 1/4"-20                                                                       | 7058A009                                          |
| 2    | Washer, Flat, 1/4" x 1"                                                                     | 7072A026                                          |

## Installing the Mounting System

### ⚠ WARNING

#### AIRBAG DEPLOYMENT

**Do not install equipment or route wiring in the deployment of an airbag. Failure to observe this warning will reduce the effectiveness of the airbag or potentially dislodge the equipment, causing serious injury to you or others.**

1. Install the extruded-rubber sealing strip (cut to fit) on the edges of the shroud that contacts the rear window (*Figure 2* on page 4).
2. Attach the shroud to the base plate using the supplied 1/4"-20 pan head screws; finger tighten only (*Figure 1*). Place the light assembly centered on the rear deck against the rear window.

Figure 1: Installation of ILS Mounting System on Rear Deck

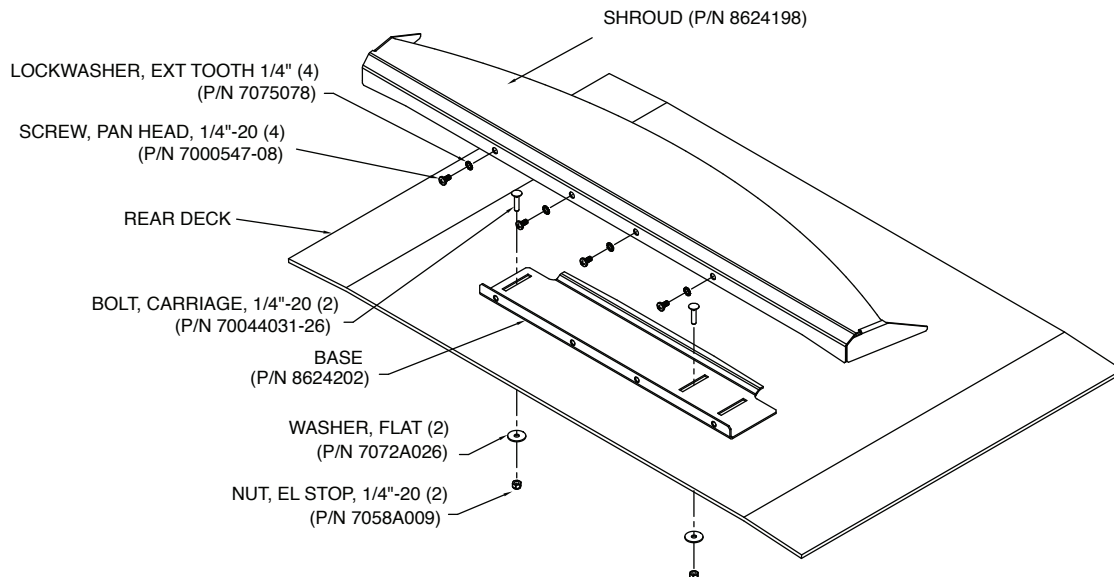

3. Without disturbing the light assembly, remove the pan head screws and shroud.
4. Using the base as a template, mark two hole mounting locations. If needed, mark a hole for the serial cable and power harness.

|               |
|---------------|
| <b>NOTICE</b> |
|---------------|

**DRILLING PRECAUTIONS**

**Before drilling holes, check the area into which you plan to drill to ensure you do not damage vehicle components while drilling. All drilled holes should be deburred and all sharp edges should be smoothed. All wires going through drilled holes should be protected by a grommet or convolute/split-loom tubing.**

5. Drill a 3/8" hole in the rear deck at each mark.
6. Secure the base plate to the rear deck using the supplied hardware.
7. Attached the shroud to the base plate using the 1/4"-20 pan head screws and external tooth lockwashers. Route the supplied power harness to a sufficient power source using the supplied fuse kit. Route the RS485 cable to the serial controller. For further instructions, refer to document Part Number 2562422.
8. Test the warning system for proper operation

## **Getting Technical Support and Service**

For technical support and service, please contact:

Service Department  
Federal Signal Corporation  
Phone: 1-800-433-9132  
Fax: 1-800-343-9706  
Email: [empserviceinfo@fedsig.com](mailto:empserviceinfo@fedsig.com)

Figure 2: Location of replacement parts and their part numbers

