

## Reset Keyway Installation Kit Instructions for Call Points

### Safety Messages to Installers

It is important to follow all instructions shipped with this product. This Call Point station and its options are to be installed by a trained electrician who is thoroughly familiar with and will follow all applicable national and local codes in the country of use. This Call Point station should be considered a part of the warning system and not the entire warning system. The selection of the mounting location for the Call Point station, its controls and the routing of the wiring are to be accomplished under the direction of the facilities engineer and the safety engineer. In addition, listed below are some other important safety instructions and precautions you should follow:

- Read and understand all instructions before installing and operating this equipment.
- To avoid electrical shock hazards, do not connect wires when power is applied. Failure to observe this warning may lead to serious injury or death.
- Never alter the unit in any manner. Safety in hazardous locations may be endangered if additional openings or other alterations are made in units specifically designed for use in these locations.
- Do not connect this station to the system or modify it when power is on.
- After installation, ensure that all threaded joints are properly tightened.
- Keep the unit tightly closed when in operation.
- After installation, test the station and the system to ensure that it is operating properly with the option installed.
- After testing is complete, provide a copy of this instruction sheet to all personnel.
- Establish a procedure to routinely check the station and system for proper activation and operation.

**Failure to follow all safety precautions and instructions may result in property damage, serious injury, or death.**

### Installing the Reset Keyway

Five (5) reset keyways and bearing washers are provided in this kit to attach to Federal Signal CP-PB (Push Button) or CP-BG (Break Glass) stations. The reset keyway is provided factory attached on the CP-PB & CP-BG stations. On the CP-BG-x-x-x-xxx-xx-2 E54-11 approved stations it is only be used as a discrete standalone key, not to remain attached to the station. The reset keyway's purpose is twofold:

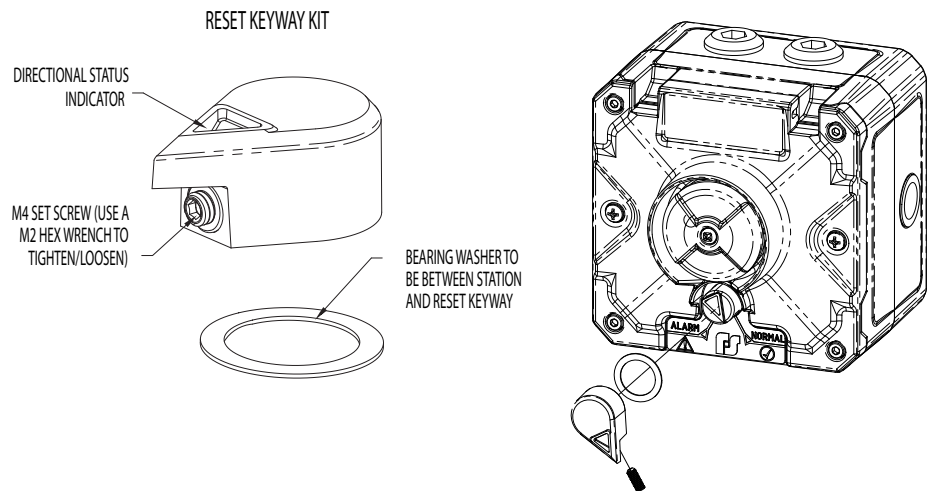

1. Provide a means of resetting all devices after an activated ALARM status, by a 60° counter-clockwise rotation of the activation indicator. Break glass stations additionally would need a new glass panel installed if broken.
2. Provide a means of ALARM activation testing of the CP-BG stations without breaking the glass panel.

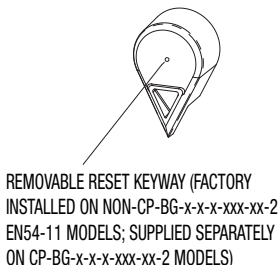

Removal/attachment of the reset keyway is easily done by use of a M2 hex wrench mated to the M4 set screw below the triangular directional status indicator. The set screw need not be fully removed from the keyway, only loosen partially enough to lift the keyway and bearing washer below it from the unit's status indicator. The reset keyway and washer may remain attached to the station (non EN54-11), or be a discrete separate key used by authorized personnel.

**NOTE:** if the reset keyway remains installed on the activation indicator of the station, the action remains the same, with a larger indicator showing the station's status. BUT the possibility of access to resetting the station is evident to those reasonably knowledgeable of its operation that are nearby, which may result in false signals being sent to the indicating control panel. Failure to observe this warning may lead to property damage, serious injury or death.

## Technical Support and Service

For additional information regarding the Federal Signal line of Manual Call Points Stations, refer to the station's Installation & Maintenance Instructions manual #25500424A.

The Federal Signal factory provides technical assistance with any problems that cannot be handled locally. Any units returned to Federal Signal for service, inspection, or repair must be accompanied by a Return Material Authorization (RMA). Obtain a RMA from a local Distributor or Manufacturer's Representative. Please provide a brief explanation of the service requested, or the nature of the malfunction.

Technical Support Tel: 1-800-755-7621 | +1 708-587-3587

To order additional parts, contact Customer Support: +1 708-534-4756

Email: [signalsupport@fedsig.com](mailto:signalsupport@fedsig.com)

## Limited Warranty

This product is subject to and covered by a limited warranty, a copy of which can be found at [www.fedsig.com/SSG-Warranty](http://www.fedsig.com/SSG-Warranty). A copy of this limited warranty can also be obtained by written request to Federal Signal Corporation, 2645 Federal Signal Drive, University Park, IL 60484, email to [signalsupport@fedsig.com](mailto:signalsupport@fedsig.com) or call +1 708-534-4756.

This limited warranty is in lieu of all other warranties, express or implied, contractual or statutory, including, but not limited to the warranty of merchantability, warranty of fitness for a particular purpose and any warranty against failure of its essential purpose.



**FEDERAL SIGNAL**  
Safety and Security Systems

### Signaling Devices

2645 Federal Signal Drive

University Park, IL 60484-3167

Tel: 708-534-4756

Tech Support Tel: 708-587-3587

Email: [signalsupport@fedsig.com](mailto:signalsupport@fedsig.com)

[www.fedsig.com](http://www.fedsig.com)