

Cover Flap Option Installation Kit Instructions for Models CP-PB and CP-BG

Safety Messages to Installers

It is important to follow all instructions shipped with this product. This Call Point station and its options are to be installed by a trained electrician who is thoroughly familiar with and will follow all applicable national and local codes in the country of use. This Call Point station should be considered a part of the warning system and not the entire warning system. The selection of the mounting location for the Call Point station, its controls and the routing of the wiring are to be accomplished under the direction of the facilities engineer and the safety engineer. In addition, listed below are some other important safety instructions and precautions you should follow:

- Read and understand all instructions before installing and operating this equipment.
- To avoid electrical shock hazards, do not connect wires when power is applied. Failure to observe this warning may lead to serious injury or death.
- Never alter the unit in any manner. Safety in hazardous locations may be endangered if additional openings or other alterations are made in units specifically designed for use in these locations.
- Do not connect this station to the system or modify it when power is on.
- After installation, ensure that all threaded joints are properly tightened.
- Keep the unit tightly closed when in operation.
- After installation, test the station and the system to ensure that it is operating properly with the option installed.
- After testing is complete, provide a copy of this instruction sheet to all personnel.
- Establish a procedure to routinely check the station and system for proper activation and operation.

Failure to follow all safety precautions and instructions may result in property damage, serious injury, or death.

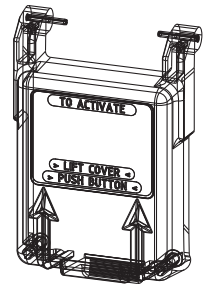

Installing the Optional Cover Flap

An optional clear polycarbonate cover flap is provided in this kit to attach to either the CP-PB (Push Button) & CP-BG (Break Glass) stations. The cover flap kit may also be provided with a clear instructional label attached (**ex: “in case of fire lift cover break glass”, “in case of fire lift cover push button”, “to activate lift cover break glass”, & “to activate lift cover push button”**).

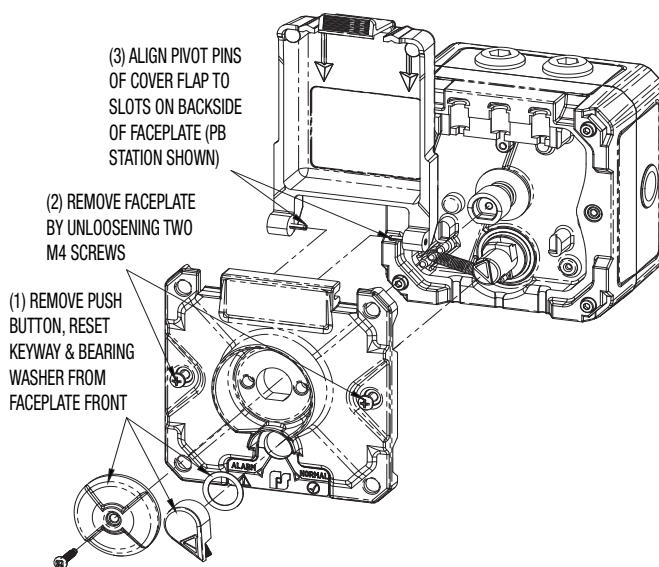

Figure 32

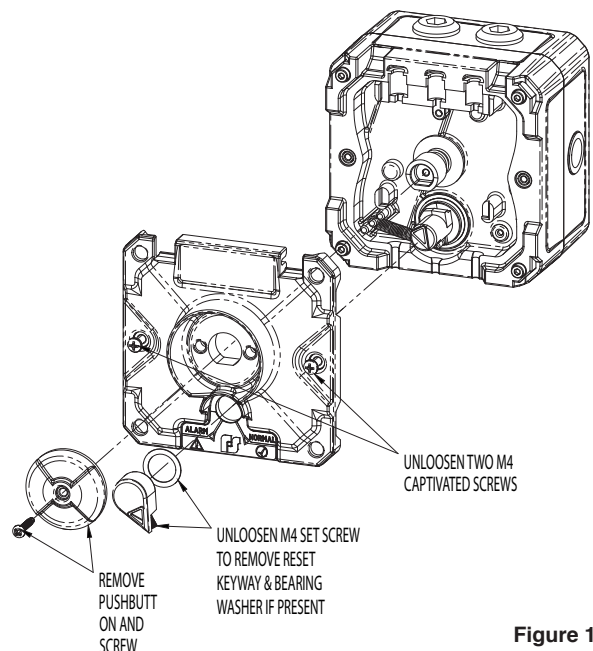
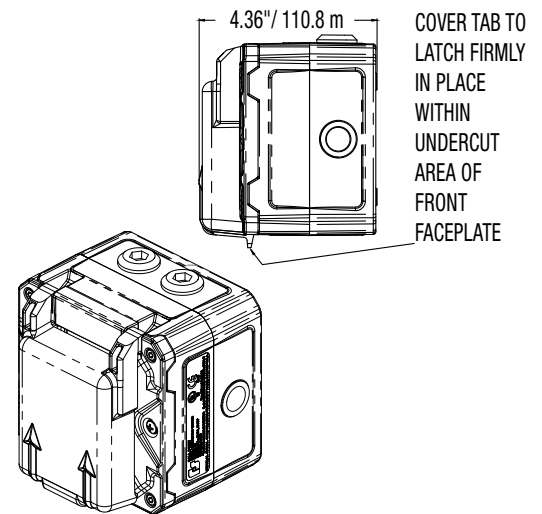

Figure 1

To remove, or remove/reattach a cover flap:

1. Remove the front faceplate by first removing the reset keyway and bearing washer (unloosening the M4 set screw) if present on either the BG or PB stations. If the station is a PB model, also remove the push button by removing the #6 Phillips head screw. On both stations, loosen the two M4 Phillips head screws holding the front faceplate to the front housing. Remove the faceplate.
2. Place the two stainless steel pivot pins of the cover flap within the slot(s) found on the backside of the faceplate and rotate the cover 180° to snap the cover flap onto the front face.
3. Re-attach the faceplate by tightening the two M4 Phillips head screws (15 in*lbs max. torque), and then open the cover flap to reattach the push button and the reset keyway if they were provided with the station.
4. Insure access to the activation push button or glass panel is easily accomplished by lifting the cover flap upwards. Apply power to the station to confirm the system is fully functional after the option is installed.



Technical Support and Service

For additional information regarding the Federal Signal line of Manual Call Points Stations, refer to the station's Installation & Maintenance Instructions manual #25500424A.

The Federal Signal factory provides technical assistance with any problems that cannot be handled locally. Any units returned to Federal Signal for service, inspection, or repair must be accompanied by a Return Material Authorization (RMA). Obtain a RMA from a local Distributor or Manufacturer's Representative. Please provide a brief explanation of the service requested, or the nature of the malfunction.

Technical Support Tel: 1-800-755-7621 | +1 708-587-3587

To order additional parts, contact Customer Support: +1 708-534-4756

Email: signalsupport@fedsig.com

Limited Warranty

This product is subject to and covered by a limited warranty, a copy of which can be found at www.fedsig.com/SSG-Warranty. A copy of this limited warranty can also be obtained by written request to Federal Signal Corporation, 2645 Federal Signal Drive, University Park, IL 60484, email to signalsupport@fedsig.com or call +1 708-534-4756.

This limited warranty is in lieu of all other warranties, express or implied, contractual or statutory, including, but not limited to the warranty of merchantability, warranty of fitness for a particular purpose and any warranty against failure of its essential purpose.



Signaling Devices

2645 Federal Signal Drive
University Park, IL 60484-3167
Tel: 708-534-4756
Tech Support Tel: 708-587-3587
Email: signalsupport@fedsig.com
www.fedsig.com