



FEDERAL SIGNAL
Safety and Security Systems

Model XSMBKT02 Mounting Kit for the XStream™ Lights

Installation Instructions

Limited Warranty

This product is subject to and covered by a limited warranty, a copy of which can be found at www.fedsig.com/SSG-Warranty. A copy of this limited warranty can also be obtained by written request to Federal Signal Corporation, 2645 Federal Signal Drive, University Park, IL 60484, email to info@fedsig.com or call +1 708-534-3400.

This limited warranty is in lieu of all other warranties, express or implied, contractual or statutory, including, but not limited to the warranty of merchantability, warranty of fitness for a particular purpose and any warranty against failure of its essential purpose.



FEDERAL SIGNAL
Safety and Security Systems

2645 Federal Signal Drive
University Park, Illinois 60484-3167

www.fedsig.com

Customer Support

Police/Fire-EMS: 800-264-3578 • +1 708 534-3400

Work Truck: 800-824-0254 • +1 708 534-3400

Technical Support 800-433-9132 • +1 708 534-3400

Contents

| | |
|--|----------|
| Safety Messages to Installers of Warning Lights | 5 |
| Introduction | 5 |
| Unpacking the Kit | 6 |
| Installing the Brackets | 6 |
| Getting Technical Support and Service | 8 |

Tables

| | |
|----------------------------------|----------|
| Table 1 Kit Contents..... | 6 |
|----------------------------------|----------|

Figures

| | |
|---|----------|
| Figure 1 Lightheads with mounting bracket..... | 8 |
|---|----------|

Safety Messages to Installers of Warning Lights

⚠ WARNING

People's lives depend on your safe installation of our products. It is important to read, understand and follow all instructions shipped with the products. In addition, listed below are some other important safety instructions and precautions you should follow:

- To properly install this light, you must have a good understanding of automotive electrical procedures and systems along with proficiency in the installation and use of safety warning equipment.
- DO NOT install equipment or route wiring in the deployment path of an airbag.
- If a vehicle seat is temporarily removed, verify with the vehicle manufacturer if the seat needs to be recalibrated for proper airbag deployment.
- You should frequently inspect the light to ensure that it is operating properly and that it is securely attached to the vehicle.
- When drilling into a vehicle structure, be sure that both sides of the surface are clear of anything that could be damaged.
- Refer to the instructions packed with related products for additional precautions and information.
- File these instructions in a safe place and refer to them when maintaining and/or reinstalling the product.
- Do not stare directly into the lights at a close range or permanent damage to your eyesight may occur.

Failure to follow all safety precautions and instructions may result in property damage, serious injury, or death.

Introduction

This publication has instructions for using the XSMBKT02 Adjustable Swivel Mount to mount single- and dual-head XStream models.

Installation Instructions

NOTE: For electrical installation instructions, refer to the Installation and Maintenance Instructions packed with the lighthouse.

Unpacking the Kit

After unpacking the kit, inspect it for damage that may have occurred in transit. If it has been damaged, do not attempt to install or operate it. File a claim immediately with the carrier, stating the extent of damage. Carefully check all envelopes, shipping labels, and tags before removing or destroying them. Ensure that the parts in the Kit Contents List are included in the package. If you are missing any parts, contact Customer Support at 1-800-264-3578, 7 a.m. to 5 p.m., Monday through Friday (CT).

Table 1 Kit Contents

| Qty. | Description | Part Number |
|------|--|-------------|
| 4 | Screw, #10 Type B, Pan-Head, Torx, Steel | 7011246-08 |
| 2 | Screw, #8, 48-2 Plastite Equivalent, No. 6 L | 70000705-05 |
| 2 | Bracket, Side Mount | 861301916 |
| 2 | Bracket Assy., Side-Mount Attachment | 861301917 |
| 2 | Nut, Machine Screw Hex, KEPS #10-32 S.S. | 7058A047 |
| 2 | Washer, Internal Tooth, #10, 0.70/0.381 OD, 0.022 in Thick, Steel, Zinc Chromate | 7075014 |

Installing the Brackets

⚠ WARNING

AIRBAG DEPLOYMENT: Do not install equipment or route wiring in the deployment path of an airbag. Failure to observe this warning will reduce the effectiveness of the airbag or potentially dislodge the equipment, causing serious injury or death.

NOTE: Plan all cable routing before the installation.

NOTICE

DRILLING PRECAUTIONS: When drilling holes, check the area you are drilling into to be sure you do not damage vehicle components. All drilled holes should be deburred and all sharp edges should be smoothed. All wire routings going through drilled holes should be protected by a grommet or convolute/split loom tubing.

NOTICE

THREAD DAMAGE AND GALLING: *To prevent thread damage and galling, anti-seize lubricant must be used on all stainless steel fasteners.*

To install the brackets:

1. See Figure 1 on page 8. Attach the side-mount bracket assembly to XStream light module using the two supplied #8 screws. Do not overtighten the screws.
2. Loosely assemble the two side-mount brackets to the two side-mount attachment bracket assemblies using the two supplied internal-tooth lockwashers and KEPS nuts. Do not overtighten the nuts.
3. Position the assembly in the desired location and mark the four mounting holes.
4. Drill four 0.159 in holes (#21 drill).
5. Install the XStream light fixture into desired vehicle location using the four supplied #10 pan-head screws.
6. Adjust lighthead to desired angle and tighten the two nuts. Do not overtighten.
7. Complete the wiring according to the instructions supplied with the lighthead.

⚠ WARNING

LIGHT HAZARD: *To be an effective warning device, an emergency warning system produces bright light that can be hazardous to your eyesight when viewed at a close range. Do not stare directly into the lights at a close range or permanent damage to your eyesight may occur.*

8. Test the lights for proper operation.

Installation Instructions

Figure 1 Exploded view of lighthouse with mounting brackets

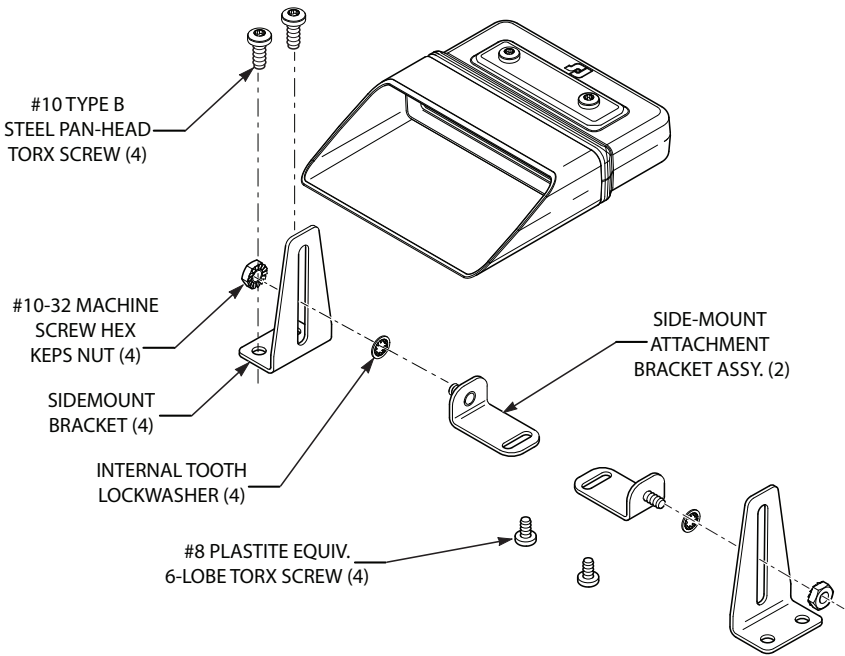

Getting Technical Support and Service

The Federal Signal factory provides technical assistance with any problems that cannot be handled locally. Any units returned to Federal Signal for service, inspection, or repair must be accompanied by a Return Material Authorization (RMA). Obtain a RMA from a local Distributor or Manufacturer's Representative. Please provide a brief explanation of the service requested, or the nature of the malfunction.

For technical support and service, visit:

<https://www.fedsig.com/technical-support>

<https://www.fedsig.com/service-centers>