

2562656A Rev A3 617

## Safety Message to Installers and Users of Warning Lights

### **⚠ WARNING**

People's lives depend on your proper installation and servicing of Federal Signal products. It is important to read and follow all instructions shipped with this product and the original product. In addition, listed below are some other important safety instructions and precautions you should follow:

- To properly install the lighting system, you must have a good understanding of automotive systems, along with proficiency in the installation and use of safety warning equipment.
- Do not install equipment or route wiring in the deployment path of an airbag.
- The effectiveness of an interior mounted warning light depends on the clarity, the tinting, and the angle of the glass it is being placed behind. Tinting, dirt defects, and steeply angled glass reduce the light output of the warning light. This may reduce the effectiveness of the light as a warning signal. If your vehicle has dirty, tinted, or steeply angled glass, use extra caution when driving your vehicle or blocking the right of way with your vehicle.
- If a vehicle seat is temporarily removed, verify with the vehicle manufacturer if the seat needs to be recalibrated for proper airbag deployment.
- Do not stare into the lights at close range or permanent damage to your eyesight may occur,
- You should frequently inspect the light system to ensure that it is operating properly and that it is securely attached to the vehicle.
- When drilling into a vehicle structure, be sure that both sides of the surface are clear of anything that could be damaged.
- Refer to the instructions packed with related products for additional precautions and information.
- File these instructions in a safe place and refer to them when maintaining and/or reinstalling the product.

Failure to follow all safety precautions and instructions may result in property damage, serious injury, or death.

## Introduction

The ILSFDVHL-CH11 is a mounting system used to mount the ILS lightbar in the rear deck of the 2011 Dodge Charger. The mounting system consists of an aluminum shroud and base that are powder coated. All needed hardware is included in this kit. The kit is a configured option for use with the Federal Signal Full Deck ILS lightbar.

## Unpacking the Kit

After unpacking the kit, inspect it for damage that may have occurred in transit. If it has been damaged, do not attempt to install or operate it. File a claim immediately with the carrier, stating the extent of damage. Carefully check all envelopes, shipping labels, and tags before removing or destroying them. Ensure that the parts listed in Table 1 on page 2 are included in the package.

**Table 1** Kit contents

Qty.	Description	Part No.	Qty.	Description	Part No.
1	ILS System, Full Deck, includes: Power Harness Cable, RS485 Cable, Board-To-Board	ILSFD-##### 1461816 1751357-02 1461812-5	1	Strip, Sealing, Extruded Rubber	8624206-54
1	Shroud, CH11	8624285	2	Bolt, Carriage, 1/4"-20	7004031-26
1	Base, ILSFD, CH08, IM08, CH11	8624195	2	Nut, Elastic Stop	7058A009
4	Screw, Pan Hd. 1/4"-20 x 0.50"	7000547-08	2	Washer, Flat, 1/4" x 1"	7072A026
4	Lockwasher, Ext. Tooth, 1/4"	7075078	2	Bolt, Retainer, 1/4"	8567059
	Nut, Self-Clenching, 1/4"-20	7056A012	4		

## Mounting the ILS in the Vehicle

### **⚠ WARNING**

**AIRBAG DEPLOYMENT:** Do not install equipment or route wiring in the deployment of an airbag. Failure to observe this warning will reduce the effectiveness of the airbag or potentially dislodge the equipment, causing serious injury or death.

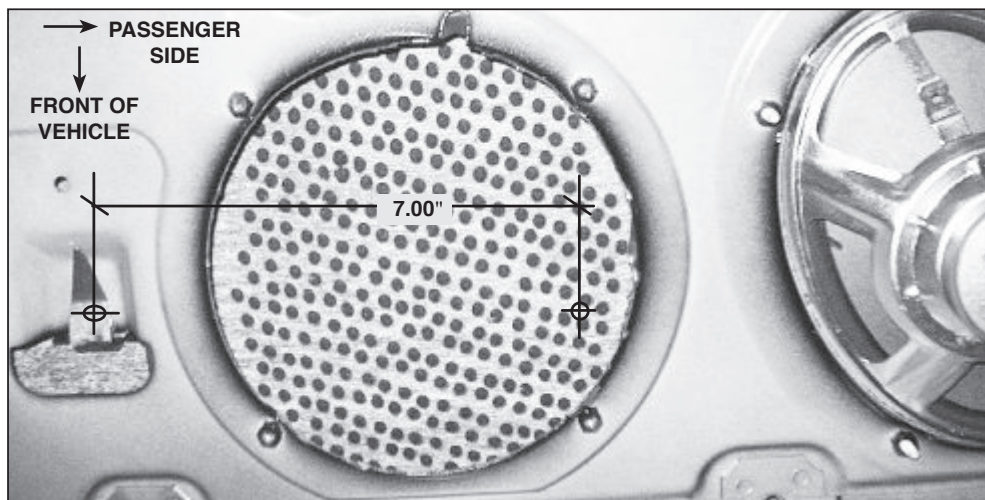
### **NOTICE**

**DRILLING PRECAUTIONS:** Before drilling holes, check the area into which you plan to drill to ensure you do not damage vehicle components. All drilled holes should be de-burred and all sharp edges should be smoothed. All wires going through drilled holes should be protected by a grommet or convolute/split-loom tubing.

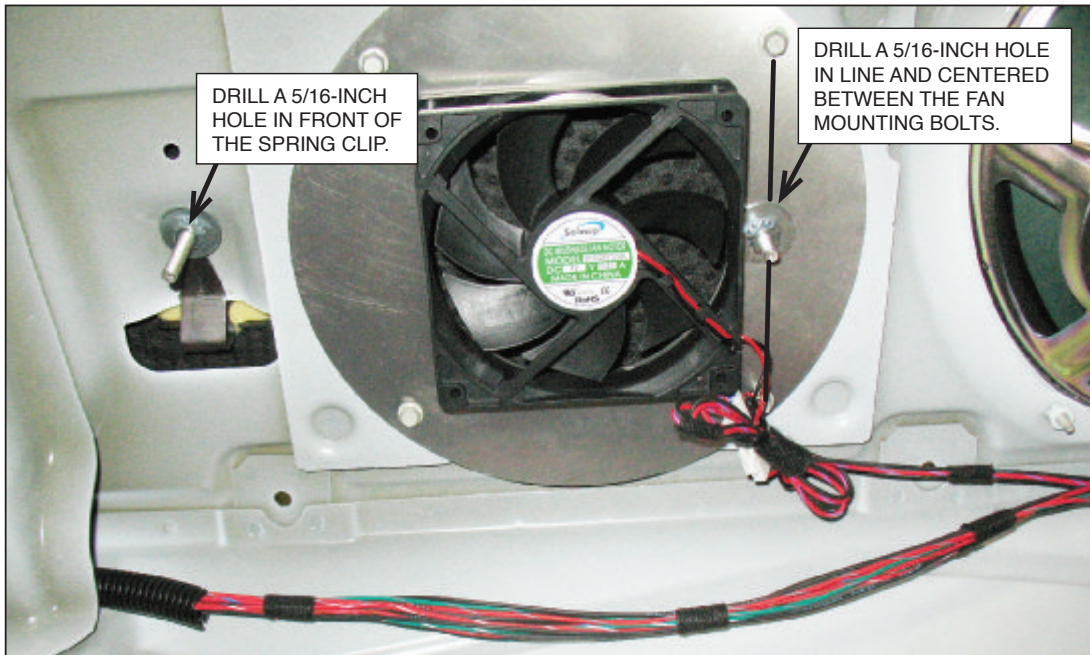
To install the ILS lightbar in the rear deck:

1. Install the extruded-rubber sealing strip on the edges of the shroud that contact the rear window (Figure 3 on page 4).
2. Locate the center clip on the underside of the package tray where noted in Figure 1. Drill a 5/16" hole where noted in Figure 1 or Figure 2.
3. From the center hole measure 7.00" to the passenger side of the vehicle. Mark and drill a 5/16" hole.

**Figure 1** Location of drilled holes in underside of package tray 2011-2015

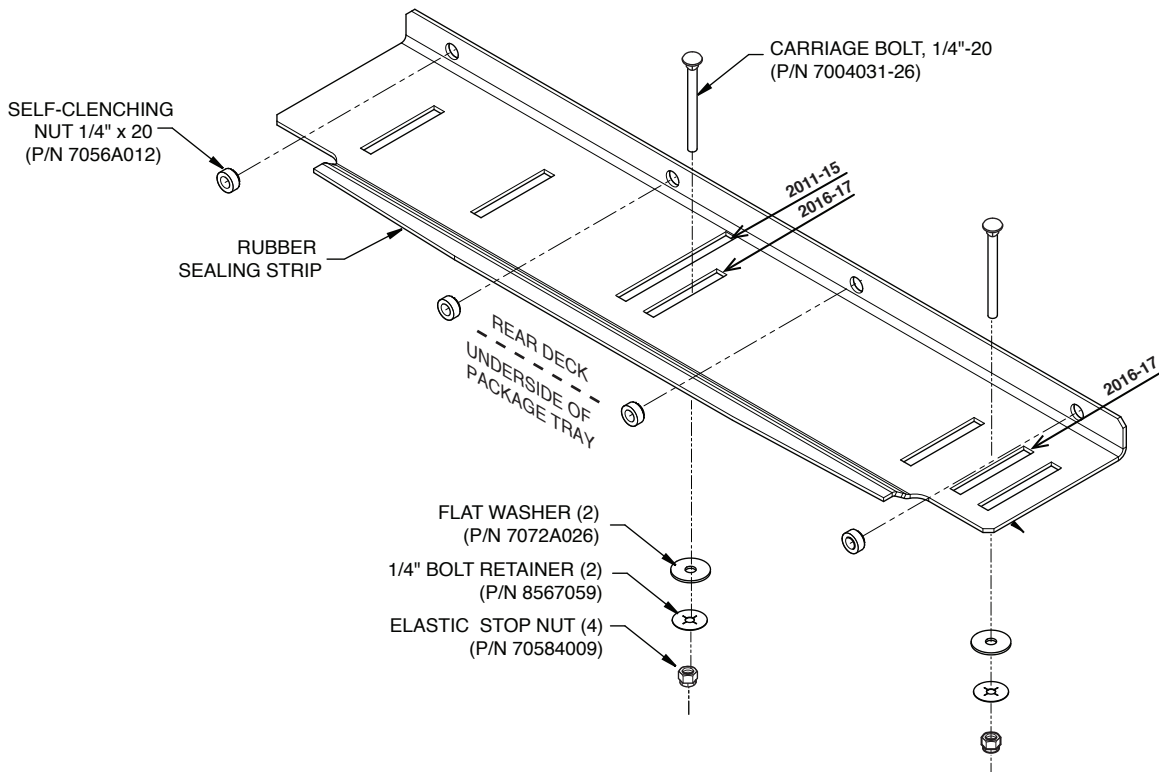


**Figure 2** Location of drilled holes in underside of package tray 2016-2017



4. Loosely secure the baseplate to the rear deck using the 1/4"-20 carriage bolts, flat washers, and 1/4"-20 elastic stop nuts (Figure 3).
5. Route the power and ground wires from a sufficient power source to the ILS using the supplied fuse kit.
6. Route the RS485 cable from the serial controller to the ILS. For instructions, refer to document P/N 2562422.

**Figure 3** Hardware securing baseplate to rear deck



7. Attach the shroud to the baseplate using 1/4"-20 pan-head screws and external-tooth lockwashers.
8. Slide the ILS so that it is tight against the rear window, and tighten the hardware securing the baseplate from inside the trunk.

## Getting Technical Support and Service

Federal Signal Corporation will service your equipment or provide technical assistance with any problems that cannot be handled locally. Any product returned to Federal Signal for service, inspection, or repair must be accompanied by a Return Material Authorization number. The RMA number can be obtained from your local distributor or Federal Signal. Please provide a brief explanation of the service requested or the nature of the malfunction. For replacement parts, contact your local dealer/distributor or contact the Federal Signal Service Department 7 a.m. to 5 p.m. Monday through Friday, Central Time) at: 800-433-9132, 800-343-9706 (fax) <http://www.fedsig.com/support/service>

**Figure 3** Replacement parts with part numbers

