

25500359 Rev. A0 0916

## Safety Message to Installers of Warning Light Equipment

### **⚠ WARNING**

People's lives depend on your proper installation and servicing of Federal Signal products. It is important to read and follow all instructions shipped with this product and the original product. In addition, listed below are some other important safety instructions and precautions you should follow:

- To properly install an electronic siren, you must have a good understanding of automotive electrical procedures and systems, along with proficiency in the installation and service of safety warning equipment. Always refer to the vehicle service manuals when installing equipment on a vehicle.
- Do not install equipment or route wiring in the deployment path of an airbag.
- If a vehicle seat is temporarily removed, verify with the vehicle manufacturer if the seat needs to be recalibrated for proper airbag deployment.
- When drilling into a vehicle structure, be sure that both sides of the surface are clear of anything that could be damaged.

DO NOT get metal shavings inside the siren. Metal shavings can cause the system to fail. If drilling must be done near the siren, place an ESD-approved cover over the siren to prevent metal shavings from entering it. Inspect the siren after mounting to be sure there are no shavings present in or near it.

- You should frequently inspect the siren system to ensure that it is operating properly and that it is securely attached to the vehicle.
- Refer to the instructions packed with the siren for additional precautions and information.
- File these instructions in a safe place and refer to them when maintaining and/or reinstalling the siren.

Failure to follow all safety precautions and instructions may result in property damage, serious injury, or death.

## Introduction

This publication has instructions for using the ESB-FPIUND Mounting Bracket Kit to mount the DynaMax ES100C siren through the existing holes in grille of the Ford® Police Interceptor Utility.

## Unpacking the Kit

After unpacking the kit, inspect it for damage that may have occurred in transit. If it has been damaged, do not attempt to install or operate it. File a claim immediately with the carrier, stating the extent of damage. Carefully check all envelopes, shipping labels, and tags before removing or destroying them. Ensure that the parts in the KIT CONTENTS LIST are included in the package. Disposal of all shipping materials must be carried out in accordance with national and local codes and standards. If you are missing any parts, contact Customer Support at 1-800-264-3578, 7 a.m. to 5 p.m., Monday through Friday (CT).

**Table 1** Kit contents

| <b>Part No.</b> | <b>Description</b>                                      | <b>Qty.</b> |
|-----------------|---|-------------|
| 856701644       | Bracket, ES100, Explorer                                | 1           |
| 7002A005-20     | Screw, Machine, 5/16"-18, Hex Head, S.S., 1.25"         | 2           |
| 700A005-14      | Screw, Machine, 5/16"-18, Hex Head, S.S., 7/8"          | 2           |
| 70574A020       | Washer, Split, 5/16", 0.586 Outer Diameter, Thick, S.S. | 4           |
| 7057A027        | Nut, Double Champfer, 5/16"-18, S.S.                    | 2           |

## Installing the Brackets

### **⚠ WARNING**

**AIRBAG DEPLOYMENT:** Do not install equipment or route wiring in the deployment path of an airbag. Failure to observe this warning will reduce the effectiveness of the airbag or potentially dislodge the equipment, causing serious injury or death.

### **NOTICE**

**THREAD DAMAGE AND GALLING:** To prevent thread damage and galling, anti-seize lubricant must be used on all stainless steel fasteners.

### **NOTICE**

**DRILLING PRECAUTION:** When drilling holes, check the area you are drilling into to be sure you do not damage vehicle components. All drilled holes should be deburred and all sharp edges should be smoothed. All wire routings going through drilled holes should be protected by a grommet or convolute/split loom tubing.

**IMPORTANT:** Plan all cable routing before the installation.

1. To access the area behind the grille, remove the fascia according to the manufacturer's service manual.

### **⚠ WARNING**

**ES100C SERIES SPEAKER WIRES:** To avoid reducing the sound output and damaging the speaker, ensure that the speaker is mounted with the wires protruding from the bottom of the speaker.

### **⚠ WARNING**

**SOUND REDUCTION WARNING:** To avoid reduction of sound output, ensure that the speaker is mounted with the sound opening facing directly in the direction intended to warn.

2. See Figures 1 and 2 on the following pages. Mount the speaker to the bracket with the 5/16", 7/8"-long bolt and lockwasher included with the speaker.
3. Secure the bracket and speaker assembly through the existing holes along the top of the grill.
4. Complete the installation according to the instructions provided with the speaker.

**Figure 1** Back of bumper with ES100 speaker

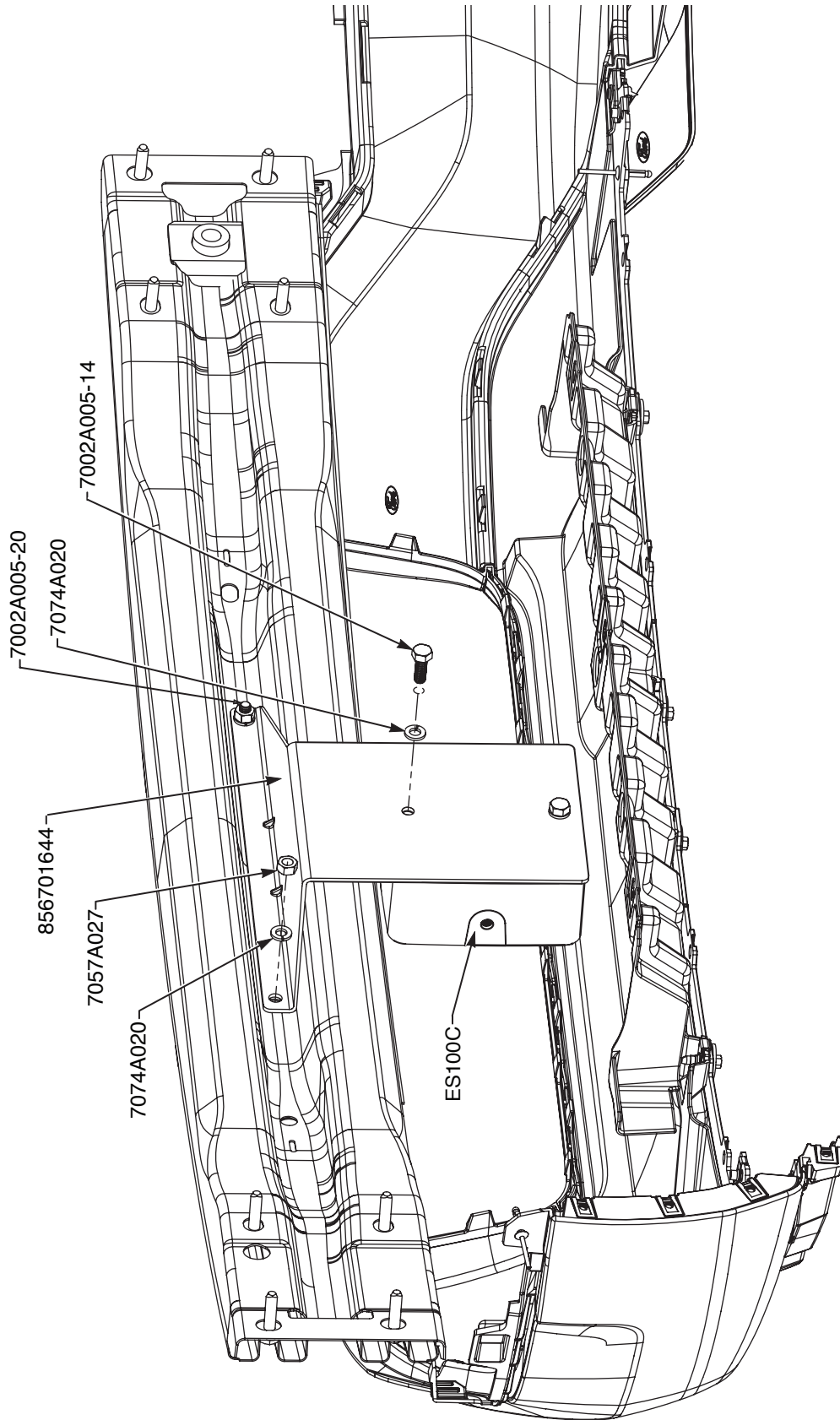

**Figure 2** Front of bumper with ES100 speaker

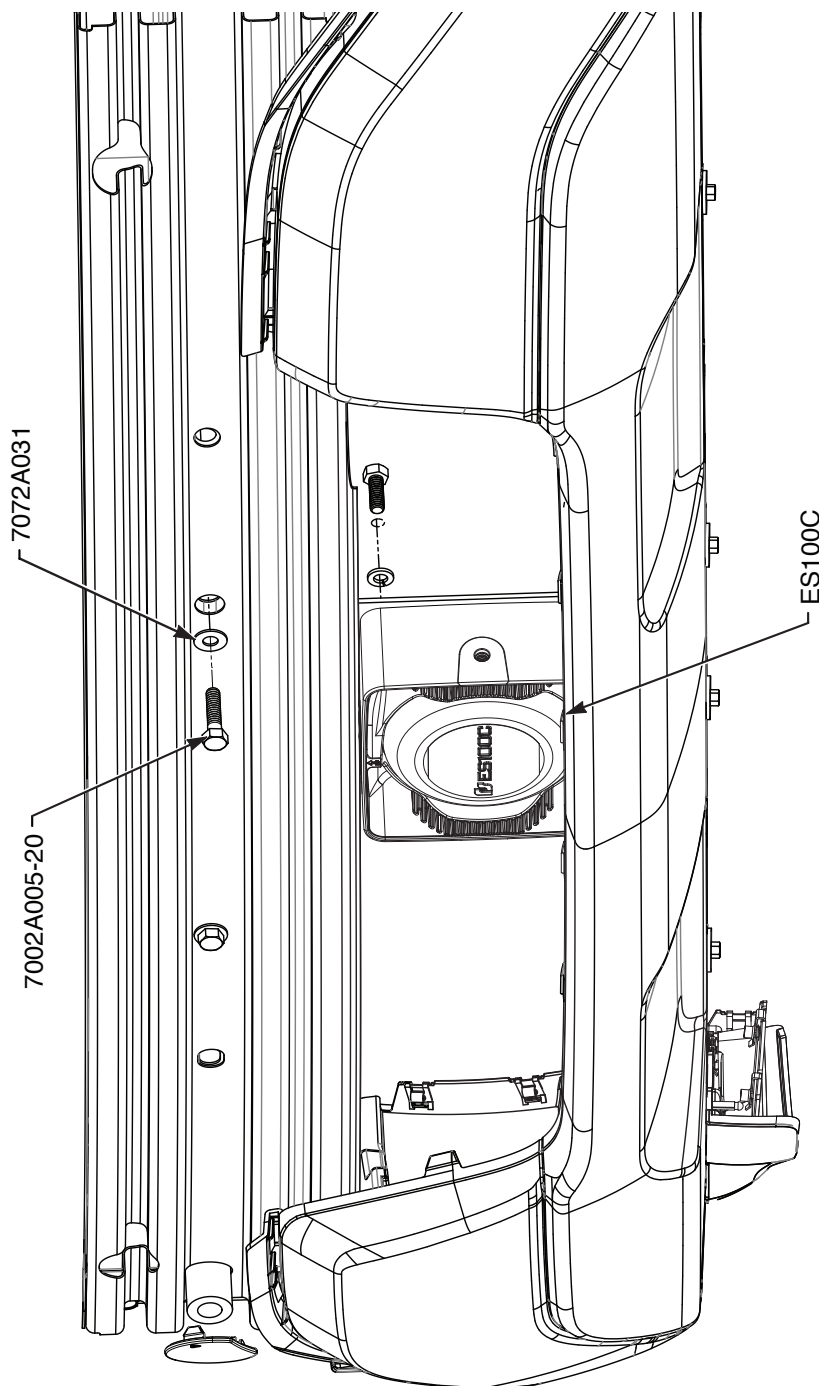

**⚠ WARNING**

**SOUND HAZARD:** All effective sirens and horns produce loud sounds (120 dB) that may cause permanent hearing loss. Always minimize your exposure to siren sound and wear hearing protection. Do not sound the siren indoors or in enclosed areas where you and others will be exposed to the sound.

**NOTICE**

**HOT SURFACE:** The speaker gets hot enough to burn you. Always allow it to cool before handling it.

5. Test the siren for proper operation and reassemble the vehicle.