

Safety Message to Installers and Service Personnel

⚠ WARNING

People's lives depend on your proper installation and servicing of Federal Signal products. It is important to read and follow all instructions shipped with this product and the original product. In addition, listed below are some other important safety instructions and precautions you should follow:

- To properly install the lighting system, you must have a good understanding of automotive systems, along with proficiency in the installation and use of safety warning equipment.
- This product is intended for supplemental warning and for use in conjunction with an approved primary warning light system. This searchlight mounting kit is designed for use **ONLY** with the Federal Signal LEGEND lightbar.
- **DO NOT** install equipment or route wiring in the deployment path of an airbag.
- When drilling into a vehicle structure, be sure that both sides of the surface are clear of anything that could be damaged.
- A light system is a high current device. For it to function properly, a separate ground connection must be made. If practical, it should be connected to the negative battery terminal. At a minimum, it may be attached to a solid metal body or chassis part that will provide an effective ground path as long as the light system is used.
- Locate the light system controls so the **VEHICLE** and **CONTROLS** can be operated safely under all driving conditions.
- The mounting system should be periodically inspected to ensure that it is securely attached to the vehicle.
- File these instructions in a safe place and refer to them when maintaining and/or reinstalling the product.

Failure to follow all safety precautions and instructions may result in property damage, serious injury, or death.

Introduction

The kit enables you to attach a searchlight onto the LEGEND or INTEGRITY lightbar with a plate secured through the barrel-nut holes in the lightbar's top dome. The plate has holes for attaching the searchlight and two large holes for routing wires. If necessary, additional mounting holes can be drilled into the plate to match holes in the base of the searchlight.

Unpacking the Kit

After unpacking the kit, inspect it for damage that may have occurred in transit. If the product has been damaged, do not attempt to install or operate it. File a claim immediately with the carrier stating the extent of damage. Carefully check all envelopes, shipping labels, and tags before removing or destroying them. Ensure that the parts listed in the Kit Contents List are contained in the packing carton. Disposal of all shipping materials must be carried out in accordance with national and local codes and standards

Table 1 Kit contents

Qty.	Description
1	Plate
12	Rubber Washer
4	O-Ring, 5/16" Diameter
4	Plastic Washer
4	Nut, Barrel, 1/4"-20 x 1.50"
4	Screw, Hex Head, #8-32
2	Cable Mount
2	Cable Tie

Preparing the Mounting Plate

To prepare the mounting plate:

1. Remove the barrel nuts securing the lightbar dome.
2. Stack three rubber washers over each barrel-nut hole.
3. To attach the searchlight to the mounting plate, refer to instructions included with the searchlight. On the mounting plate select the set of #8-32 mounting holes that matches your searchlight, or add holes if needed. When installed, the hardware should not protrude more than 1/4 inch from the bottom of the plate.
4. The two large holes in the mounting plate let wiring from the searchlight enter the gap between the plate and the top dome. Route the power and control wires through the openings and around the lightbar. The adhesive cable mounts included in the kit can be used to route the wires.

Figure 1 Mounting bracket attached to the lightbar

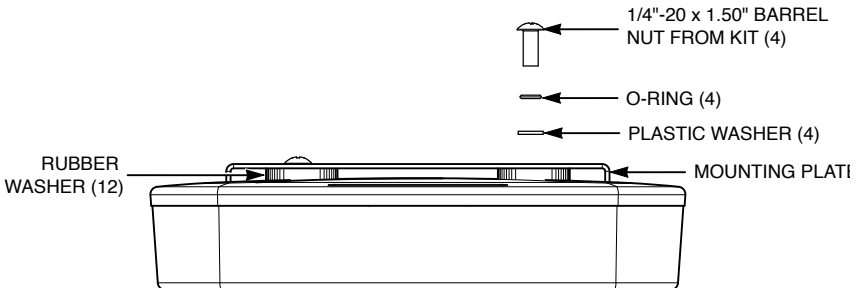

Mounting the Searchlight on the Lightbar

NOTICE

DO NOT DRILL INTO THE LIGHTBAR: Drilling into the lightbar top domes of the lightbar for hardware or cable routing creates a pathway for water to enter the lightbar and is not permitted.

1. At the end of the lightbar where the searchlight will be mounted, remove the four barrel nuts that secure the top dome. Leave the dome in place.
2. Place the plate searchlight assembly onto the lightbar and align the corner holes in the mounting plate with the barrel-nut holes on the lightbar.
3. See Figure 1. Place an O-ring and a plastic washer around each of the four 1/4"-20 x 1.50" barrel nuts included in the kit.
4. Insert the nuts into the corner holes in the mounting plate.
5. Alternately tighten the barrel nuts until the plate just touches the top dome. To get the threads started, you may have to compress the rubber washers by pressing on the plate.

NOTICE

DO NOT OVERTIGHTEN THE BARREL NUTS: To avoid damaging the lightbar, do not overtighten the barrel nuts.

6. To complete the installation, refer to the instructions included with the searchlight.



2645 Federal Signal Drive, University Park, IL 60484-3167
Tel.: (800) 264-3578 • (708) 534-3400 • Fax: (800) 682-8022
www.fedsig.com

© 2015 Federal Signal Corporation