

25500707 Rev A1 0621

## **Safety Message to Installers and Operators of Warning Lights**

### **⚠ WARNING**

People's lives depend on your proper installation and servicing of Federal Signal products. It is important to read and follow all instructions shipped with this product and the original product. Listed below are some other important safety instructions and precautions you should follow.

### **Before Installation or Service**

#### *Qualifications*

- To properly install or service this equipment, you must have a good understanding of automotive electrical procedures and systems along with proficiency in the installation and service of safety warning equipment. Always refer to the vehicle service manuals when installing equipment on a vehicle.

#### *Electrical Hazards*

- Never attempt to install aftermarket equipment that connects to the vehicle wiring without reviewing a vehicle wiring diagram available from the vehicle manufacturer. Ensure that your installation will not affect vehicle operation and safety functions or circuits.

### **During Installation or Service**

- To avoid a battery explosion, always disconnect the negative battery cable first and reconnect it last. Avoid a spark when connecting near or to the battery. The gasses produced by a battery can cause a battery explosion that could result in vehicle damage and serious injury.
- Do not install equipment or route wiring or a plug-in cord in the deployment path of an airbag.
- Before mounting any components, check the manual to be sure that the component you are installing is suitable for use in that area of the vehicle. Many components are not suitable for use in the engine compartment or in other areas subject to extreme environmental exposure.
- When drilling into a vehicle structure, be sure that both sides of the surface are clear of anything that could be damaged. Remove all burrs from drilled holes to prevent electrical shorts, grommet all drilled holes through which wiring passes. Also ensure that mounting screws do not cause electrical or mechanical damage to the vehicle.

### **After Installation or Service**

- If a vehicle seat is temporarily removed, verify with vehicle manufacturer if the seat needs to be recalibrated for proper airbag deployment.
- To ensure proper operation, test all vehicle functions, including horn operation, vehicle safety functions, and vehicle light systems. Ensure that installation has not affected vehicle operation or changed any vehicle safety function or circuit.
- After installation and testing are complete, provide a copy of these instructions to instructional staff and all operating personnel.
- File these instructions in a safe place and refer to them when maintaining and/or reinstalling the product.

Failure to follow all safety precautions and instructions may result in property damage, serious injury, or death.

## Installing a PBX-PIT08 Pit Bar on the 2021 Chevrolet® Tahoe® Police Pursuit Vehicle

### Unpacking the Kit

After unpacking the product, inspect it for damage that may have occurred in transit. If it has been damaged or is missing a part, do not attempt to install or operate it. File a claim immediately with the carrier, stating the extent of the damage. Carefully check all envelopes, shipping labels and tags before removing or destroying them. Ensure that all parts in Table 1 have been included. If you are missing any parts, contact Customer Support at 1-800-264-3578, 7 A.M. to 5 P.M., Monday through Friday (CT).

**Table 1 Kit contents**

Item	Qty	Description	Tools Needed
1	1	Driver Pit Bar	18 mm Socket
2	1	Passenger Pit Bar	18 mm Wrench
3	2	Short Spacer	Ratchet
4	2	Long Spacer	Torque Wrench
5	1	Driver Mounting Bracket	Allen Wrench
6	1	Passenger Mounting Bracket	Cutting Tool
7	4	M12 Bolt Plate	Motor Drill
8	1	Driver Support Bracket	1-1/2-inch Hole Saw
9	1	Passenger Support Bracket	
10	2	Support Plate Bracket	
11	12	M12 Button Head Bolt (Black Zinc)	
12	8	M12 Serrated Flange Nut (Black Zinc)	
13	12	M12 Bellville Washer (Black Zinc)	
14	2	M12 Long Hex Head Bolt (Yellow Zinc)	
15	4	M12 Short Hex Head Bolt (Yellow Zinc)	
16	8	M12 Serrated Flange Nut (Yellow Zinc)	
17	6	M12 Flat Washer	
18	1	Driver Template	
19	1	Passenger Template	

**NOTE:** This pit bar kit is to be installed with PBX08 at the same time.

If installing in a civilian vehicle, the product will not work with factory parking sensors.

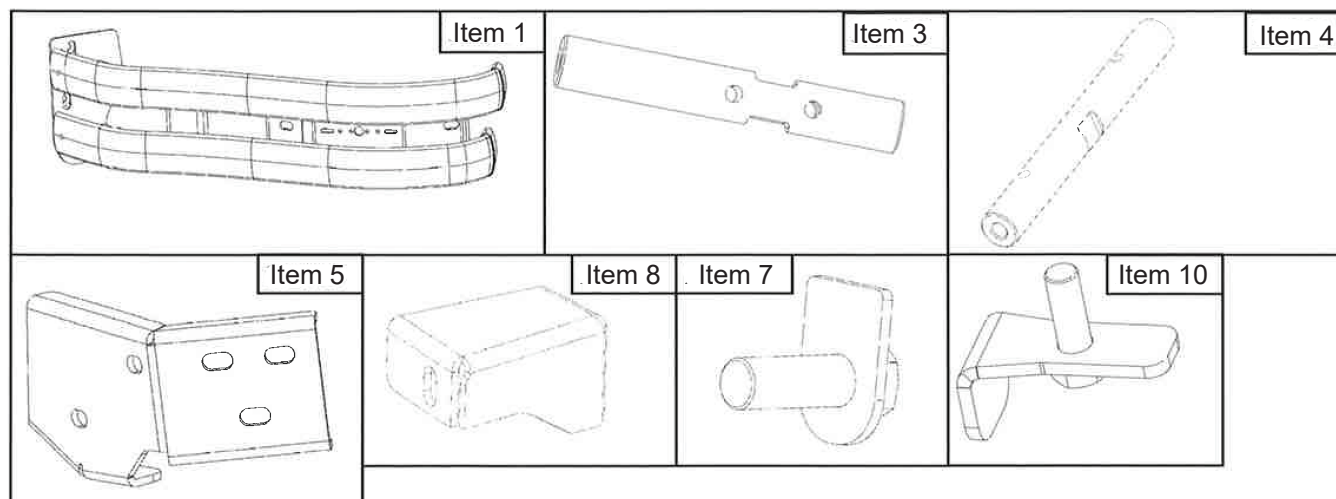

**⚠ WARNING**

**PUSH BUMPER PRECAUTION:** *Installing a push bumper on a vehicle may raise the vehicle's minimum collision speed for airbag deployment. It is imperative that police officers wear safety belts when operating their motor vehicle. Failure to follow this warning may cause serious injury or death.*

**NOTICE**

**THREAD DAMAGE AND GALLING:** *To prevent thread damage and galling, anti-seize lubricant must be used on all stainless steel fasteners.*

## Installing the Pit Bar

To install the pit bar:

1. With the fascia removed, drill out both the front and rear factory holes shown in Figure 1 to 9/16-inch on both the driver and passenger side.

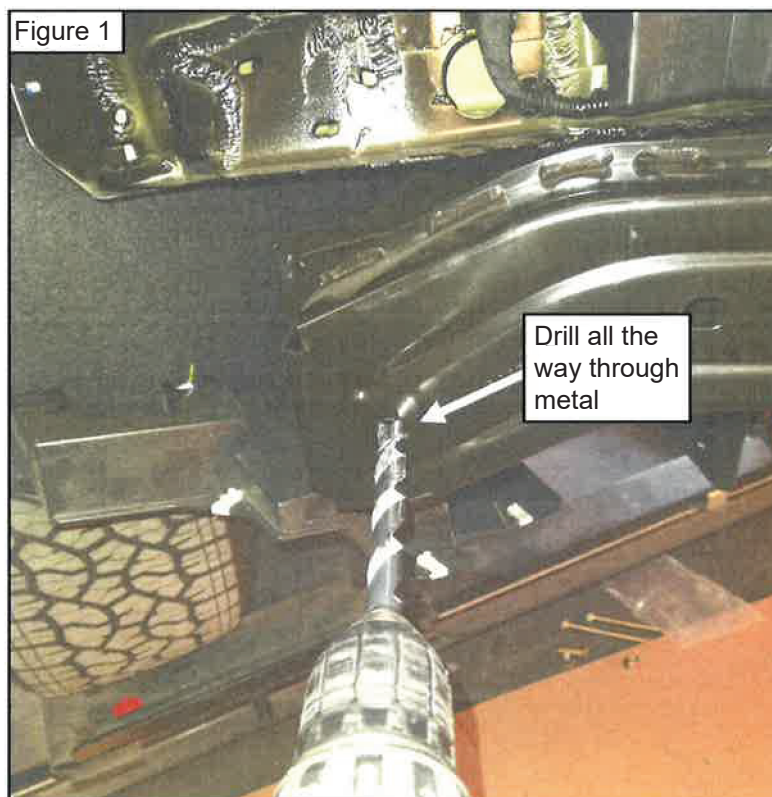

2. Loosely install the pit bar mounting brackets (Items 5 and 6) and the support brackets (Items 8 and 9). Using support plates (Item 10) and M12 hardware. See Figures 2-4

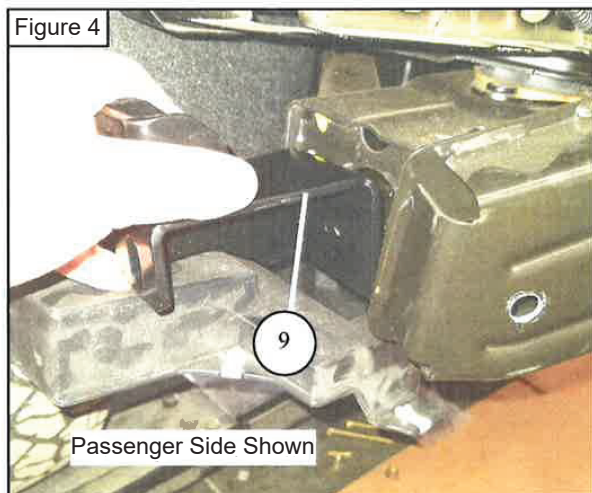
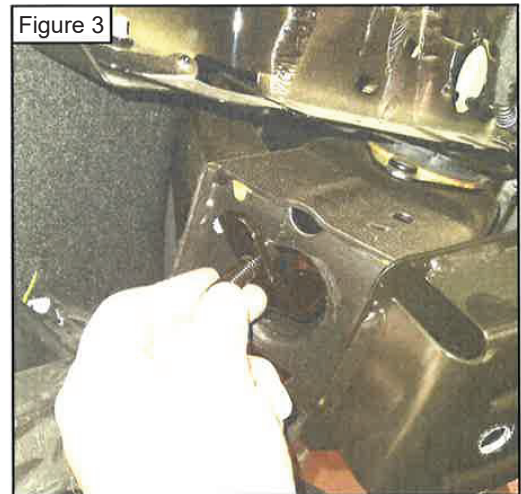
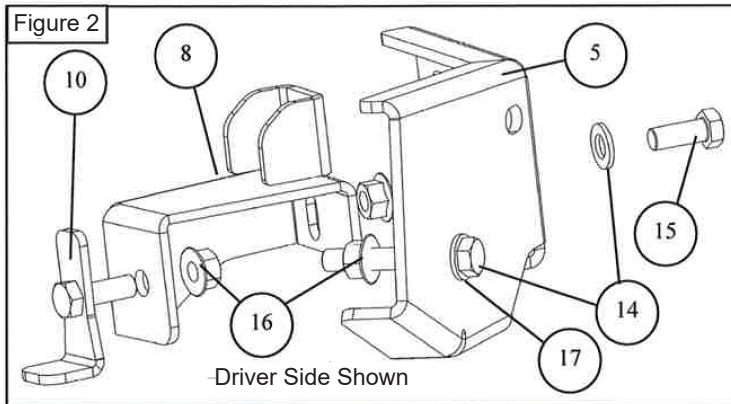

3. Reinstall the fascia and push bumper on the vehicle.
4. Using the provided cutting templates, align the template to the bumper edge as shown in Figure 5, and carefully cut out 1-1/2-inch holes for the pit bar spacers on each side.  
  
**NOTE:** The outer holes need to be drilled perpendicular to the vehicles tire. See Figure 5 and 6.
5. Use the bolt plates (Item 7) to install the long and short spacers on each side. The long spacers are mounted on the outer sides of the bumper and the short spacers mount on the inner sides. See Figure 7.



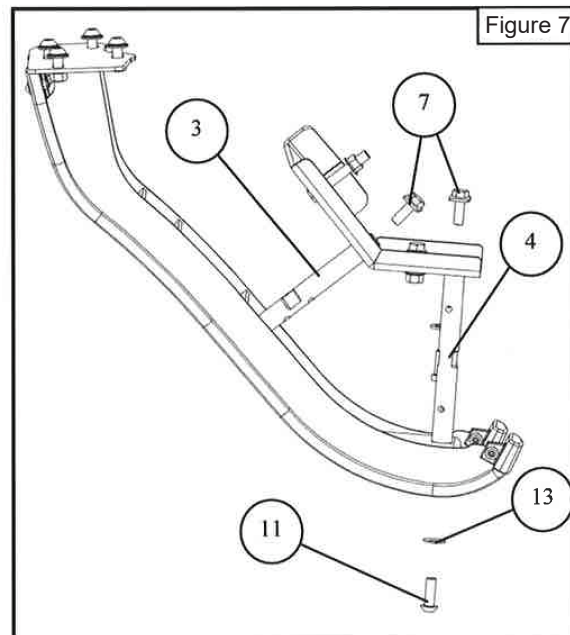
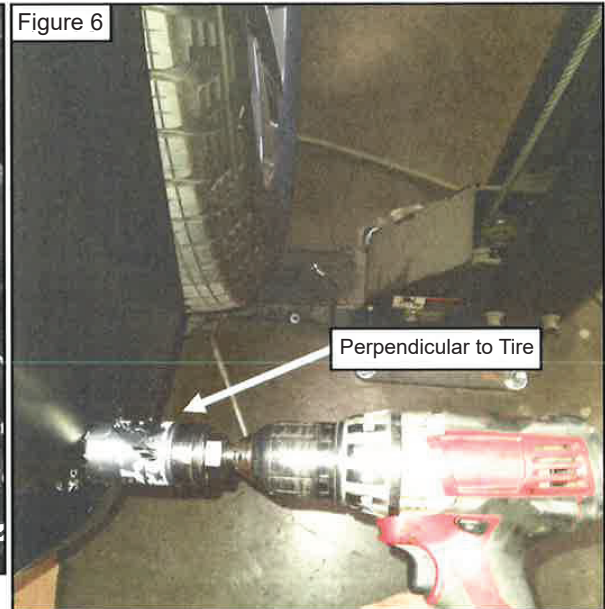
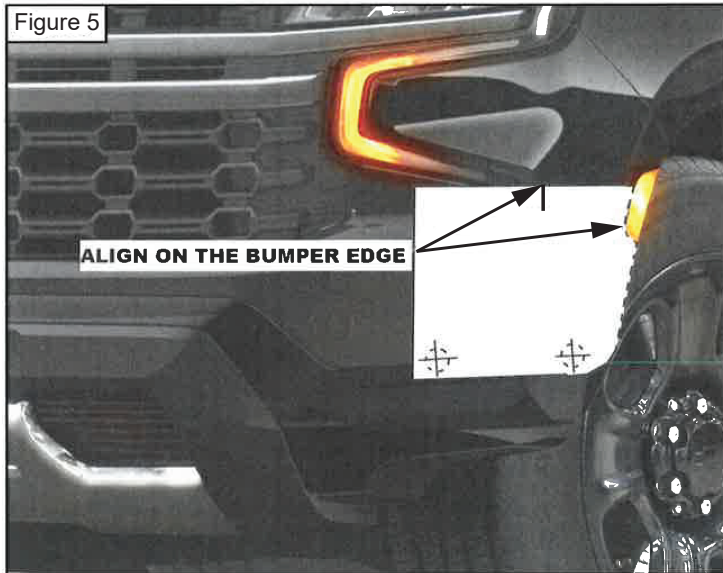

6. Assemble the pit bars on to the spacers and push bumper using M12 hardware. See Figure 8
7. Adjust all hardware and torque all M12 hardware to 50-55 ft-lb.

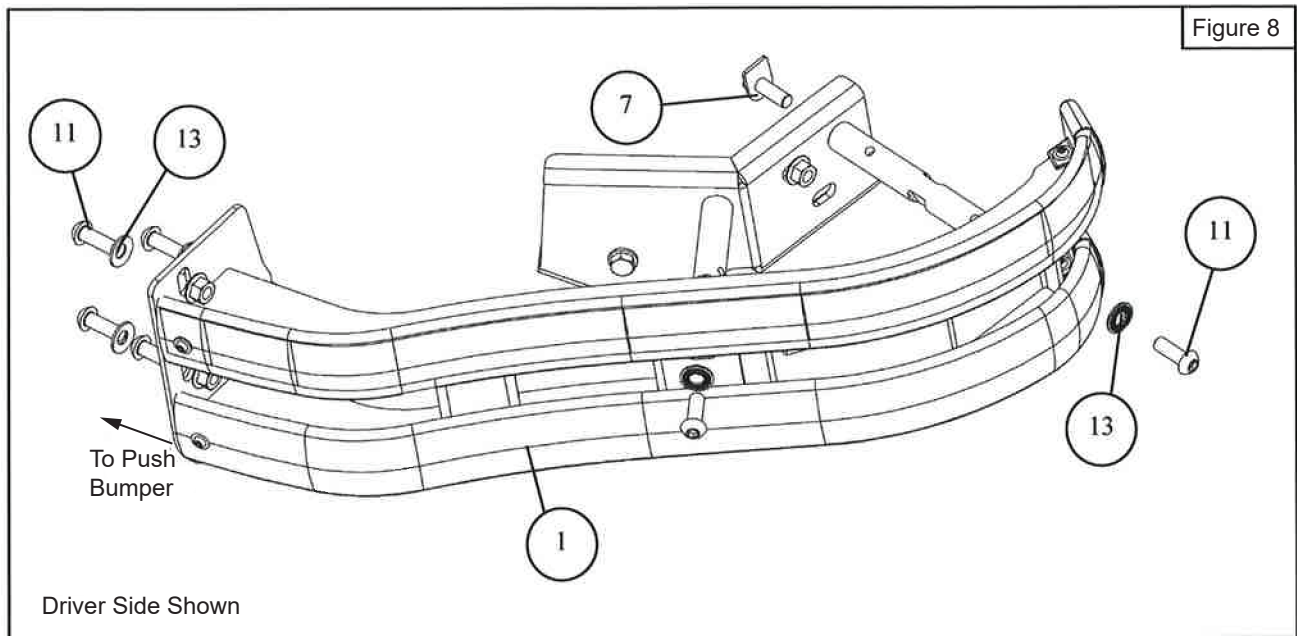

Installation Completed



### Maintaining the Pit Bar

Regularly clean stainless steel and gloss black finishes with a mild soap and water. Apply a non-abrasive wax or polish. To polish small scratches on stainless steel, use stainless steel polish. To avoid making scratches on the stainless steel surfaces, follow the grain of the steel while polishing.

Figure 9 Driver Side Template (Not to Scale)

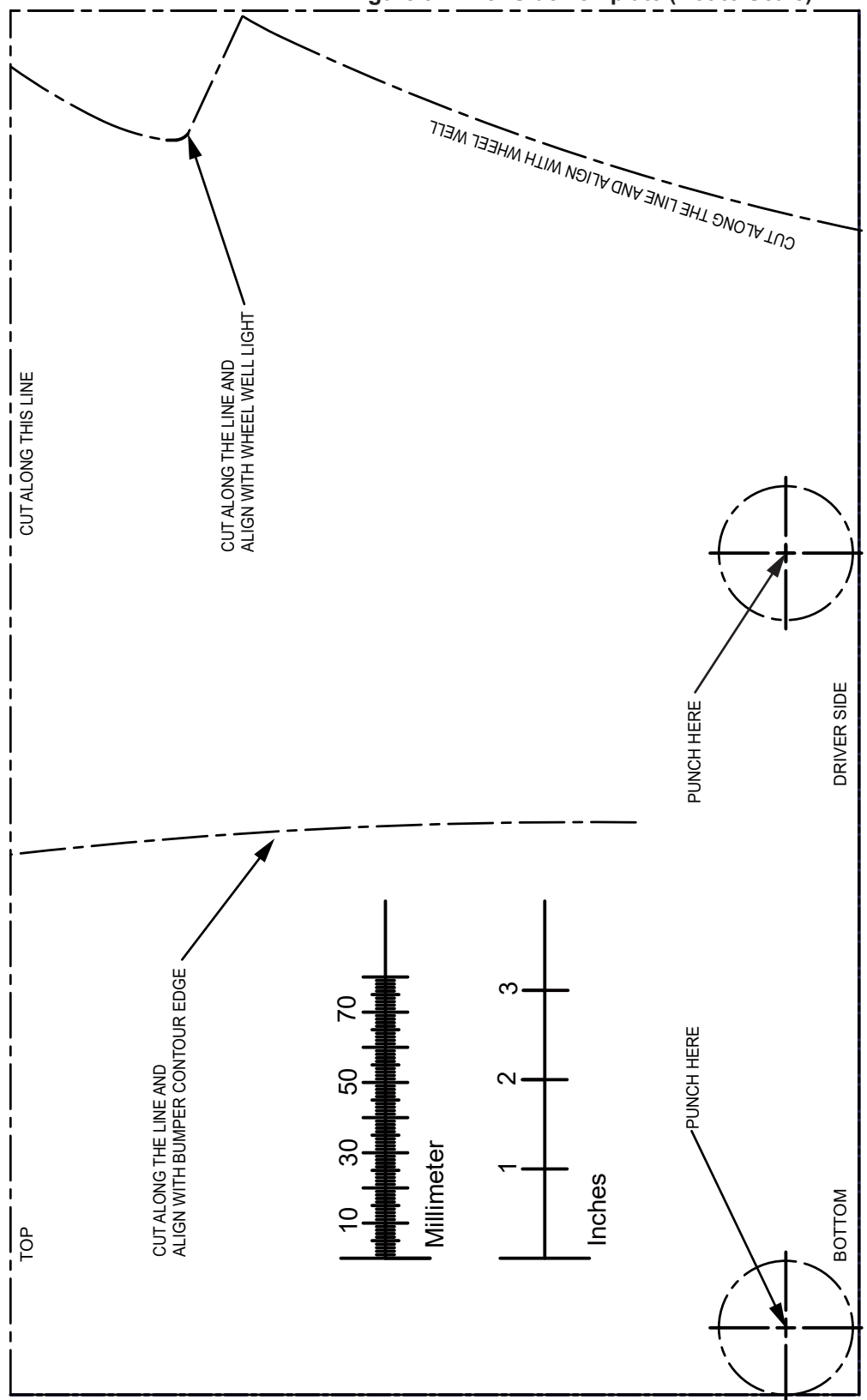

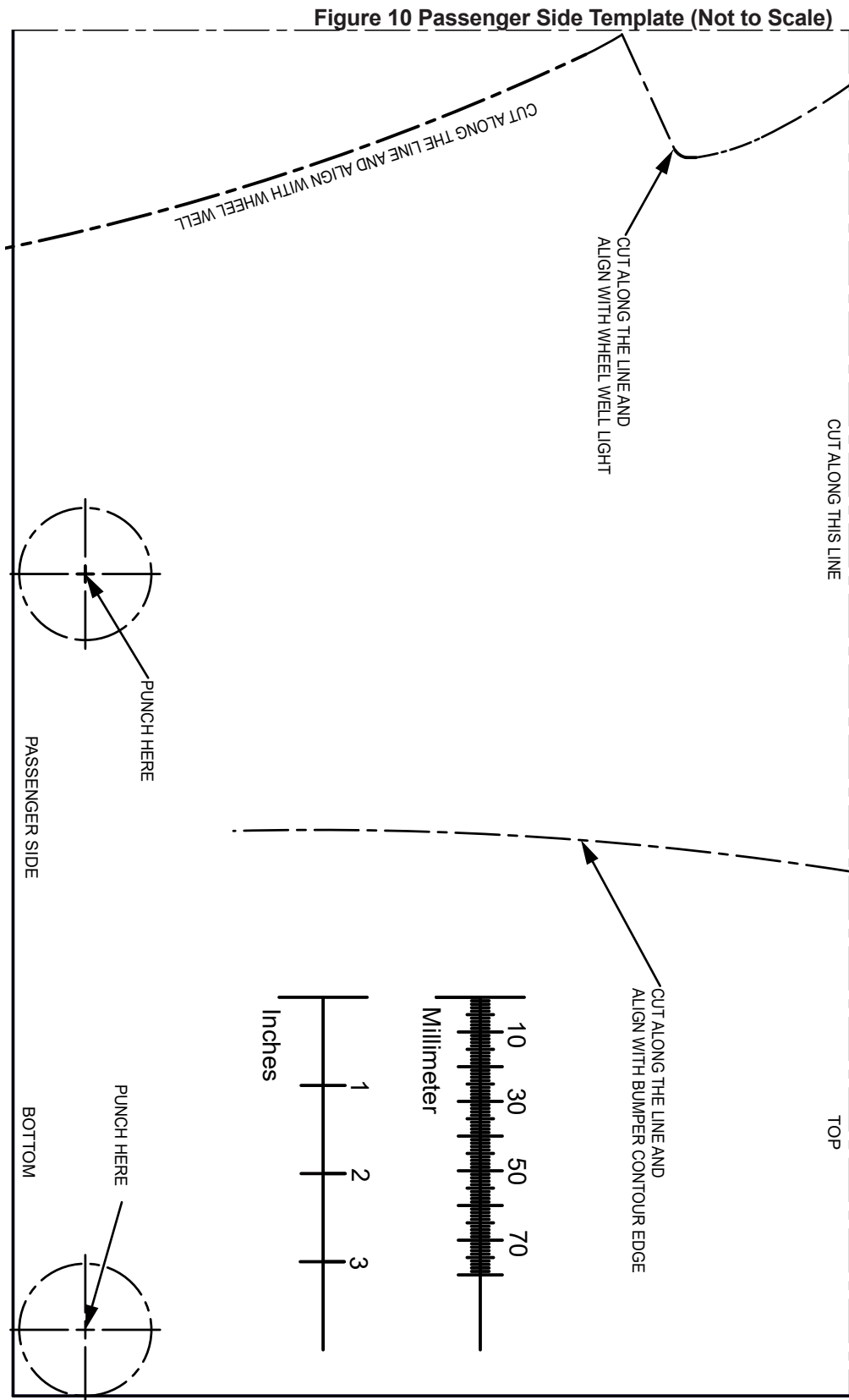

## **Getting Technical Support and Service**

For technical support, please contact:

Federal Signal Corporation  
Service Department  
Phone: 1-800-433-9132  
Email: [empserviceinfo@fedsig.com](mailto:empserviceinfo@fedsig.com)

## **Getting Repair Service**

The Federal Signal factory provides technical assistance with any problems that cannot be handled locally. Any product returned to Federal Signal for service, inspection, or repair must be accompanied by a Return Material Authorization (RMA). Obtain a RMA from a local Distributor or Manufacturer's Representative. Provide a brief explanation of the service requested, or the nature of the malfunction.

Address all communications and shipments to the following:

Federal Signal Corporation  
Service Department  
2645 Federal Signal Dr.  
University Park, IL 60484-3167



## **Ordering Replacement Parts**

To order replacement parts, call Customer Support at 1-800-264-3578, 7 a.m. to 5 p.m., Monday through Friday (CT) or contact your nearest distributor.

## **Limited Warranty**

This product is subject to and covered by a limited warranty, a copy of which can be found at [www.fedsig.com/SSG-Warranty](http://www.fedsig.com/SSG-Warranty). A copy of this limited warranty can also be obtained by written request to Federal Signal Corporation, 2645 Federal Signal Drive, University Park, IL 60484, email to [info@fedsig.com](mailto:info@fedsig.com) or call +1 708-534-3400.

This limited warranty is in lieu of all other warranties, express or implied, contractual or statutory, including, but not limited to the warranty of merchantability, warranty of fitness for a particular purpose and any warranty against failure of its essential purpose.



**FEDERAL SIGNAL**  
Safety and Security Systems

2645 Federal Signal Drive  
University Park, Illinois 60484

[www.fedsig.com](http://www.fedsig.com)

Customer Support

Police/Fire-EMS: 800-264-3578 • +1 708 534-3400

Work Truck: 800-824-0254 • +1 708 534-3400

Technical Support 800-433-9132 • +1 708 534-3400

© 2021 Federal Signal Corporation

All product names or trademarks are properties of their respective owners.



**FEDERAL SIGNAL**  
Safety and Security Systems

2645 Federal Signal Drive  
University Park, Illinois 60484

[www.fedsig.com](http://www.fedsig.com)

Customer Support

Police/Fire-EMS: 800-264-3578 • +1 708 534-3400

Work Truck: 800-824-0254 • +1 708 534-3400

Technical Support 800-433-9132 • +1 708 534-3400

© 2021 Federal Signal Corporation

All product names or trademarks are properties of their respective owners.