

25500512 B0 1219

Safety Message to Installers of Warning Light Equipment

People's lives depend on your proper installation and servicing of Federal Signal products. It is important to read and follow all instructions shipped with this product and the original product. Listed below are some other important safety instructions and precautions you should follow.

- To properly install the lighting system, you must have a good understanding of automotive systems, along with proficiency in the installation and use of safety warning equipment.
- Do not install equipment or route wiring in the deployment path of an airbag.
- If a vehicle seat is temporarily removed, verify with the vehicle manufacturer if the seat needs to be recalibrated for proper airbag deployment.
- Frequently inspect the light system to ensure that it is operating properly and that it is securely attached to the vehicle.
- When drilling into a vehicle structure, ensure that both sides of the surface are clear of anything that could be damaged.
- Refer to the instructions packed with related products for additional precautions and information.
- File these instructions in a safe place and refer to them when maintaining and/or reinstalling the product.
- Do not stare directly into the lights at a close range or permanent damage to your eyesight may occur.

Failure to follow all safety precautions and instructions may result in property damage, serious injury, or death.

MPSMW9-FORD15MIR Mounting Kit

This publication has instructions for using the MPSMW9-FRD15MIR Mounting Kit to mount a pair of MicroPulse MPSW9 lightheads to the side mirrors of the Ford F150.

NOTE: For electrical installation instructions, refer to the installation and maintenance instructions packed with the lighthead.

Unpacking the Kit

After unpacking the kit, inspect it for damage that may have occurred in transit. If it has been damaged, do not attempt to install or operate it. File a claim immediately with the carrier, stating the extent of damage. Carefully check all envelopes, shipping labels, and tags before removing or destroying them. Ensure that the parts in the Kit Contents List are included in the package. If you are missing any parts, contact Customer Support at 1-800-264-3578, 7 a.m. to 5 p.m., Monday through Friday (CT).

Table 1 Kit Contents

Qty	Description	Part No.
1	BRKT, MPSW9, MIRROR, 18F150, DS	861302789
1	BRKT, MPSW9, MIRROR, 18F150, PS	861302790
4	Screw, 6-32, Phillips Pan, SS	7000491-08
4	Nut, 6-32 Keps, SS	7058A046
4	Screw, #10 Type B, 6-Lobe, Black	7011246-06
2	Screw, Thread Forming, Phillips Pan, SS, #8	7011242-16

Installing the Brackets

⚠ WARNING

AIRBAG DEPLOYMENT: Do not install equipment or route wiring in the deployment path of an airbag. Failure to observe this warning will reduce the effectiveness of the airbag or potentially dislodge the equipment, causing serious injury or death.

⚠ WARNING

DRILLING PRECAUTIONS: When drilling holes, check the area you are drilling into to be sure you do not damage vehicle components. All drilled holes should be deburred and all sharp edges should be smoothed. All wire routings going through drilled holes should be protected by a grommet or convolute/split loom tubing.

IMPORTANT: Plan all cable routing before the installation.

To install the brackets:

1. Remove the mirror from the vehicle according to the vehicle manufacturer's instructions.
2. Remove the plastic cap from the mirror using a slotted screwdriver.

- Using scissors, carefully cut out the two drill templates in Figure 1. Puncture holes in the paper at the indicated locations.

Figure 1 Drilling Template

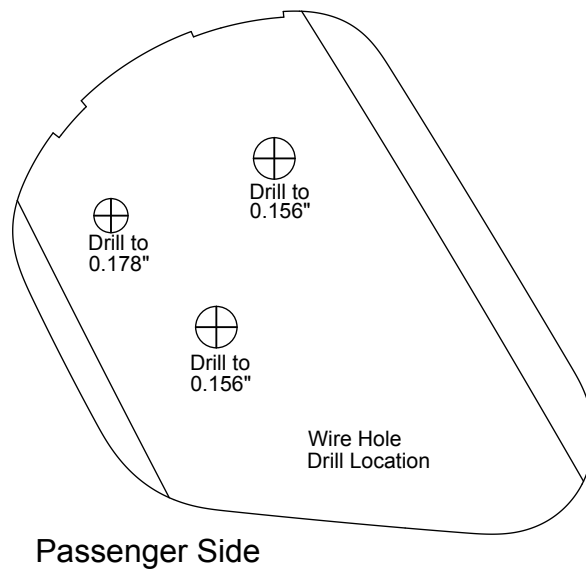
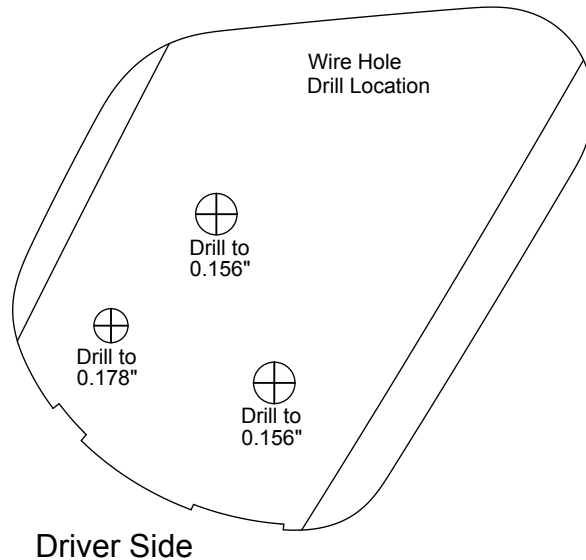

- Place the paper drill template on the previously removed plastic mirror cap. Mark the three drill locations with a paint pen.
- Drill the three locations to the sizes indicated on the template. Drill an appropriate sized wire access hole in the area indicated.
- Loosely install the bracket to the plastic mirror cap using the two supplied #10 screws.

7. Reinstall the plastic mirror cap and bracket onto the mirror.
8. Loosely install the #8 screw through the bracket and mirror cap, and into the screw boss inside the mirror. See Figure 2 for the screw boss diagram.

Figure 2 Screw Boss

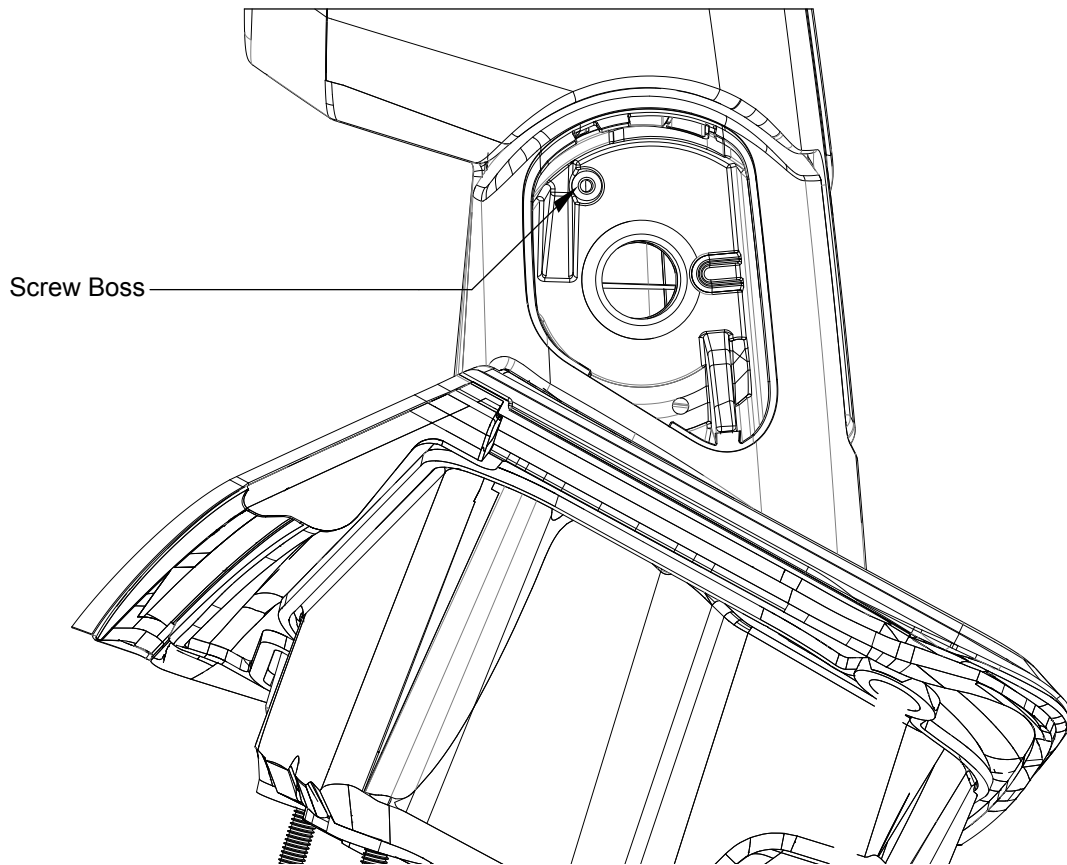

9. Tighten the three screws simultaneously. Do not overtighten.
10. Install the MPSW9 light with the provided #6-32 screws and nuts. Route the wires through the previously drilled wire access hole.
11. Apply RTV to the wire access hole.
12. Reinstall the mirror to the vehicle according to the vehicle manufacturer's instructions.
13. Complete the wiring according to the instructions supplied with the light heads.
14. Repeat steps 1-13 for the opposite mirror.

Figure 3 Bracket mounted to side mirror

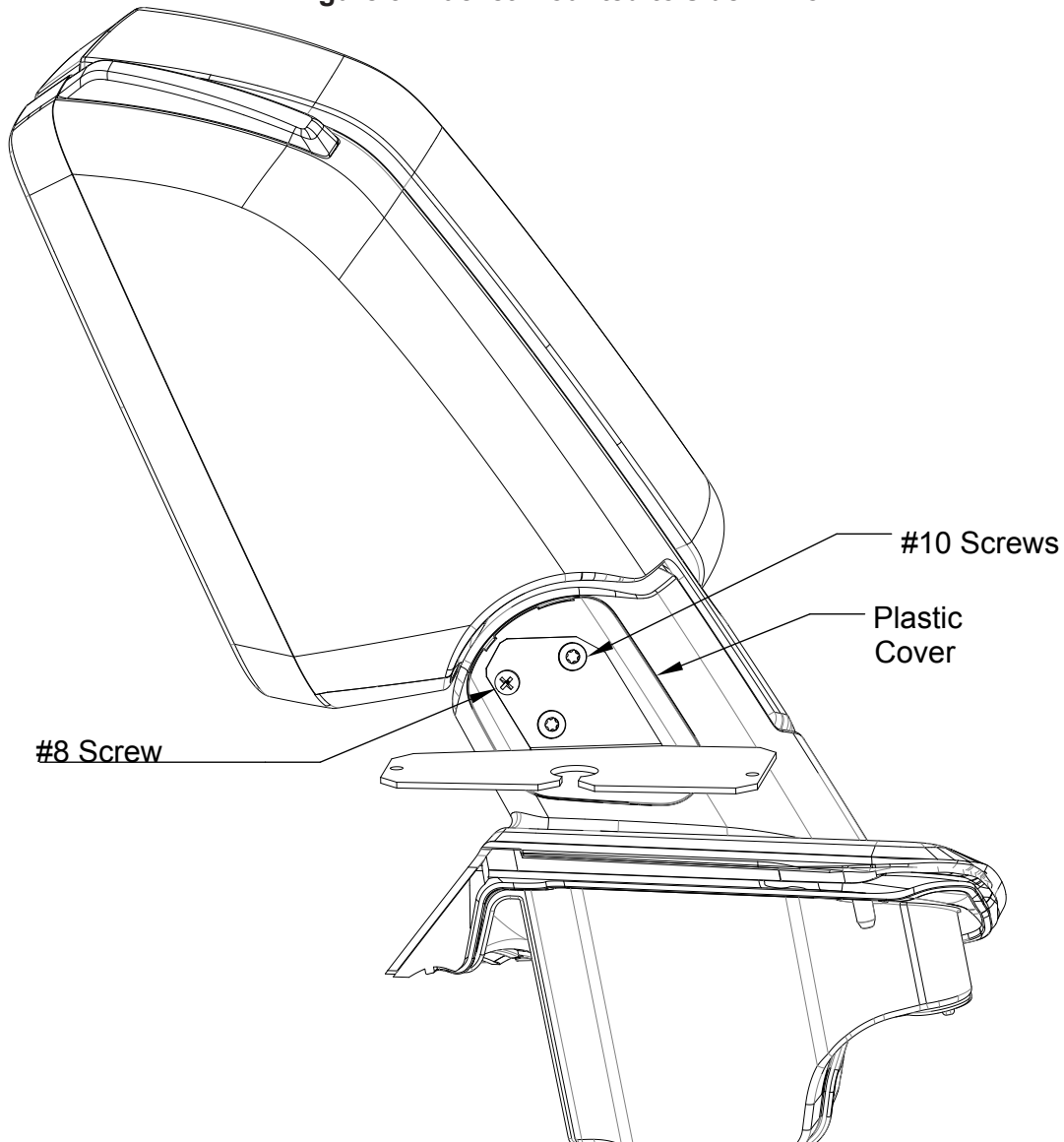

⚠ WARNING

LIGHT HAZARD: To be an effective warning device, an emergency warning system produces bright light that can be hazardous to your eyesight when viewed at a close range. Do not stare directly into the lights at a close range or permanent damage to your eyesight may occur.

Getting Technical Support and Service

For technical support and service, please contact:

Service Department
Federal Signal Corporation
Phone: 1-800-433-9132
Email: empserviceinfo@fedsig.com
www.fedsig.com

Getting Repair Service

The Federal Signal factory provides technical assistance with any problems that cannot be handled locally.

Any units returned to Federal Signal for service, inspection, or repair must be accompanied by a Return Material Authorization (RMA). Obtain a RMA from a local Distributor or Manufacturer's Representative.

Provide a brief explanation of the service requested, or the nature of the malfunction.

Address all communications and shipments to the following:

Federal Signal Corporation
Service Department
2645 Federal Signal Drive
University Park, IL 60484-3167

Ordering Replacement Parts

To order replacement parts, call Customer Support at 1-800-264-3578, 7 a.m. to 5 p.m., Monday through Friday (CT) or contact your nearest distributor.

Limited Warranty

This product is subject to and covered by a limited warranty, a copy of which can be found at www.fedsig.com/SSG-Warranty. A copy of this limited warranty can also be obtained by written request to Federal Signal Corporation, 2645 Federal Signal Drive, University Park, IL 60484, email to info@fedsig.com or call +1 708-534-3400.

This limited warranty is in lieu of all other warranties, express or implied, contractual or statutory, including, but not limited to the warranty of merchantability, warranty of fitness for a particular purpose and any warranty against failure of its essential purpose.



2645 Federal Signal Drive
University Park, Illinois 60484-3167

www.fedsig.com

Customer Support

Police/Fire-EMS: 800-264-3578 • +1 708 534-3400

Work Truck: 800-824-0254 • +1 708 534-3400

Technical Support: 800-433-9132 • +1 708 534-3400

© Copyright 2019 Federal Signal Corporation

Legend is a trademark of Federal Signal Corporation.

All other product names or trademarks are properties of their respective owners.