

25500716 Rev. A0 0321

Safety Message to Installers of Warning Light Equipment

⚠ WARNING

People's lives depend on your proper installation and servicing of Federal Signal products. It is important to read and follow all instructions shipped with this product and the original product. Listed below are some other important safety instructions and precautions you should follow:

- To properly install a light assembly, you must have a good understanding of automotive electrical procedures and systems, along with proficiency in the installation and use of safety warning equipment.
- Do not install equipment or route wiring in the deployment path of an airbag.
- If a vehicle seat is temporarily removed, verify with the vehicle manufacturer if the seat needs to be recalibrated for proper airbag deployment.
- When drilling into a vehicle structure, be sure that both sides of the surface are clear of anything that could be damaged.
- To be an effective warning device, this product produces bright light that can be hazardous to your eyesight when viewed at close range. Do not stare directly into this lighting product at close range or permanent damage to your eyesight may occur.
- You should frequently inspect the light system to ensure that it is operating properly and that it is securely attached to the vehicle.
- Refer to the instruction sheets included with related products for additional precautions and information.
- File these instructions in a safe place and refer to them when maintaining or reinstalling the product.

Failure to follow all safety precautions and instructions may result in property damage, serious injury, or death.

Overview

This kit, combined with the stainless mounting box, provides a method to melt snow and ice off the QuadraFlare warning and signal light. When power is applied to the heater, it starts to heat as the lenses' temperature lowers below 40°F, activated by an in-line thermostat. It should be installed with an installer-provided power switch to avoid activation in clear weather when not needed. The device is 12 Vdc nominal and will pull 3.0 A maximum for each lens.

Unpacking the Kit

After unpacking the kit, inspect it for damage that may have occurred in transit. If it has been damaged, do not attempt to install or operate it. File a claim immediately with the carrier, stating the extent of damage. Carefully check all envelopes, shipping labels, and tags before removing or destroying them. Ensure that the parts listed in Table 1 on page 2 are included in the package. If you are missing any parts, contact Customer Support at 1-800-264-3578, 7 a.m. to 5 p.m., Monday through Friday (CT).

Installing the Heated Lens Kit for the QaudraFlare® Light Head

Table 1 Kit contents

Qty	Description
24	#6 X 2.5-inch Stainless Steel Screw
24	Nylon Screw Anchor
12	Lens Spacer
2	Heated Lens
2	Faceplate

Installing the Kit

⚠ WARNING

AIRBAG DEPLOYMENT: Do not install equipment or route wiring in the deployment path of an airbag. Failure to observe this warning will reduce the effectiveness of the airbag or potentially dislodge the equipment, causing serious injury or death.

NOTICE

DRILLING PRECAUTIONS : Before drilling holes, check the area into which you plan to drill to ensure you do not damage vehicle components. All drilled holes should be deburred and all sharp edges should be smoothed. All wires going through drilled holes should be protected by a grommet or convolute/split-loom tubing.

To install the light heads:

1. Attach the stainless mounting box(es) to the vehicle, and finish by painting if desired. See Figure 1.

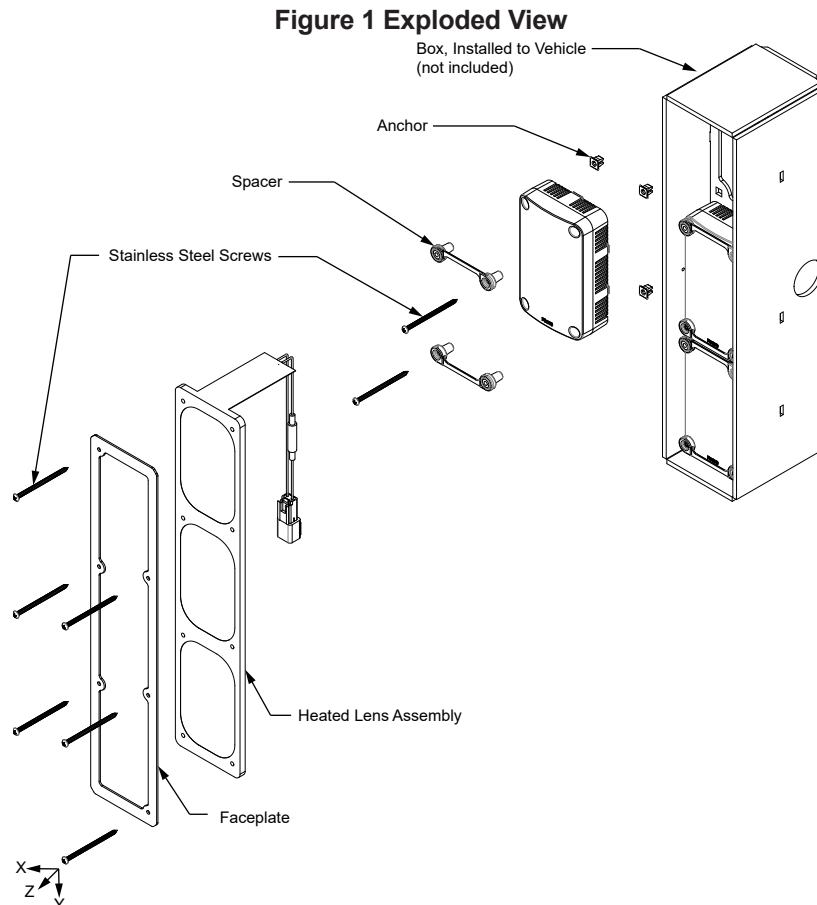

2. Snap the plastic screw anchors into each 1/4-inch square hole in the mounting box.
3. Run all power cables into the box.
4. Determine the required length of wires needed. For lengths up to 15 feet (5 m), use a minimum of 18 AWG (1 mm) wire. For lengths over 15 feet, use a minimum of 16 AWG (1.5 mm) wire.
5. For dual heated lenses, install a 7.5 A fuse and fuse holder to the positive (+) terminal at the voltage source. Connect the supply side of the power switch to this fuse. Connect the heated lens's yellow wire to the switched side.
6. Connect the black (–) wire from the heated lens to a known good vehicle ground as close to the heated lens as is practical.
7. Install all lower QuadraFlares into the box, leaving the top one out for access. Using two spacers and two screws, attach each QuadraFlare to the box. The spacers have two posts for screws. One is flush with the top and the other is recessed. Use the recessed screw holes for this. The flush openings will be used later.

NOTE: It is important that the ribbon cable be at the top of the box.

8. Pass the heated lens power wires and flat ribbon cable through the topmost opening. Connect to the switched power supply. Support the heated lens out of the way to provide access to install the last QuadraFlare.
9. Connect and install the top QuadraFlare in the same manner as the first two.
10. Place the heated lens flat against the spacers and tuck the flat ribbon cable into the box between the top wall and the top QuadraFlare. It should sit flat.
11. Place the faceplate against the heated lens and secure it with the remaining 2.5-inch screws. Ensure that the holes are aligned with the open spacer holes.

⚠ WARNING

LIGHT HAZARD: *To be an effective warning device, an emergency warning system produces a bright light that can be hazardous to your eyesight when viewed at a close range. Do not stare directly into the lights at a close range or permanent damage to your eyesight may occur.*

12. Test the lights for proper operation.

Getting Technical Support and Service

For technical support and service, please contact:

Service Department
Federal Signal Corporation
Phone: 1-800-433-9132
Email: empserviceinfo@fedsig.com

Getting Repair Service

The Federal Signal factory provides technical assistance with any problems that cannot be handled locally. Any product returned to Federal Signal for service, inspection, or repair must be accompanied by a Return Material Authorization (RMA). Obtain a RMA from a local Distributor or Manufacturer's Representative. Provide a brief explanation of the service requested, or the nature of the malfunction.

Address all communications and shipments to the following:

Federal Signal Corporation
Service Department
2645 Federal Signal Dr.
University Park, IL 60484-3167

Limited Warranty

This product is subject to and covered by a limited warranty, a copy of which can be found at www.fedsig.com/SSG-Warranty. A copy of this limited warranty can also be obtained by written request to Federal Signal Corporation, 2645 Federal Signal Drive, University Park, IL 60484, email to info@fedsig.com or call +1 708-534-3400.

This limited warranty is in lieu of all other warranties, express or implied, contractual or statutory, including, but not limited to the warranty of merchantability, warranty of fitness for a particular purpose and any warranty against failure of its essential purpose.



FEDERAL SIGNAL Safety and Security Systems

2645 Federal Signal Drive
University Park, Illinois 60484

www.fedsig.com

Customer Support

Police/Fire-EMS: 800-264-3578 • +1 708 534-3400

Work Truck: 800-824-0254 • +1 708 534-3400

Technical Support 800-433-9132 • +1 708 534-3400

© 2021 Federal Signal Corporation

All product names or trademarks are properties of their respective owners.