

REV.	ITEM	PART NO.	DESCRIPTION	LPX24Z QTY.	LPX32Z QTY.	LPX45Z QTY.	LPX53Z QTY.	LPX61Z QTY.	LPX70Z QTY.
1	8653100		BASE, END	-	-	2	2	2	2
2	8653110		GASKET, END	2	2	2	2	2	2
3	8583020-01		GASKET, DOME, CLEAR	3.55 FT	10.70 FT	13.80 FT	16.90 FT	20.00 FT	
4	231313		PLUG, .875 HOLE	1	1	1	1	1	1
5	---		---	-	-	-	-	-	-
6	228134		GROMMET, SPLIT WEB	1	1	1	1	1	1
7	7004031-26		BOLT, 1/4-20, CARR., DOGPOINT	4	8	10	12	14	
	8653109-19		EXTRUSION, 19"	1	-	-	-	-	-
	8653109		EXTRUSION, 39"	-	1	-	-	-	-
	8653109-27		EXTRUSION, 27"	-	-	-	-	-	-
	8653109-48		EXTRUSION, 48"	-	-	1	-	-	-
	8653109-56		EXTRUSION, 56"	-	-	-	-	1	-
	8653109-64		EXTRUSION, 64"	-	-	-	-	-	1
9	7011A122-06		SCR,#10 TYP.B HEX W.HD.TH	2	2	2	3	3	
10	8542A028-03		CLAMP,CABLE 7/16 NOMINAL	1	1	1	1	1	
11	7017A034-06		SCREW,HI-LO9,HEX.HD.#10	1	1	1	-	-	
12	8653179		BLACKOUT,CNTR SECTION,LGD	-	-	-	-	-	1
13	8653247		BIG BRD,END,LGD/LPX (REF)	2	2	2	2	2	
14	8653248		BIG BRD,INT,LGD/LPX (REF)	-	2	2	2	2	
15	8653249		BIG BRD,CNTR,LGD/LPX (REF)	-	-	1	2	2	
16	8653101-XX		TOP, END (CONFIG.)	-	2	2	2	2	
17	81462346		NAMEPLATE,LPX	2	2	2	2	2	
18	7065071		NUT,BARREL,1/4-20 SS BLK	4	8	10	12	14	
19	7067016		O-RING,5/16 ID,AS568A-011	4	8	10	12	14	
20	8653102		BASE,CENTER	-	-	1	2	3	
21	8653103-XX		TOP, CENTER (CONFIG)	-	-	1	2	3	
22	81461452		NAMEPLATE, MODEL NO.	1	1	1	1	1	
23	81462345		NAMEPLATE,PATENT,LPX	1	1	1	1	1	
24	1612431-06		LABEL,SAE,06	1	1	1	1	1	
25	161A463		LABEL,WARNING	1	1	1	1	1	
26	1612358		LABEL,WARNING,EYE DAMAGE	2	2	2	2	2	
27	2881407		GASKET	1	1	2	3	4	
28	8653175		BASE, END, 12", LEGEND	2	2	-	-	-	
29	8653176-XX		TOP, END, 12" (CONFIG.)	2	2	-	-	-	

NOT CURRENTLY AVAILABLE

POSITION DOME GASKET JOINT OFF CENTER ON MATING FACE OF BASE.

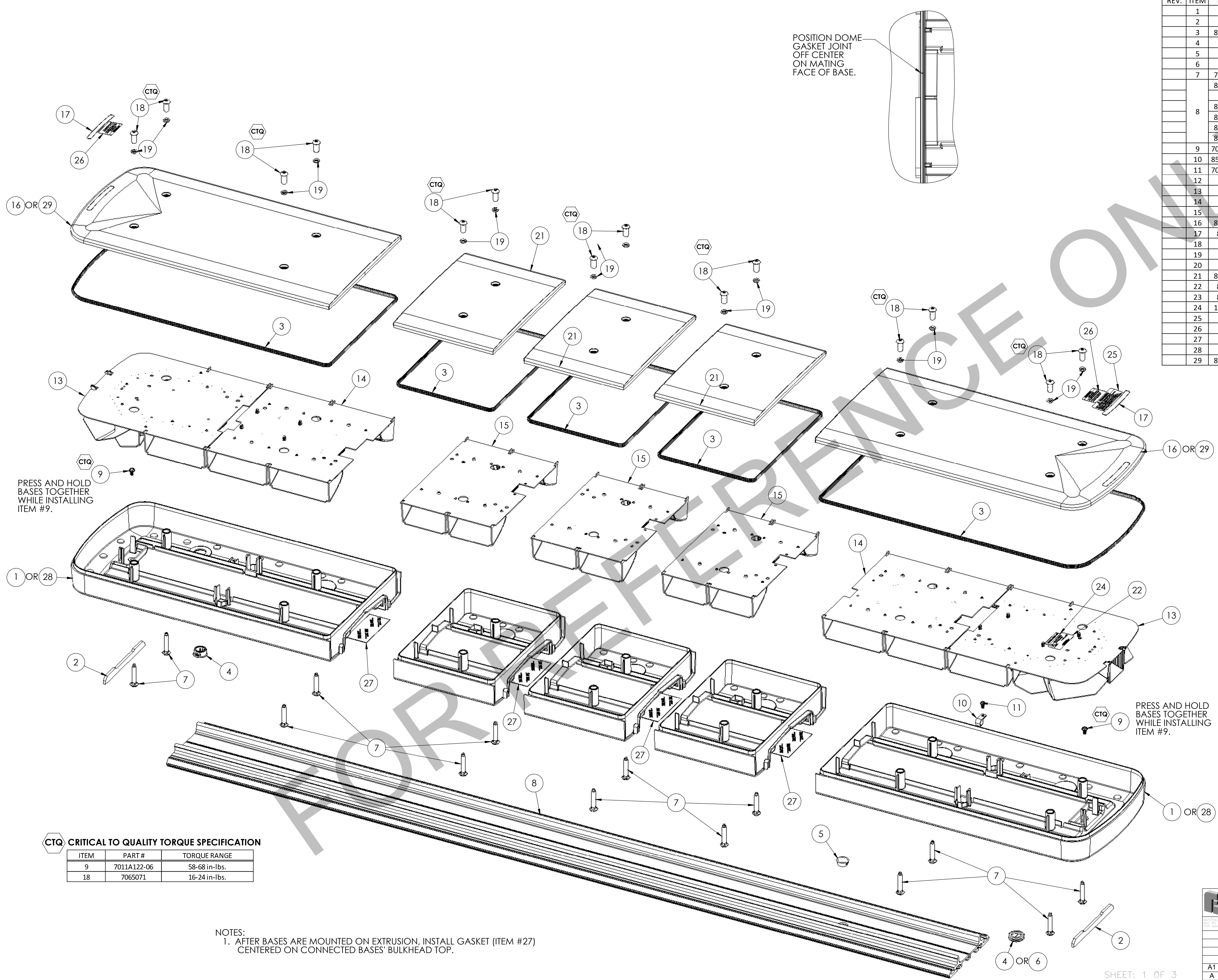

PRESS AND HOLD BASES TOGETHER WHILE INSTALLING ITEM #9.

PRESS AND HOLD BASES TOGETHER WHILE INSTALLING ITEM #9.

CTQ CRITICAL TO QUALITY TORQUE SPECIFICATION

ITEM	PART #	TORQUE RANGE
9	7011A122-06	58-68 in.-lbs.
18	7065071	16-24 in.-lbs.

NOTES:
1. AFTER BASES ARE MOUNTED ON EXTRUSION, INSTALL GASKET (ITEM #27) CENTERED ON CONNECTED BASES' BULKHEAD TOP.

SHEET	INFORMATION
1	SHELL PARTS/BREAKDOWN
2	- INTERNAL WIRING FOR STANDARD BARS - EXTERNAL WIRING FOR STANDARD BARS
3	- WIRELESS CONTROLLER OPTION WIRING - OPTICOM OPTION WIRING

		SAFETY & SECURITY FEDERAL SIGNAL DRIVE 10000 W. 100th St., Overland Park, MO 66204 (816) 875-1000		NAME: _____ TITLE: _____ DATE: _____	
FINAL ASSY., LGDZ				SCALE: AT D SIZE NONE THIRD ANGLE PROJECTION	
REMOVE BURRS, SHARP CORNERS AND EDGES				MATERIAL: N/A	
A1 SEE ECR #694 7/31/13 RM A REL TO PROD ECR #11-8453 1/31/12 RM		DRAWN BY: RM DATE: 1/31/12		CHECKED BY: EJS DATE: 1/31/12	
REV. CHANGE DATE BY		DRAWING NUMBER 8653251A		SHEET: 1 OF 3 UNITS: INCHES	

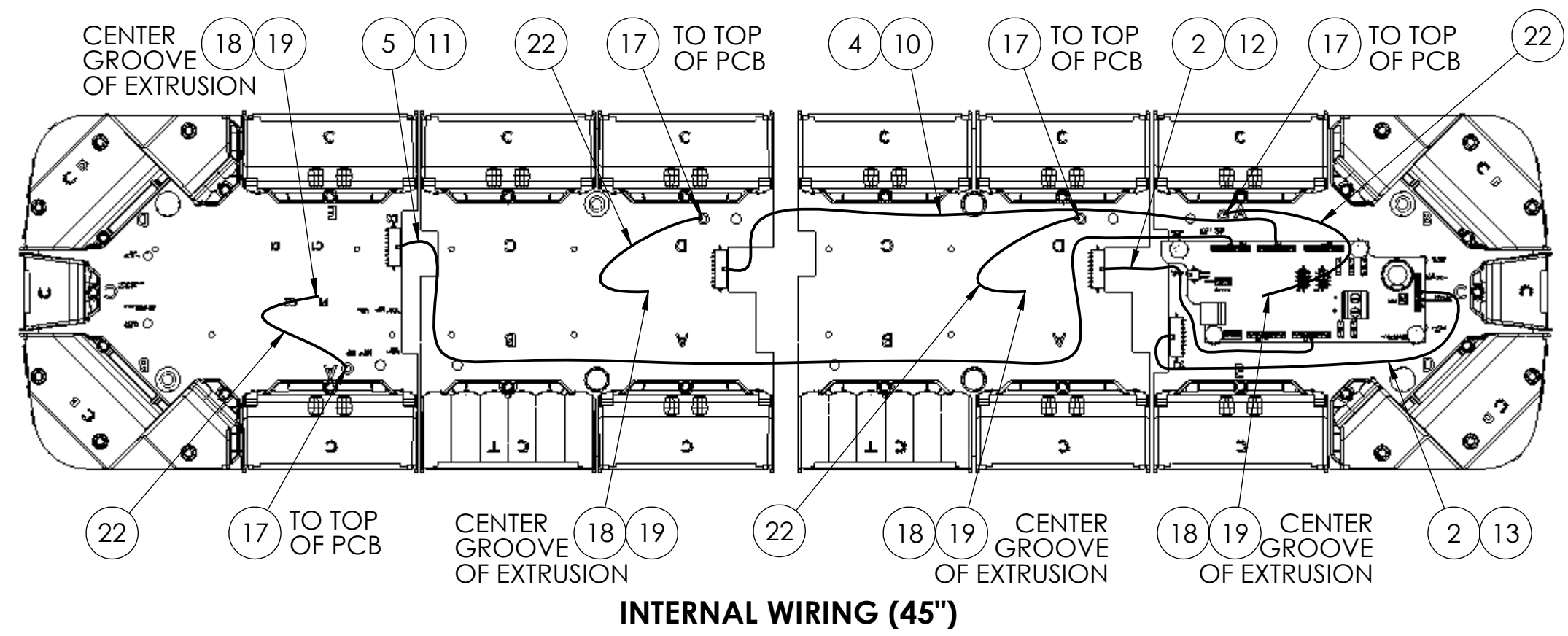

INTERNAL WIRING (45'')

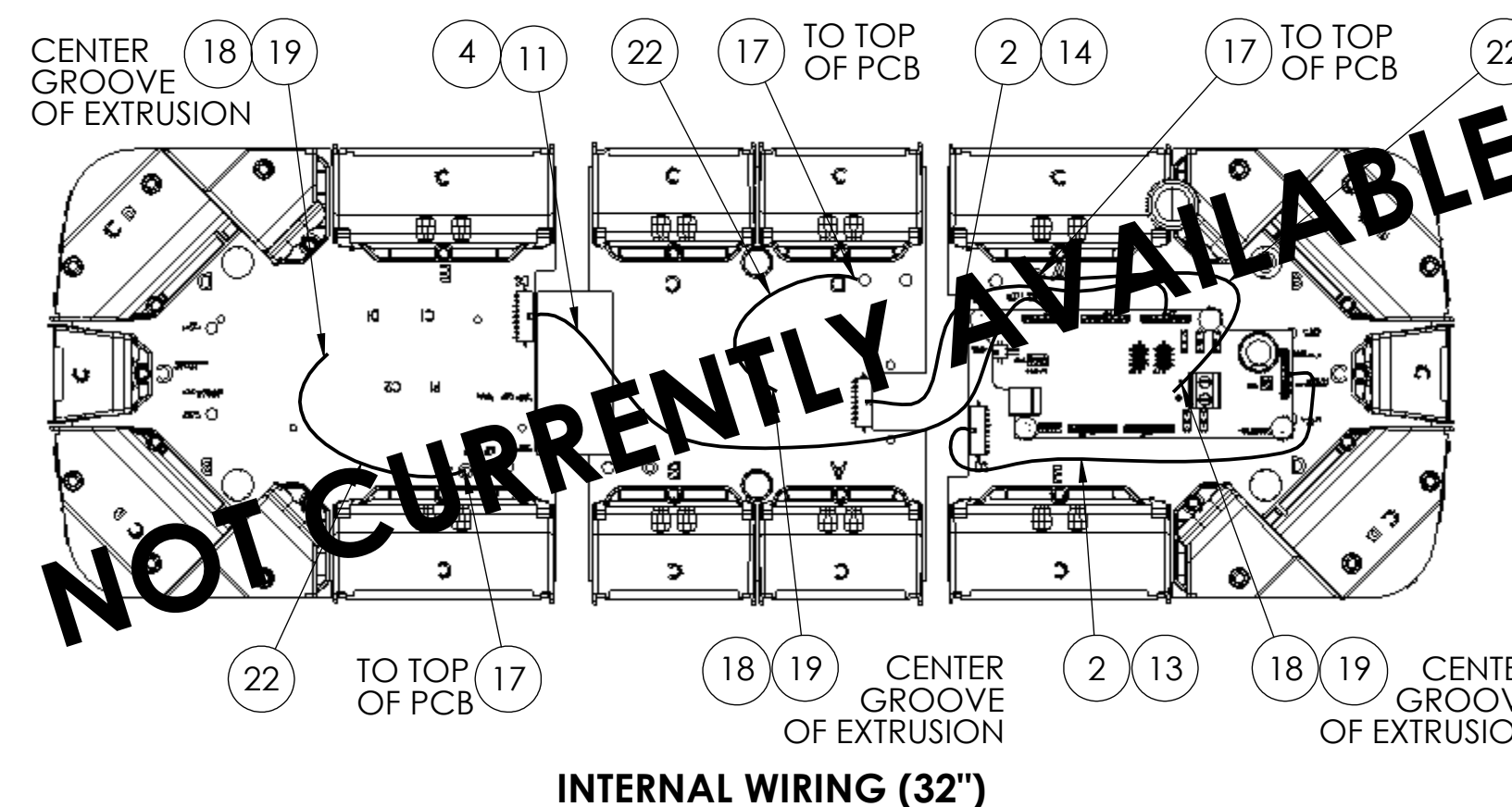

INTERNAL WIRING (32'')

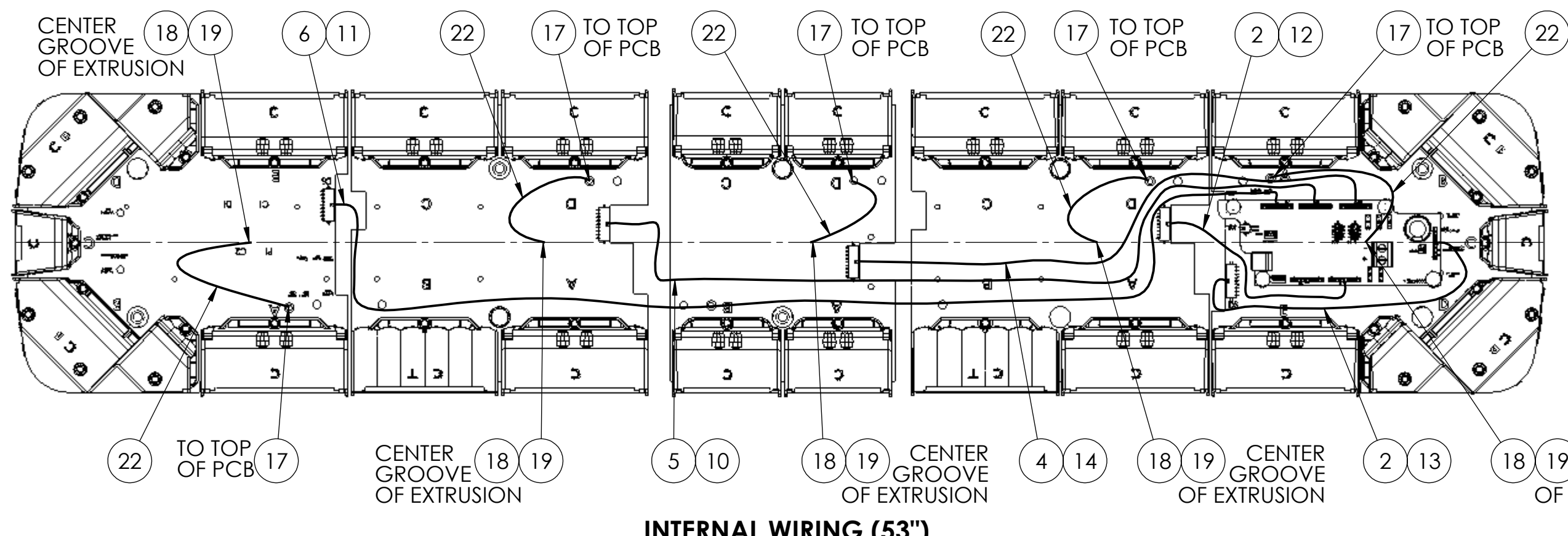

INTERNAL WIRING (53'')

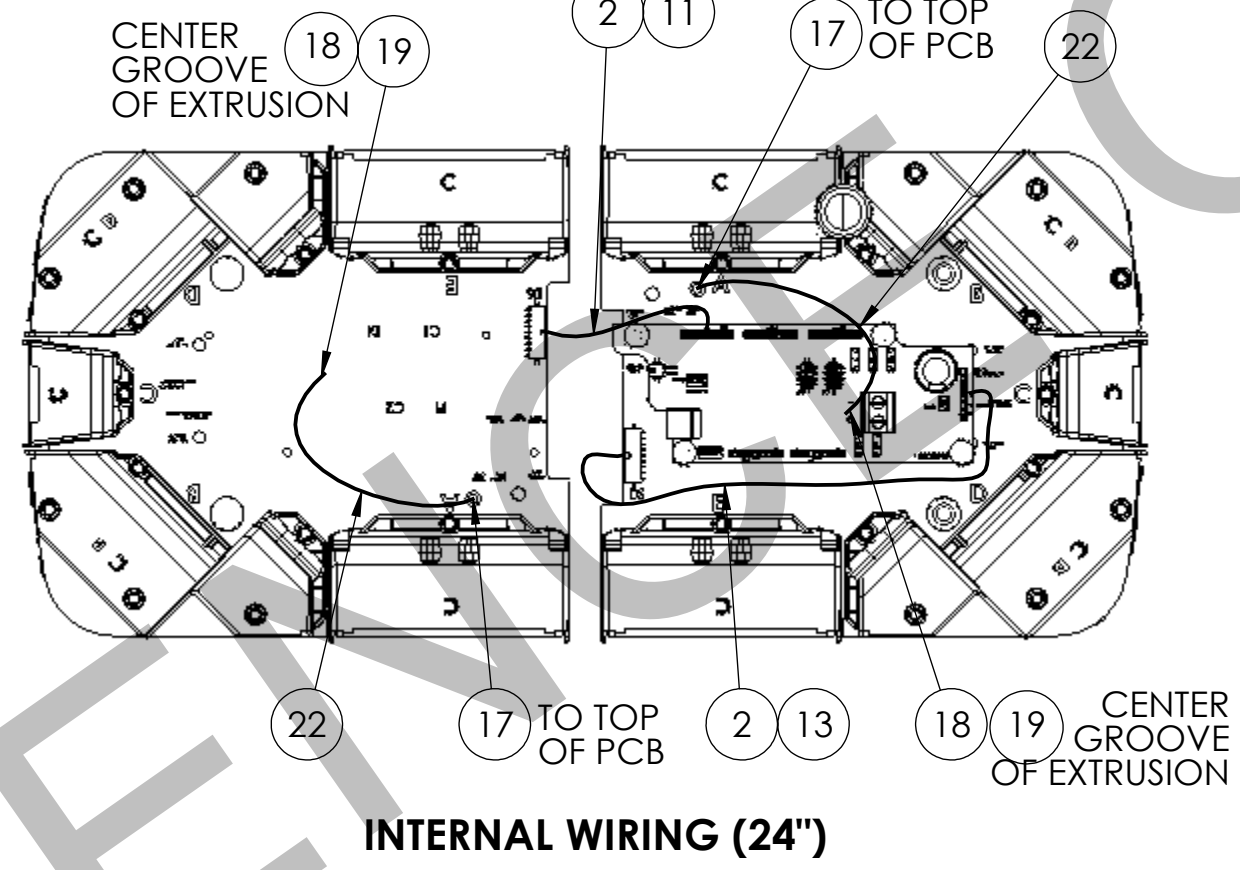

INTERNAL WIRING (24'')

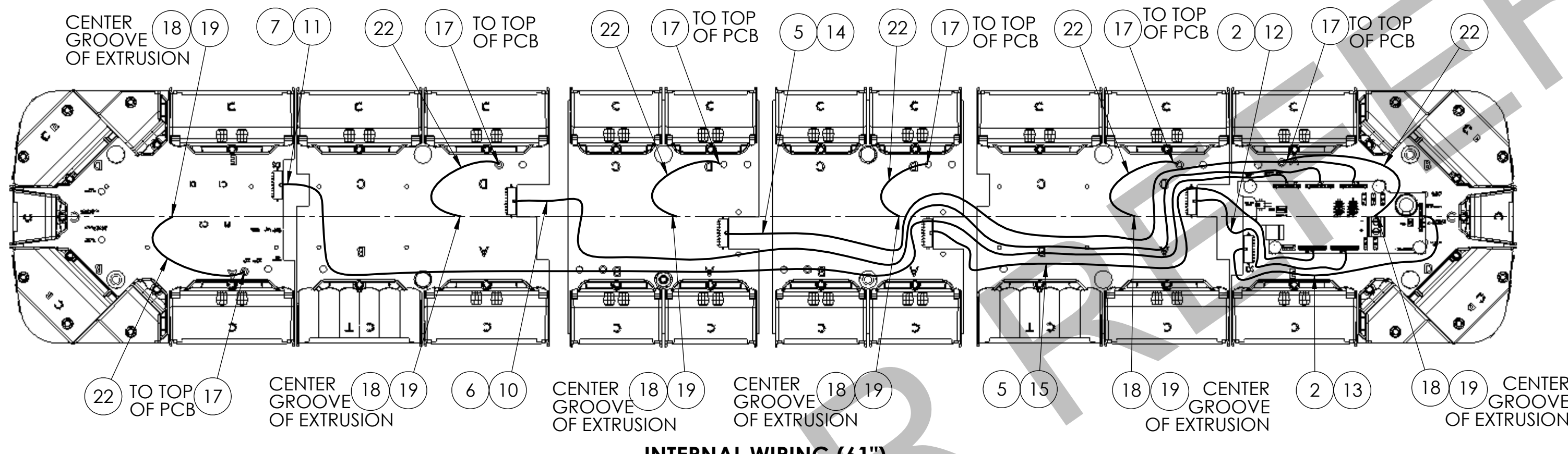

INTERNAL WIRING (61'')

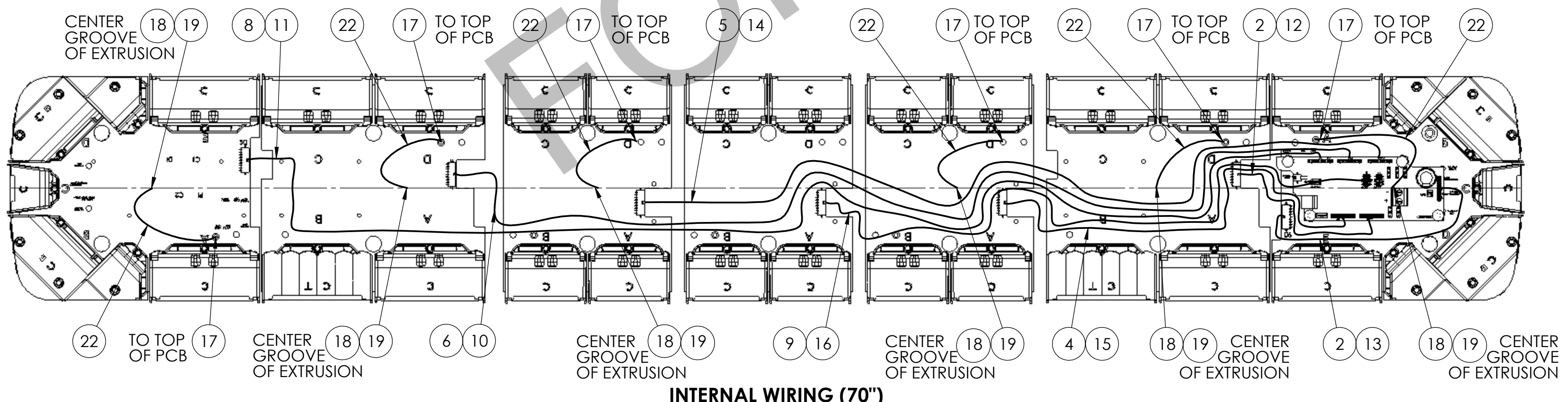

INTERNAL WIRING (70'')

NOT CURRENTLY AVAILABLE

REV.	ITEM	PART NO.	QTY.	DESCRIPTION
	1	1751357-02	1	INCOMING CABLE, LEGEND, 25'
	2	1751355-12	AR	CABLE ASSY., 12"
A1	3	---	---	---
	4	1751355-22	AR	CABLE ASSY., 22"
A1	5	1751355-32	AR	CABLE ASSY., 32"
	6	1751355-38	AR	CABLE ASSY., 38"
	7	1751355-48	AR	CABLE ASSY., 48"
	8	1751355-56	AR	CABLE ASSY., 56"
	9	1751594	AR	CABLE ASSY., CNTR SECTION, 70"
	10	1612318-DI	1	LABEL, WIRE, DI
	11	1612318-DS	1	LABEL, WIRE, DS
	12	1612318-PI	1	LABEL, WIRE, PI
	13	1612318-PS	1	LABEL, WIRE, PS
	14	1612318-C1	AR	LABEL, WIRE, C1
	15	1612318-C2	AR	LABEL, WIRE, C2
	16	1612318-C3	AR	LABEL, WIRE, C3
	17	7011A103-06	AR	SCR, THD, FRM, HEX HE, STL, 8-32
	18	7011A122-06	AR	SCR, #10 TYP, B, HEX W, HD, THD
	19	7075A031	AR	LOCKWASHER, EXT, TTH, #10 SCR
	20	C300210-02-023	1	C-WIRE, RED, 252" (1/2NT:1/2NT)
	21	T300210-10-027	1	T-WIRE, BLACK, 252"
	22	T300218-10-255	AR	T-WIRE, BLACK, 10" (5/16NT:5/16NT)
	23	T300218-10-256	1	T-WIRE, BLACK, 10" (5/16NT:5/16NT)
	24	1751513	AR	CABLE, INPUT, STT LGD/LPX

NOTES:
1. ADD LABELS (ITEM #10 - ITEM #16) TO CONTROLLER END OF CABLES. (AS NEEDED)

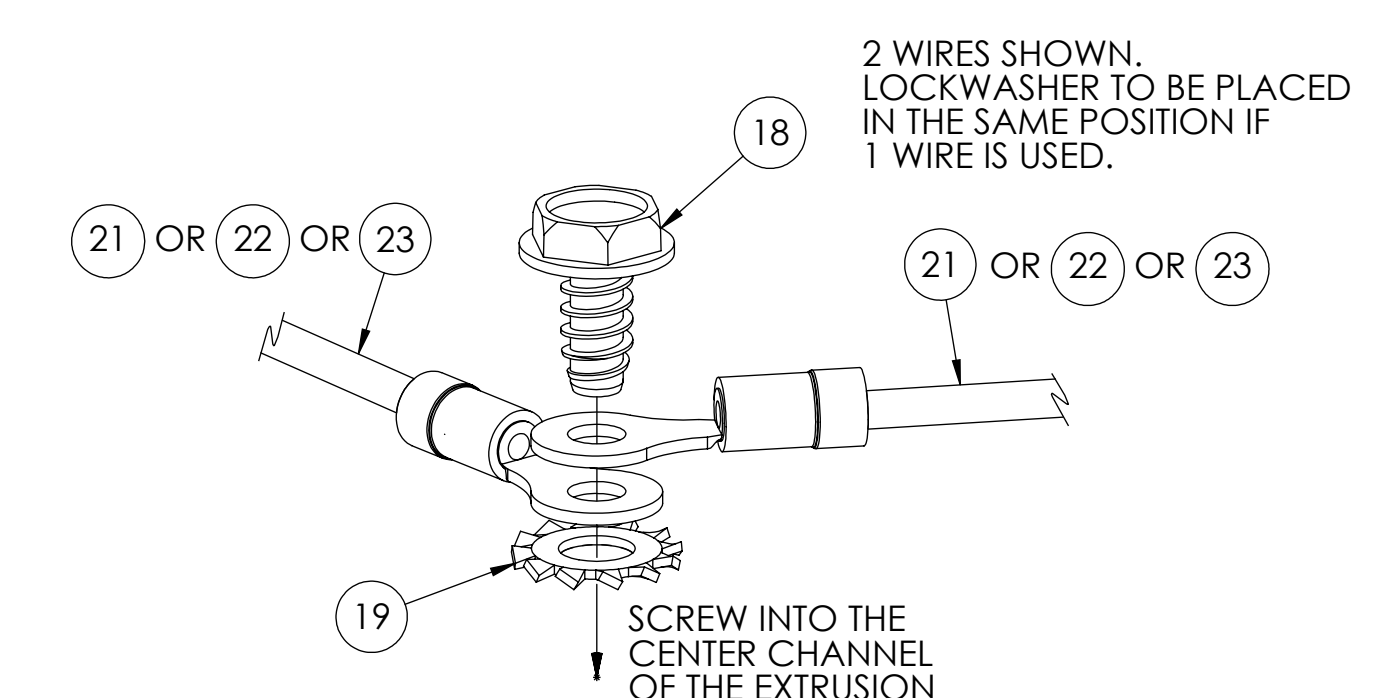

TYPICAL GROUND WIRE CONFIGURATION

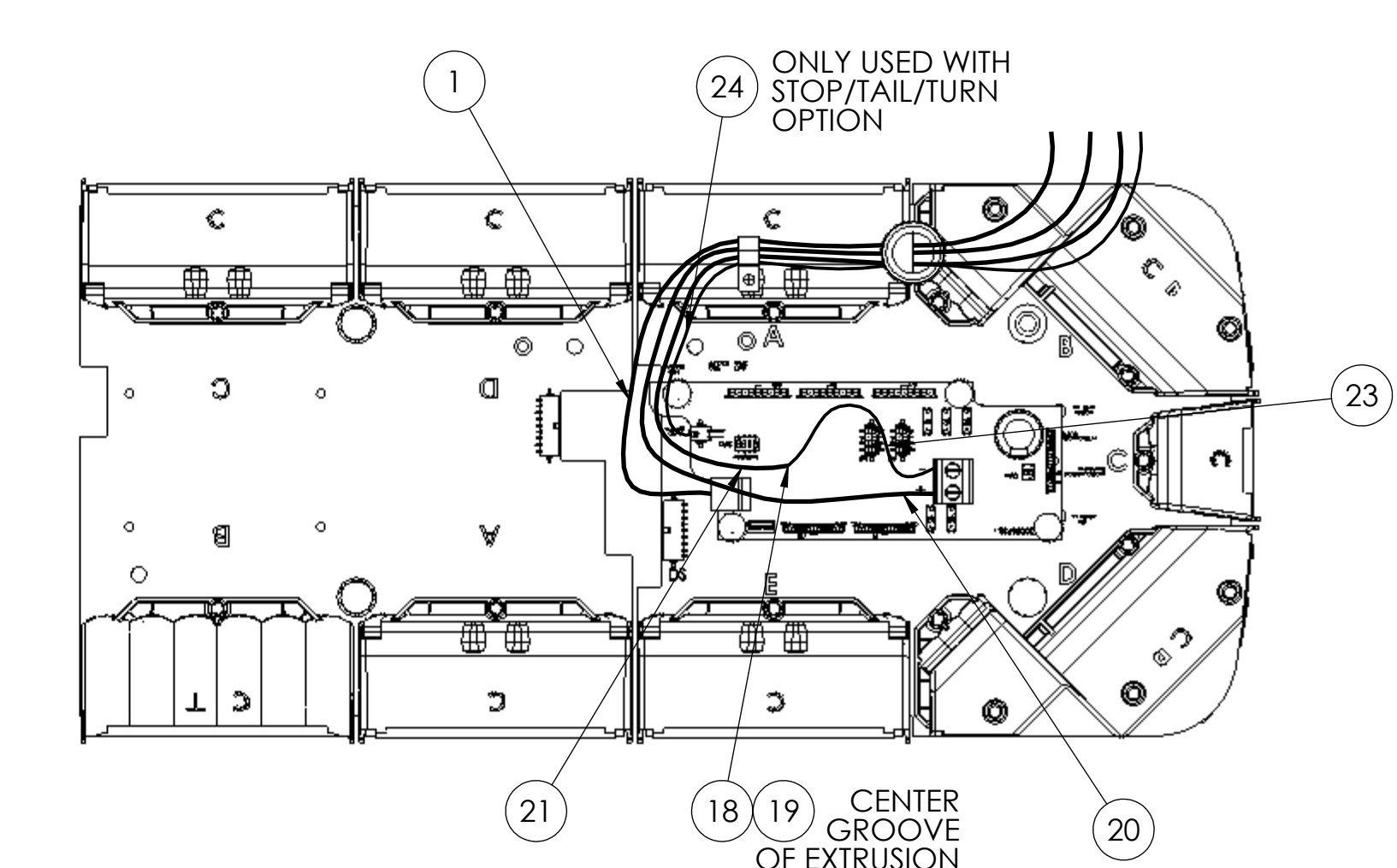

EXTERNAL WIRING (ALL-STD RH CABLE EXIT)

		NAME: _____ TITLE: _____ DATE: _____	
DRAWN BY: RM DATE: 1/31/12		CHECKED BY: EJS DATE: 1/31/12	
SEE SHEET 1		DRAWING NUMBER: 8653251A	
FINISH: N/A		SCALE: AT D SIZE: NONE	
MATERIAL: N/A		THIRD ANGLE PROJECTION: RF	

**WIRELESS CONTROLLER
OPTION WIRING (45" SHOWN)**

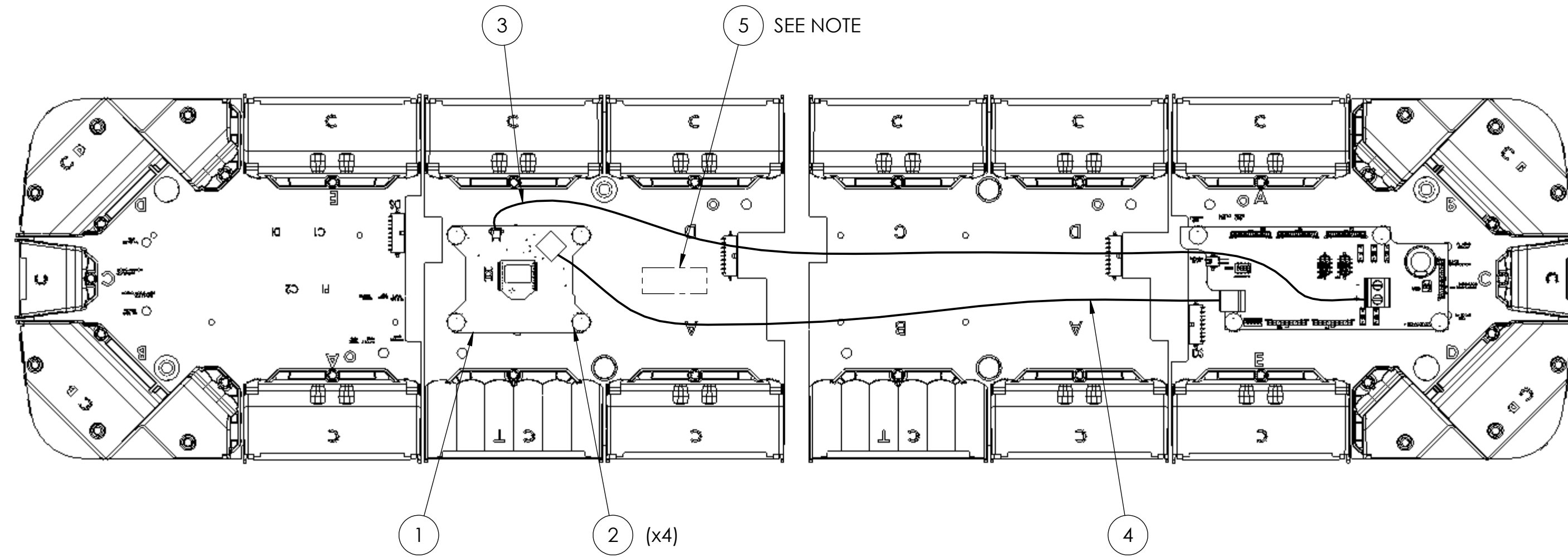

ITEM NO.	PART NO.	QTY.	DESCRIPTION
1	8623135	1	WIRELESS RECEIVER ASSY
2	230315	4	STAND OFF
3	1461848	1	HARNESS POWER LEAD
4	1751357-04	1	CABLE ASSY, RS485, 4'
5	81462284	0.25	LABEL, SERIAL #

OPTION NOTES:

1. PLACE SERIAL NUMBER LABEL ON TOPSIDE OF ROC BOARD TO SHOW THROUGH DOME. MUST BE ON BOARD WITH RECIEVER BOARD ATTACHED. (DRIVERS-SIDE INTERMEADIATE BOARD)
2. OPTION WIRING THE SAME ON ALL LENGTHS (NOT AVAILABLE ON 24" OR 32" LIGHTBARS.

**CENTER BASE OPTICOM
OPTION INSTALLATION:**

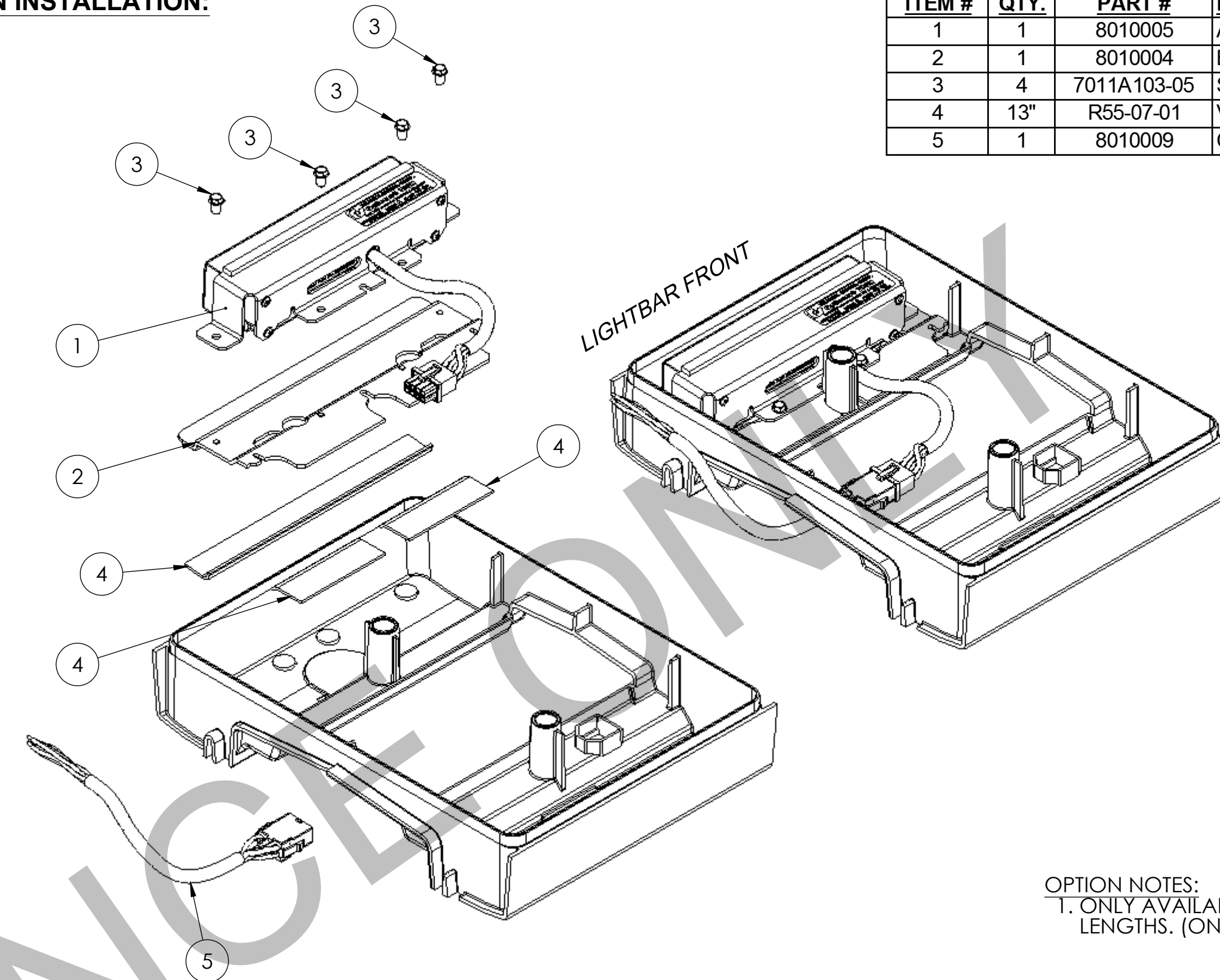

ITEM #	QTY.	PART #	DESCRIPTION
1	1	8010005	ASSY., OPTICOM, 795H LOW PROFILE EMITTER
2	1	8010004	BRACKET, OPTICOM 795H LEGEND MOUNT
3	4	7011A103-05	SCREW, THD FRM, HEX HD, STL #8-32
4	13"	R55-07-01	VHB ADHESIVE TAPE
5	1	8010009	CABLE ASSEMBLY, 25' GTT OPTICOM 795H

- OPTION NOTES:**
1. ONLY AVAILABLE IN 53", 61", AND 70" LIGHTBAR LENGTHS. (ONE PER LIGHTBAR)

FOR REFERENCE

FEDERAL SIGNAL <small>2845 FEDERAL SIGNAL DRIVE MILWAUKEE, WI 53212</small>	SECURITY & CONTROL <small>SECURITY & CONTROL</small>	<small>UNLESS OTHERWISE SPECIFIED: DIMENSIONS ARE IN INCHES ANGLES ARE IN DEGREES FINISHES ARE IN PARENTHESIS UNLESS OTHERWISE SPECIFIED</small>	NAME
			FINAL ASSY., LGDZ
REMOVE BURRS, SHARP CORNERS AND EDGES			SCALE: AT D SIZE: NONE
MATERIAL: N/A			THIRD ANGLE PROJECTION RF
** SEE SHEET 1 **		DRAWN BY: RM DATE: 1/31/12	CHECKED BY: EJS DATE: 1/31/12
REV. CHANGE		DATE BY	DRAWING NUMBER: 8653251A